

DATA SHEET CLIMBING NET RETIS 2

Item No: 515515401



The „retis2“ climbing installation also maximizes climbing fun in minimal space! On the bottom there's „just“ a climbing net. It can be played on from all sides and offers maximum fun. And the first one to reach the ring in the middle is the winner!



TECHNIAL INFORMATION

Dimensions:

Main dimension: 2250 x 400 mm

Height: 2880 mm

Weight: 110 kg

capacity: acc. to EN 1176

Max. fall height: 2600 mm

Safer surfacing area: 31,96 m²

Required safety slabs: 35,00 m²

Recommended surface material: sand, wood chip, gravel, synth. impact protection

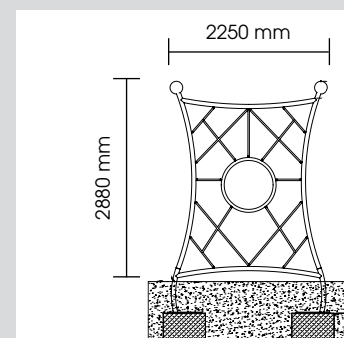
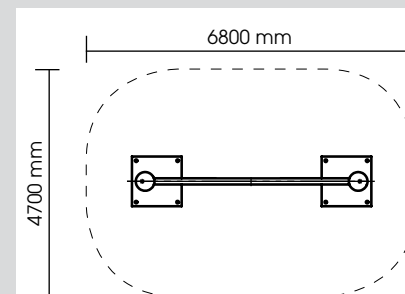
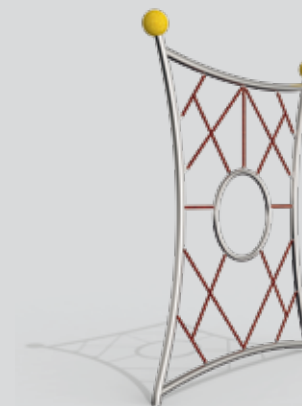

MATERIALS | SCOPE OF SUPPLY

Climbing net, pre-mounted completely

Rack:	stainless steel, V2A
spyhole:	stainless steel, V2A, 1 piece
tube end caps:	balls made of EPDM, 2 pieces
climbing net:	Herkule rope/plastic

INSTALLATION

Foundations: 2
Installation at concrete surfaces possible (special edition)
Installation according to our detailed mounting instructions, see www.stilum.de