

<b>NORLEG</b>	
<b>Købmandsbod</b>	
LE 20096	
16.11.2005	REV. B:13.12.2017

< 600

≥ EN 1176

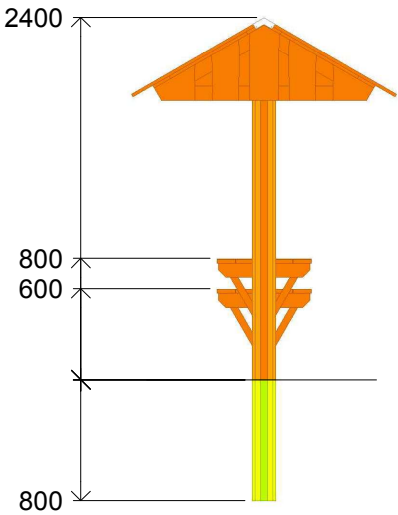

1740

<b>NORLEG</b>	
<b>Købmandsbod</b>	
LE 20096	
16.11.2005	REV. B:13.12.2017

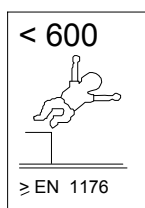

By assembly. Drilling and use of saw must be expected.

Dh = Disk head

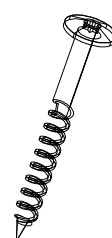

Mont.p. nr.

19

Part

D11216  
D11217  
D11218  
D11219  
D11220

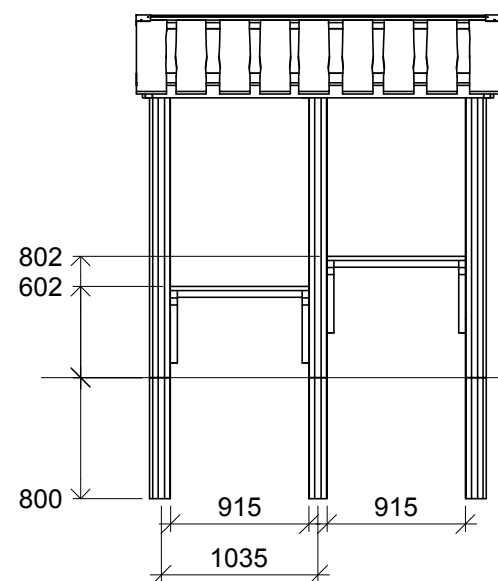
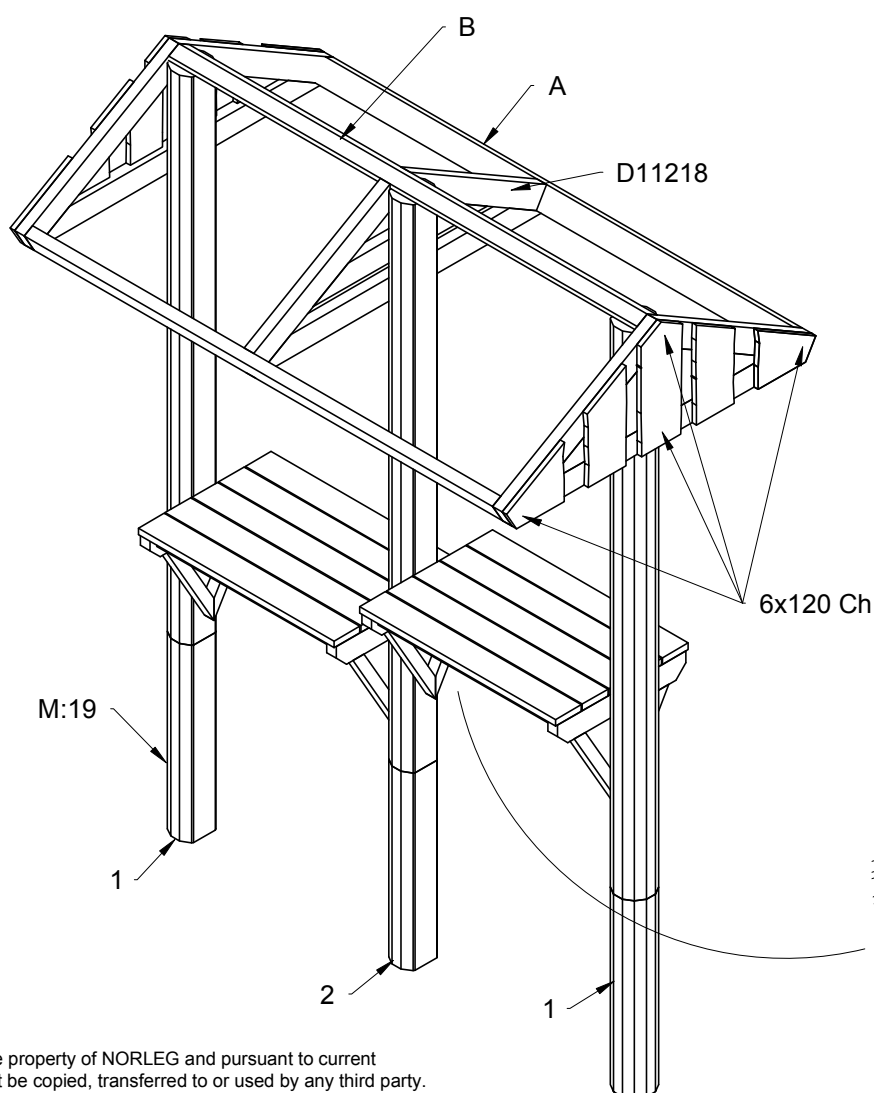

1:50

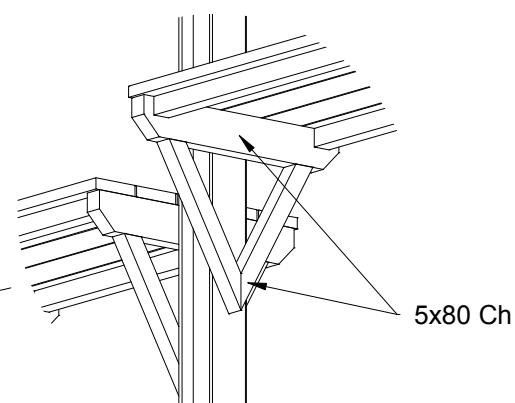

This drawing is the property of NORLEG and pursuant to current legislation may not be copied, transferred to or used by any third party. Should this drawing be used, a fee of 10% of the assumed contract price will be charged.