



Click or scan



### Product description

The Longhouse emulates the style of traditional farms from the Viking Age in Northern Europe. It offers a cozy shelter in any outdoor area and quickly becomes a popular gathering point. Ideal for storytelling, enjoying packed lunches, or as a refuge from the rain. The house is also available with side panels for added shelter and weather protection (LE20119U).

To make the house even more useful, benches can also be added, making it the ideal spot for teaching, creative projects, or social gatherings outdoors.



#### Age

Number of users	25
-----------------	----

Color	Uncolored
-------	-----------

Primary materials	Robinia, Douglas
-------------------	------------------

Anchoring	Robinia in ground
-----------	-------------------

#### Fall height

Dimensions (LxWxH)	8 x 4,2 x 4,3 m
--------------------	-----------------

#### Impact area

Minimum area	x x m
--------------	-------

#### Variation

#### Color

#### Installation

#### Warranty ([Terms and conditions](#))

Robinia	15 years
---------	----------

Douglas	10 years
---------	----------

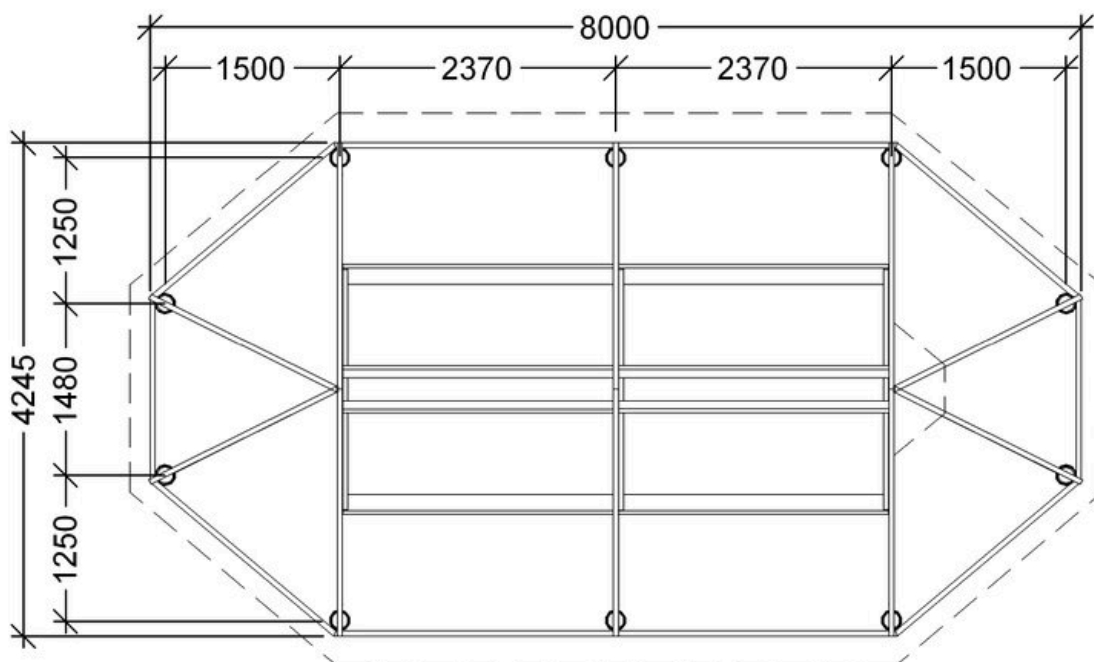
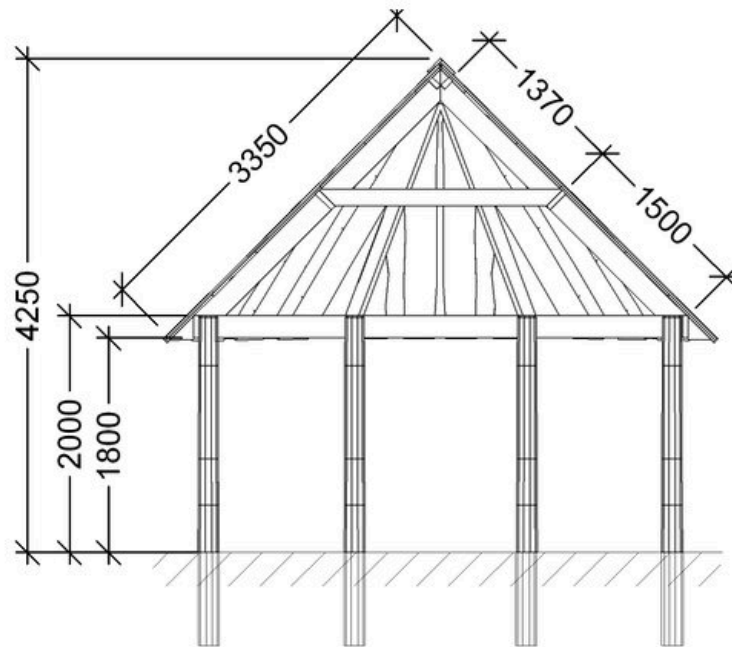

Assembly time

Anchoring  
**Robinia in ground**

Largest part



Number of installers



Concrete



Heaviest part