

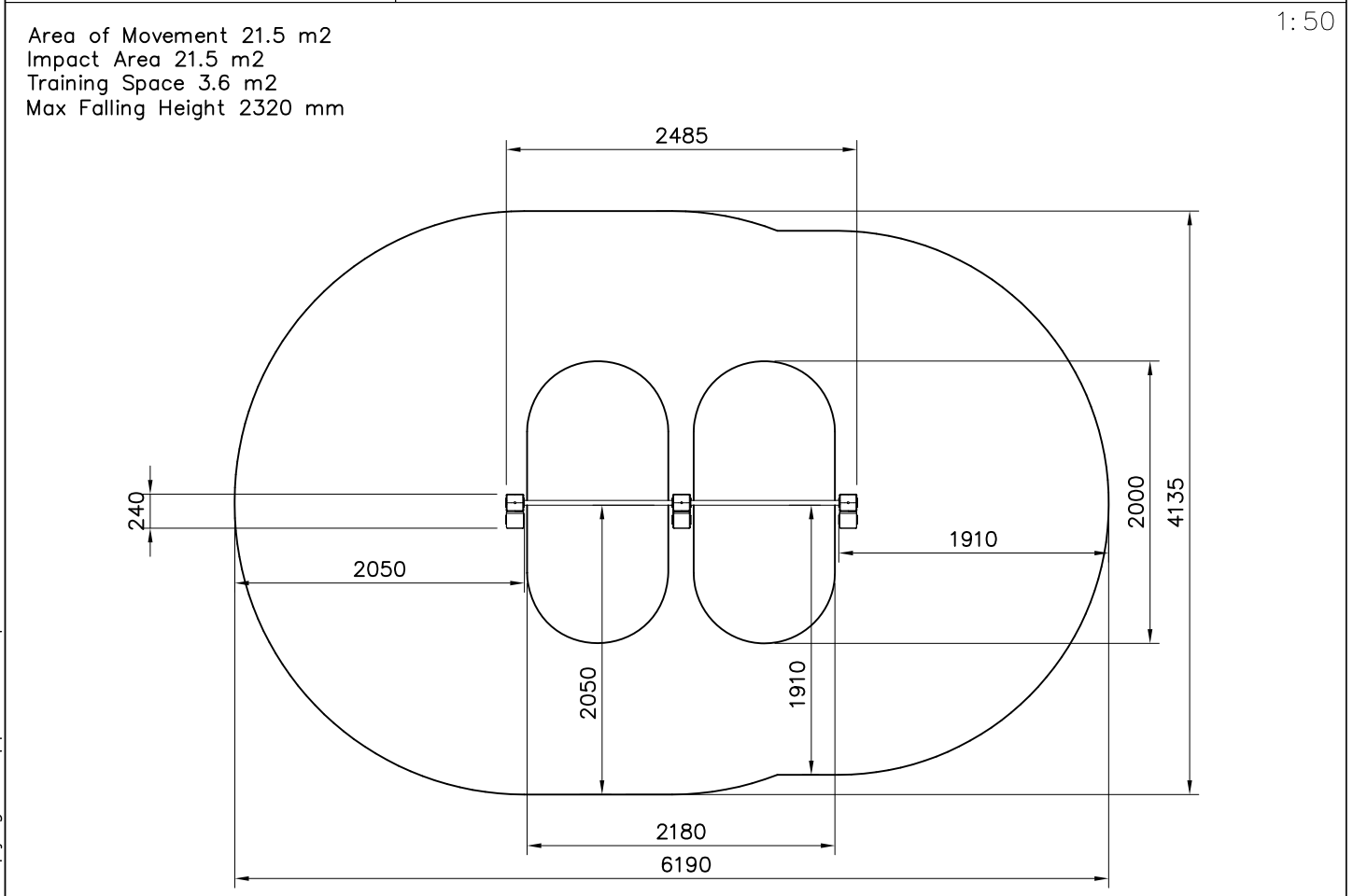

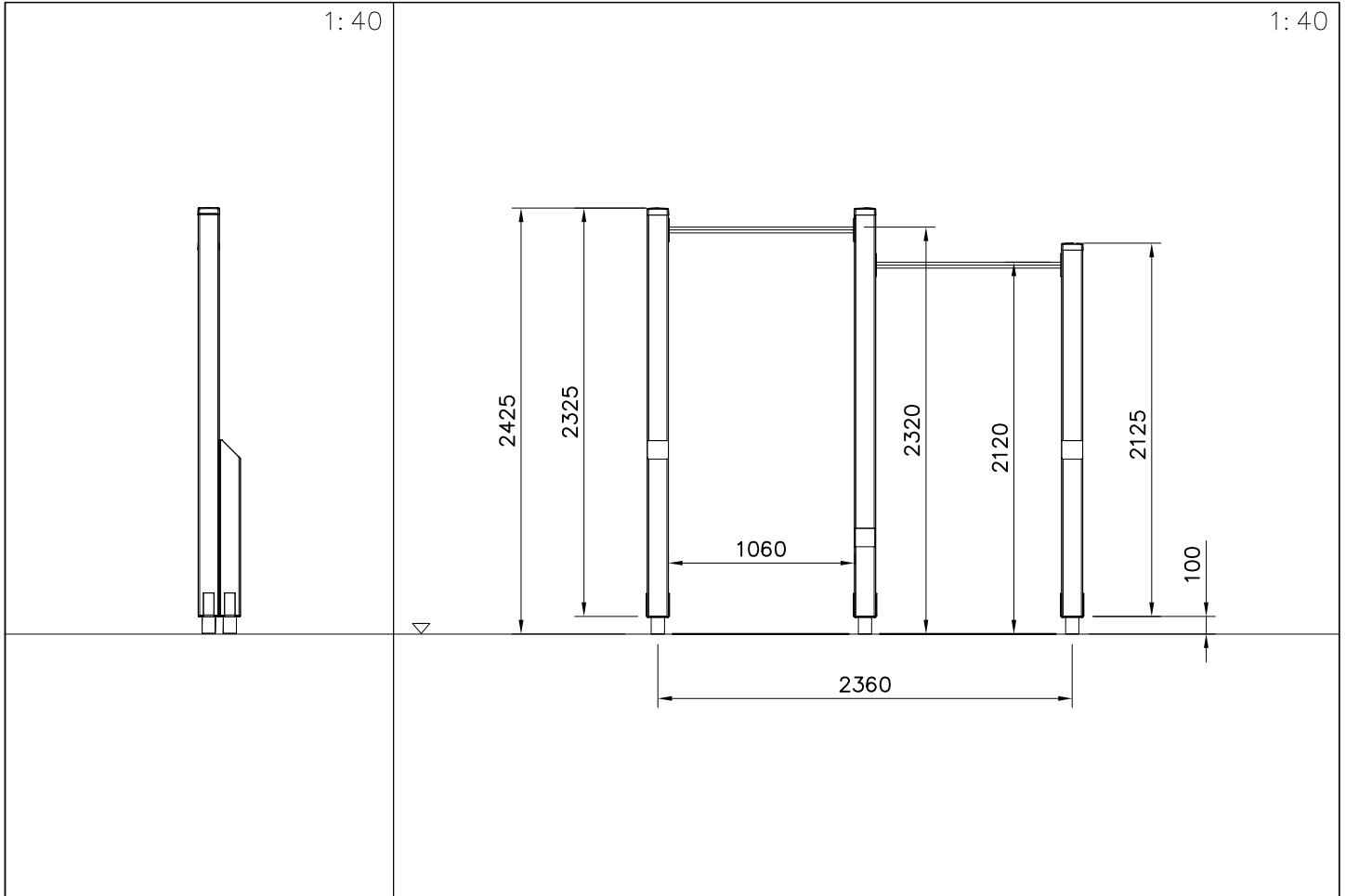

①	706033	PCS	②	705335	PCS
		1			2
				120x120x1000	
③	705406	PCS	④	980114	PCS
		1			4
	126x181x18			Ø4x20	
⑤	705405	PCS	⑥	905103	PCS
		1			7
	120x120x500			PT-28/32-H	
⑦	905104	PCS	⑧	905761	PCS
		24			6
	M10			120x120x700	
⑨	905830	PCS	⑩	905838	PCS
		3			2
	123x123x40			L=1060	
⑪	906583	PCS	⑫	909246	PCS
		2			7
	126x181x14x3			M12x140	
				Ø5x60	
⑬	980100	PCS	⑭	980104	PCS
		3			3
	Ø5x60			Ø5x90	
⑮	980123	PCS	⑯	705231	PCS
		40			1
	Ø7x60			120x120x2290	
⑰	705388	PCS	⑳	909256	PCS
		1			40
	120x120x2090			Ø16/8.4	

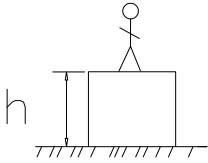

		
<p>$h < 600$</p> <p>Without movement and therefore without Impact Area</p>	<p>Totally hard surfaces.</p> <p>Note. Lappset does <u>not recommend</u> totally hard surfaces at all.</p>	<p>E.g. concrete or asphalt</p> 
<p>$h < 600$</p> <p>With movement e.g. rocking</p>	<p>Materials with very limited impact attenuating properties.</p>	<p>E.g. wood</p> 
<p>$h < 1000$</p>	<p>Materials with significant impact attenuating properties.</p>	<p>fine gravel 0–8 mm</p>  <p>grass</p>  <p>unsorted sand</p> 
<p>$h < 3000$</p>	<p>Loose fill material</p> <p>E.g. sand/gravel 0,25...8 mm D60/D10<3,0 Woodchips 5...30 mm bark 20...80 mm</p>	 <p>\underline{S} \underline{h}</p> <p>30 cm < 2,0 m</p> <p>40 cm < 3,0 m</p>
	<p>Syntethic granulates</p> <p>\underline{S} \underline{h}</p> <p>40 mm ~> 1,2...1,3 m</p> <p>50 mm ~> 1,5...1,7 m</p> <p>60 mm ~> 1,8...2,0 m</p> <p>70 mm ~> 2,1...2,5 m</p> <p>Note. For accurate values, see manufacturer's instructions.</p>	

REMOVE SAFETY SURFACE/SAND/GRAVEL
TO CHECK FOUNDATION

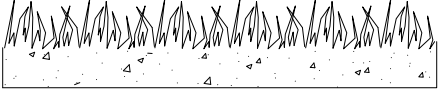
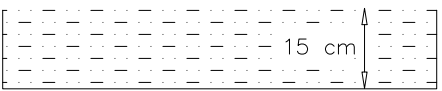
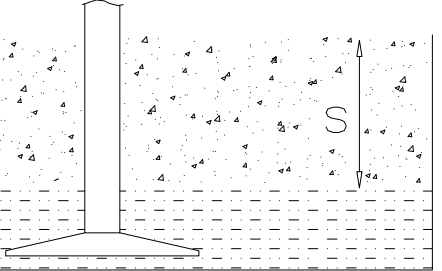
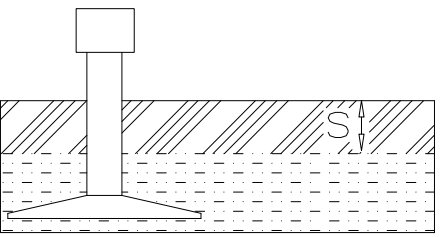

REMOVE SAFETY SURFACE/SAND/GRAVEL
TO CHECK FOUNDATION



DET 1

$\varnothing 16 \downarrow > 130$

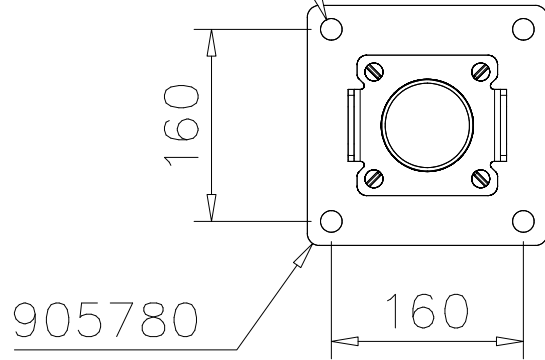

DET 2



DET 3



DET 4



DET 5

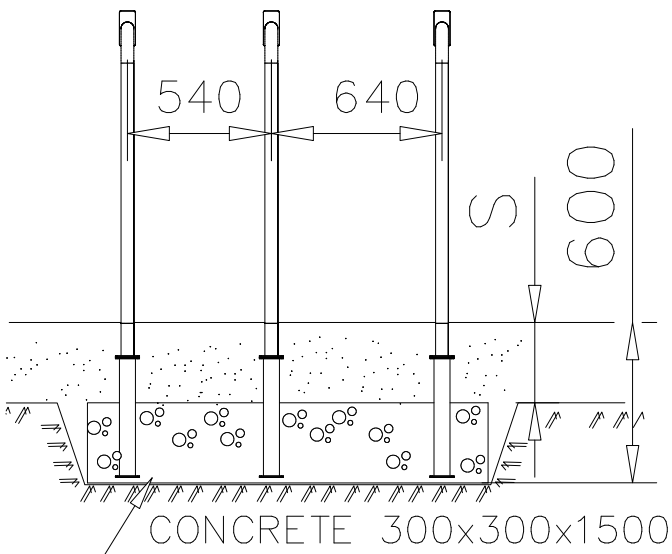

DET 6

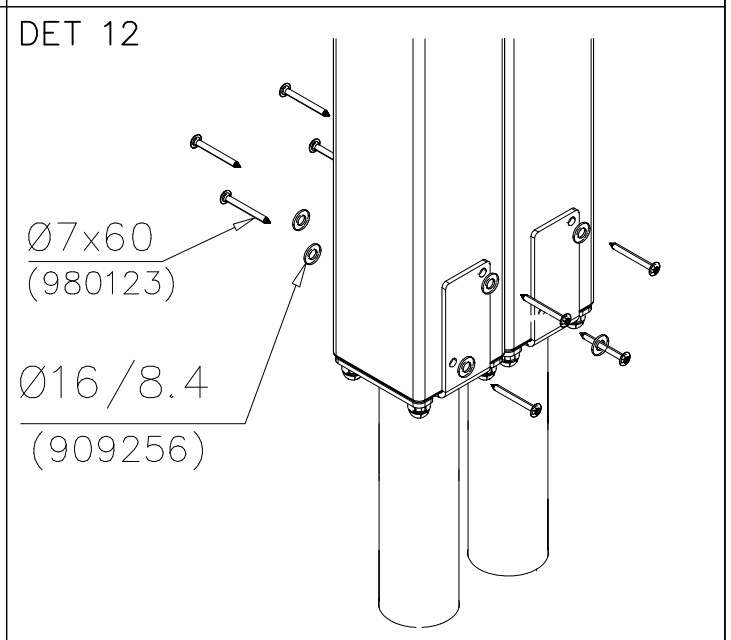
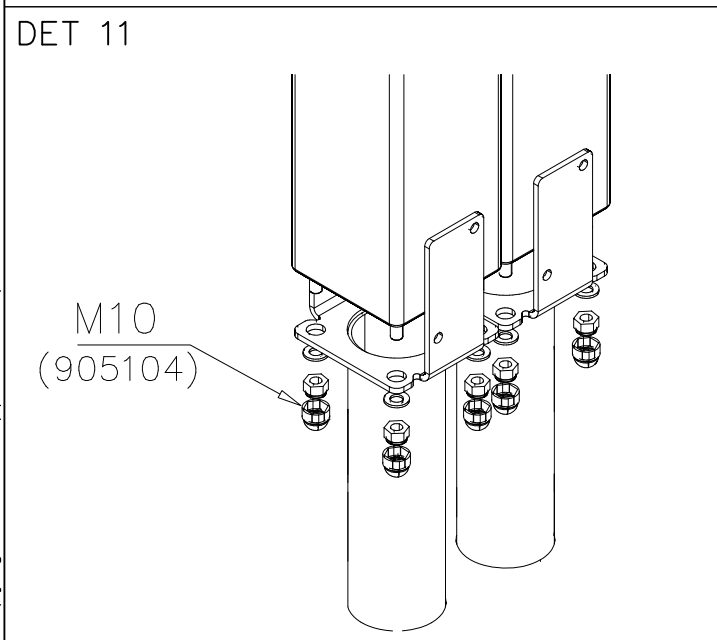
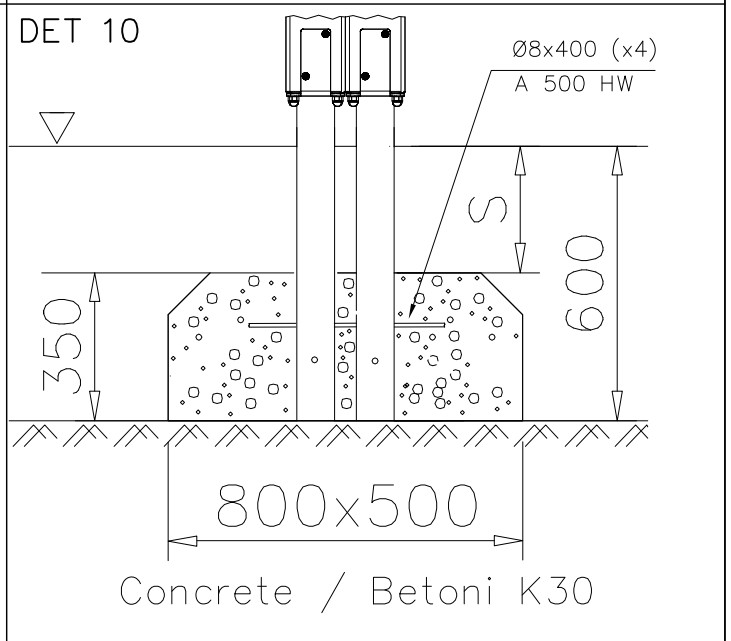
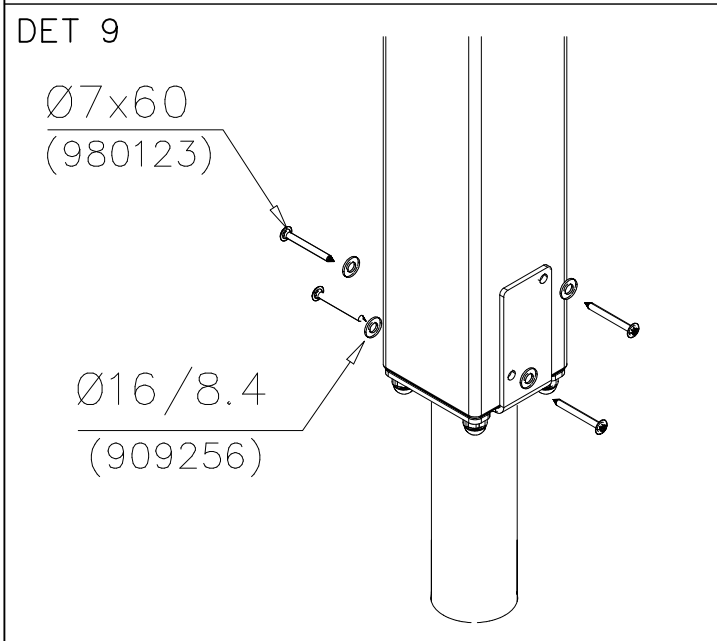
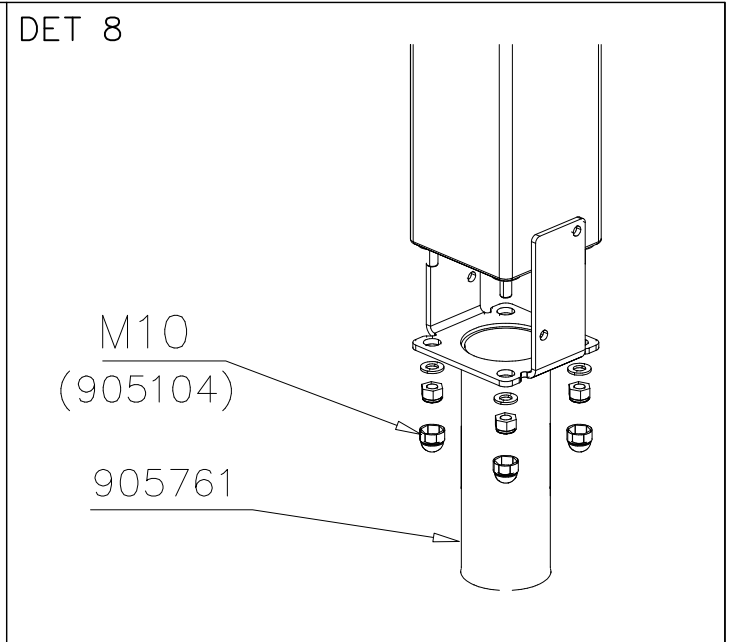
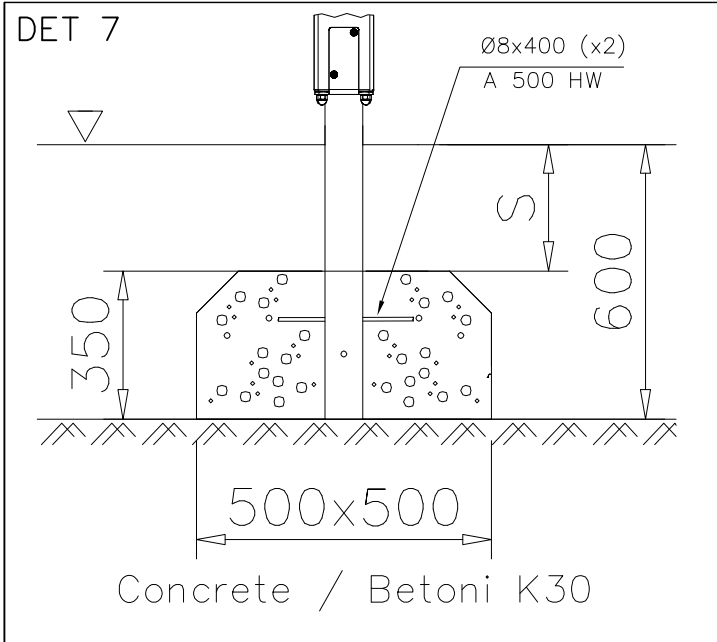

DET 13



DET 14



DET 15



DET 16

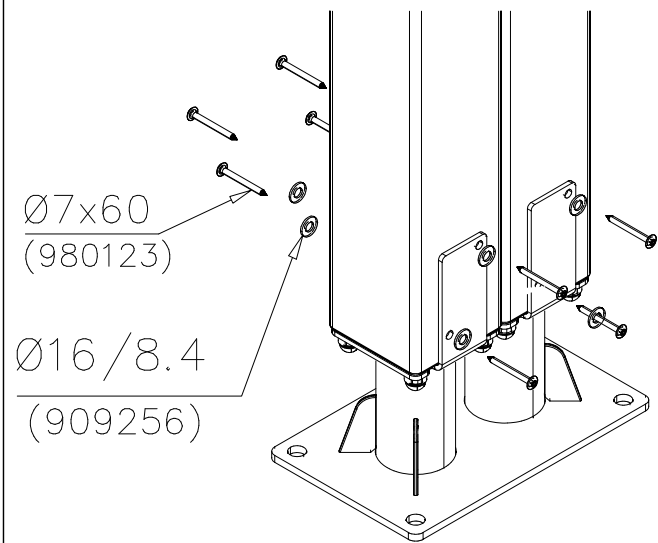

DET 17

DET 18

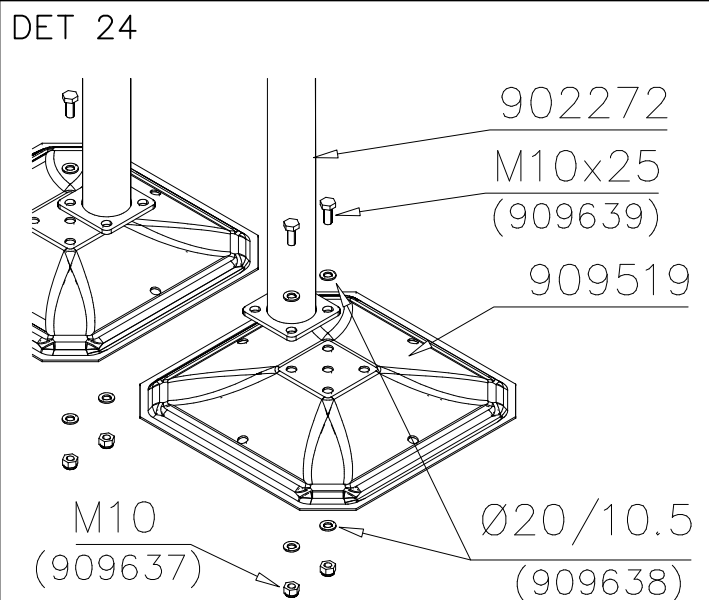
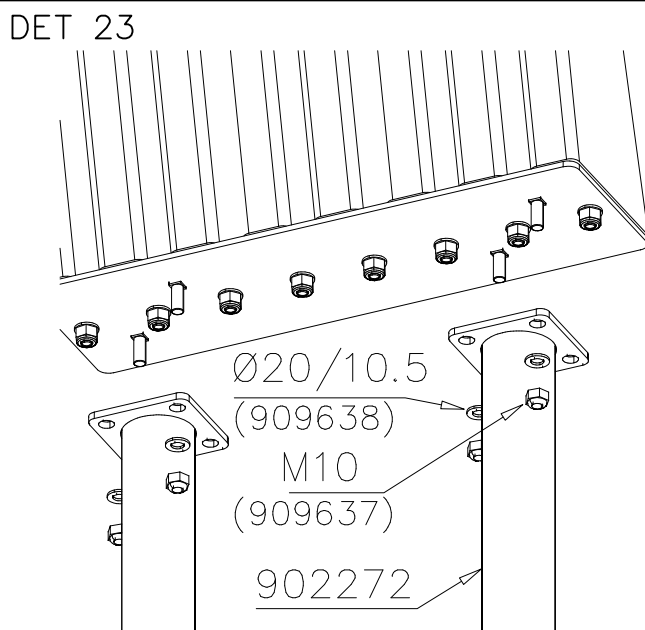
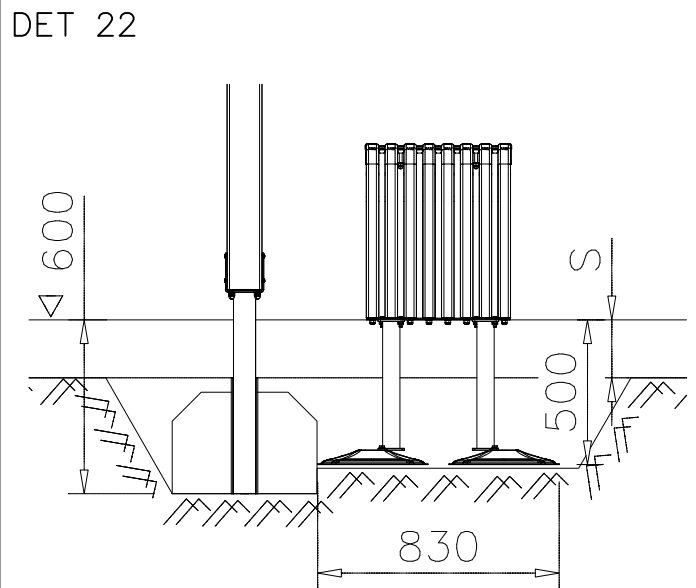
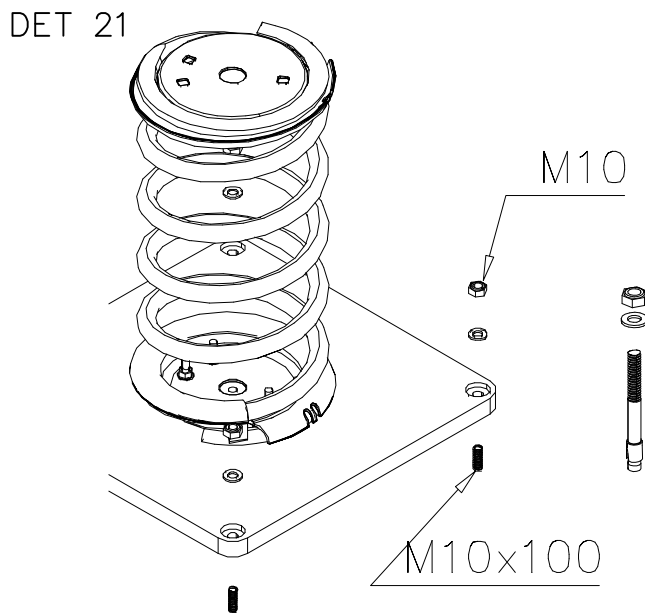
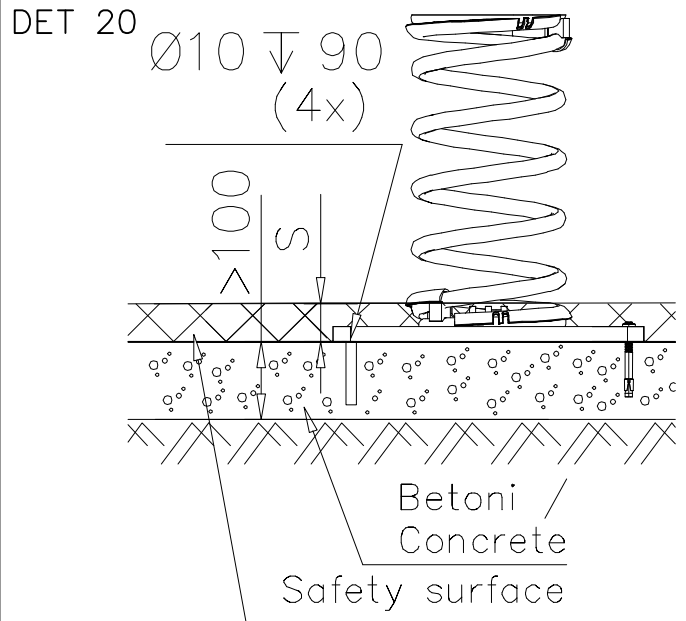
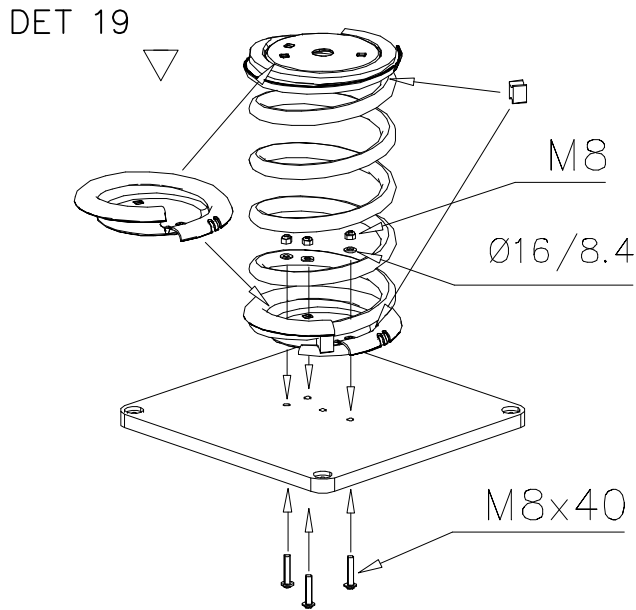



DET 31



DET 32

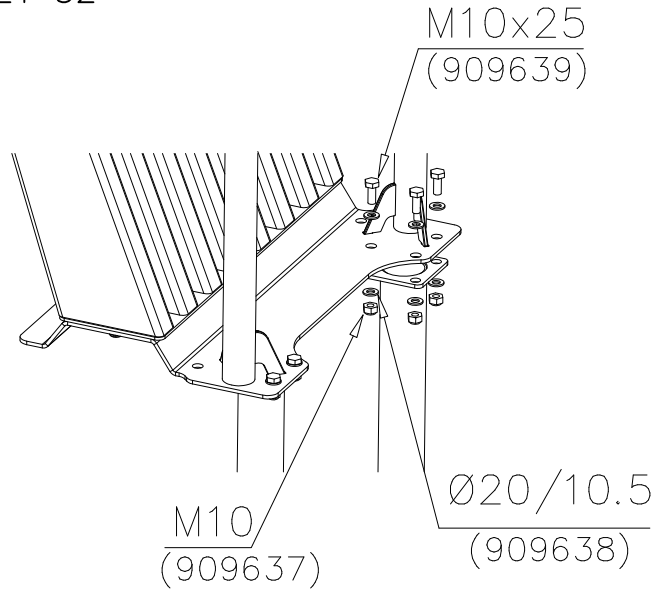

DET 33

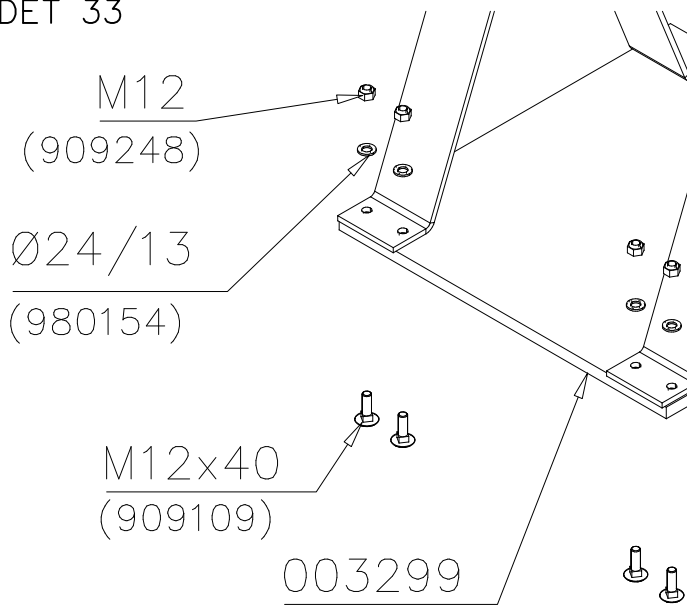

DET 34

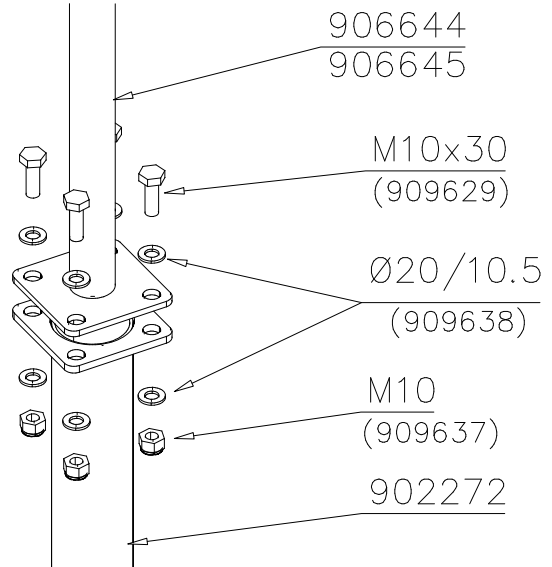

DET 35



DET 36



DET 37



DET 38



DET 39



DET 40



DET 41



DET 42

LAPPSET SPORT

BASE

DATE: 15.8.2017

8(10)

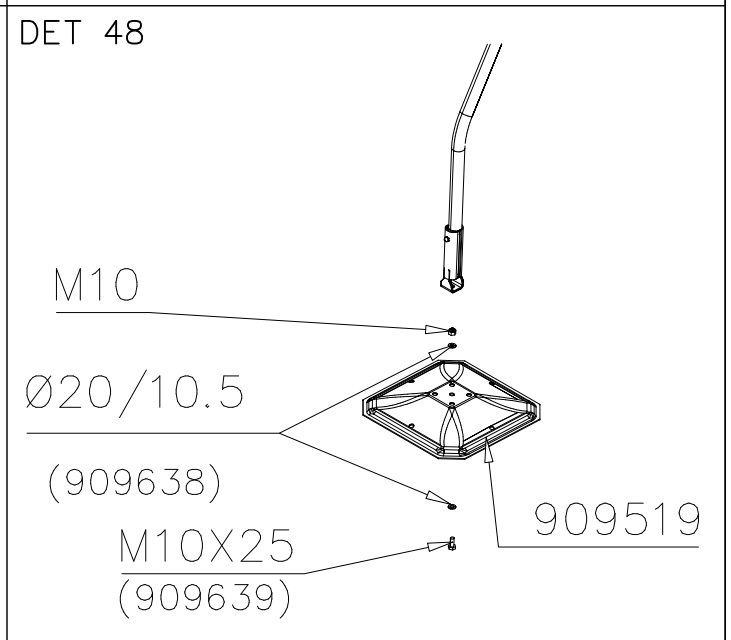
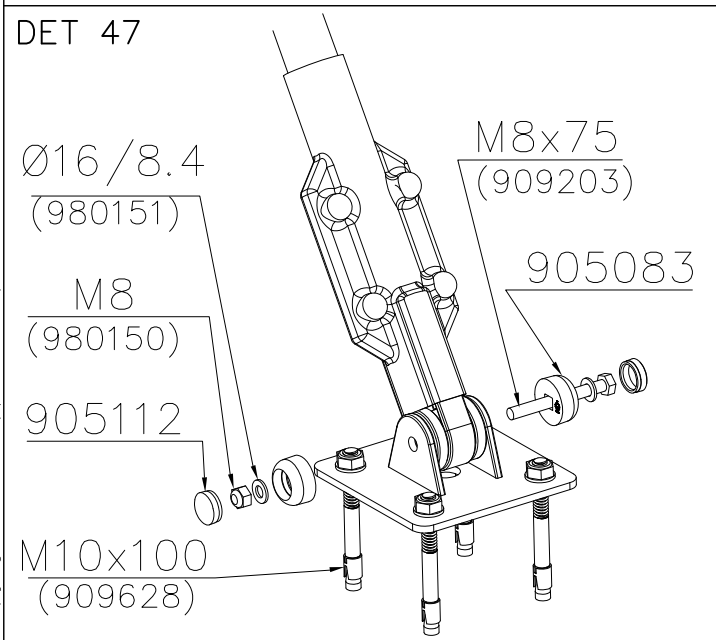
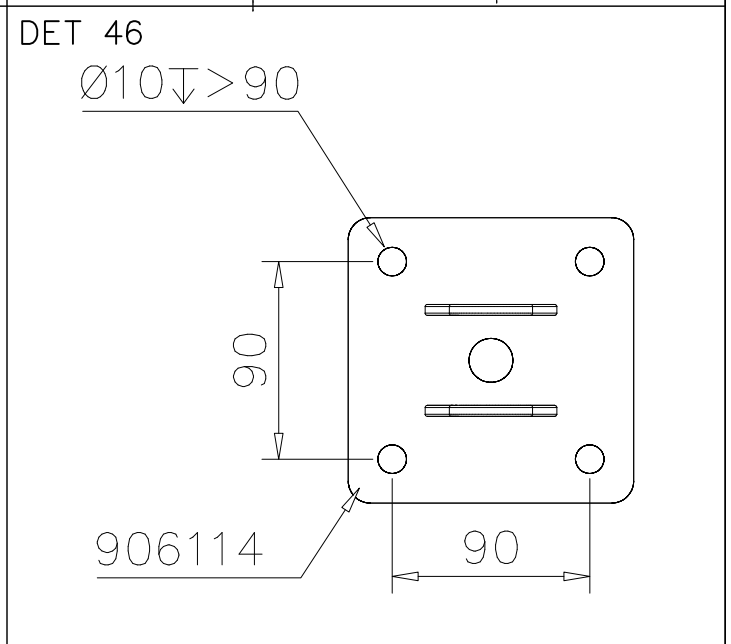
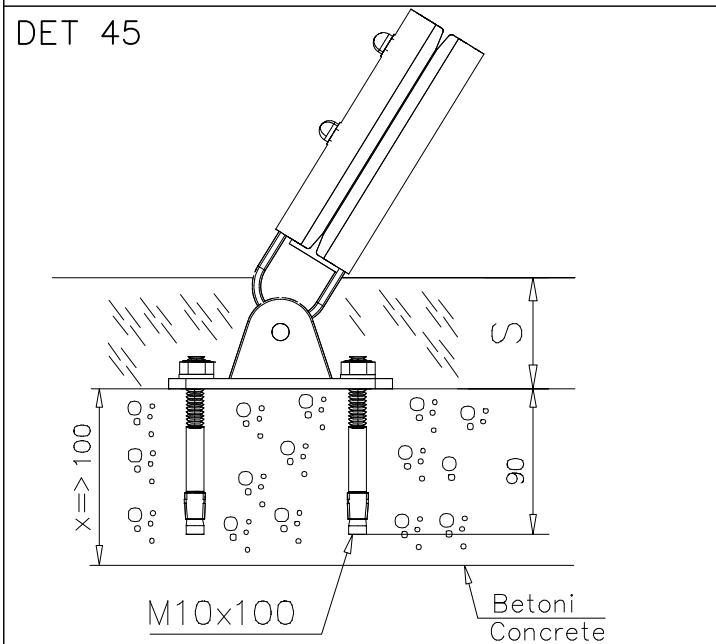
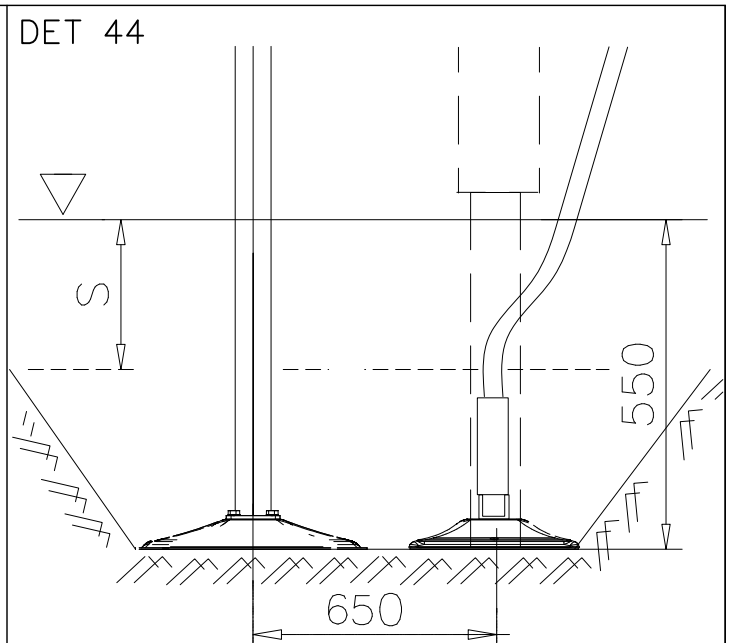
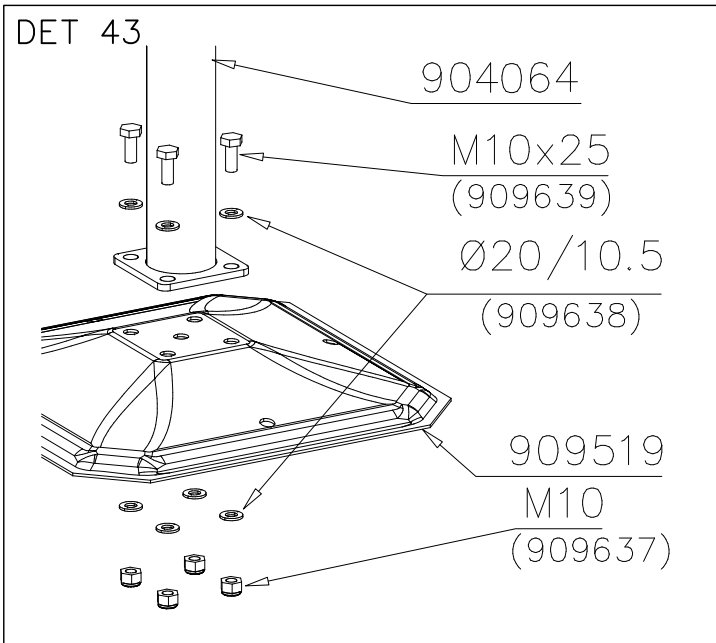

DET 49

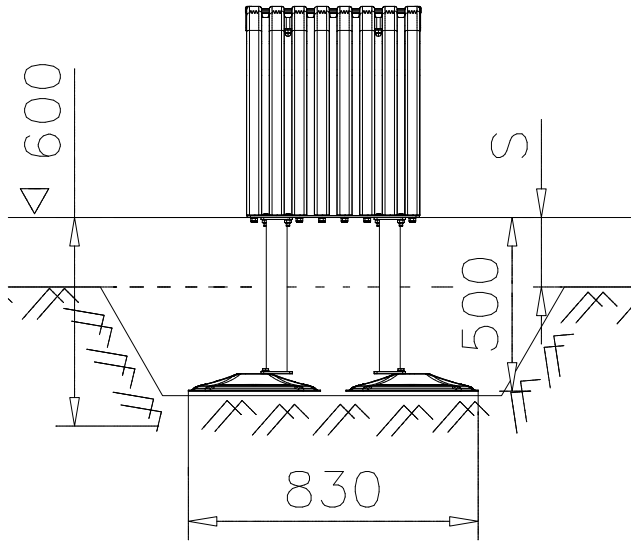

DET 50



DET 51

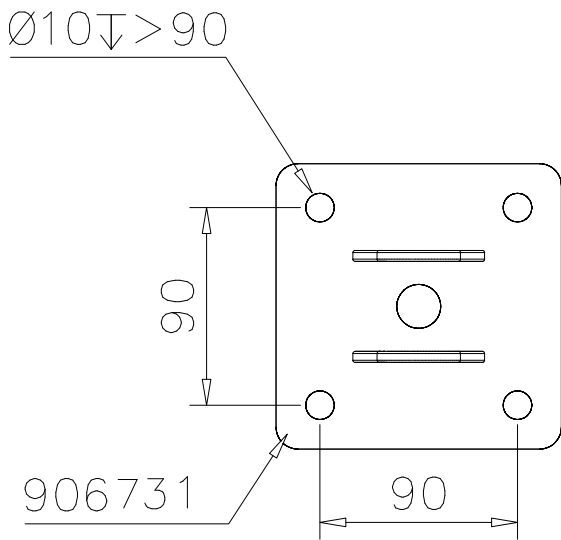

DET 52

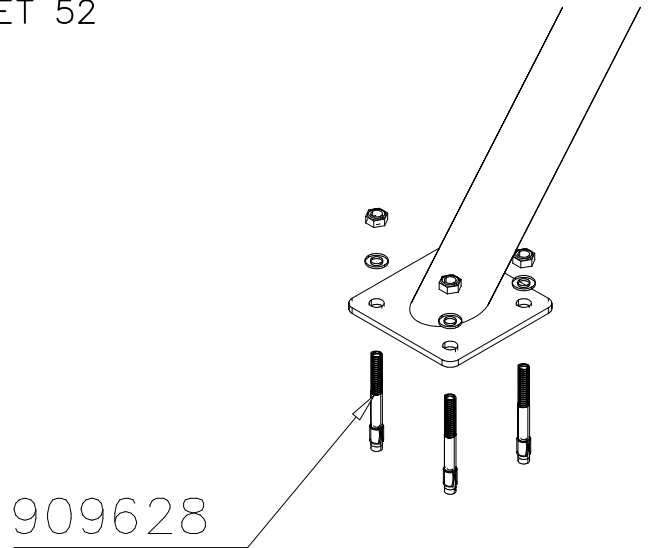

DET 53

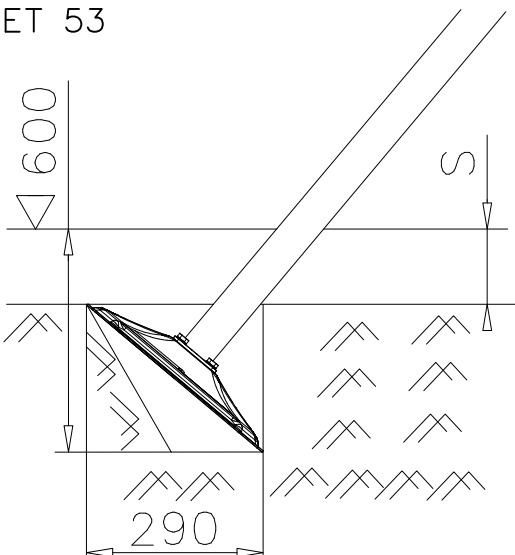

DET 54



DET 55

STEELNET Ø6 #150
(1400x2100)
Concrete
1500X2200X200 K30

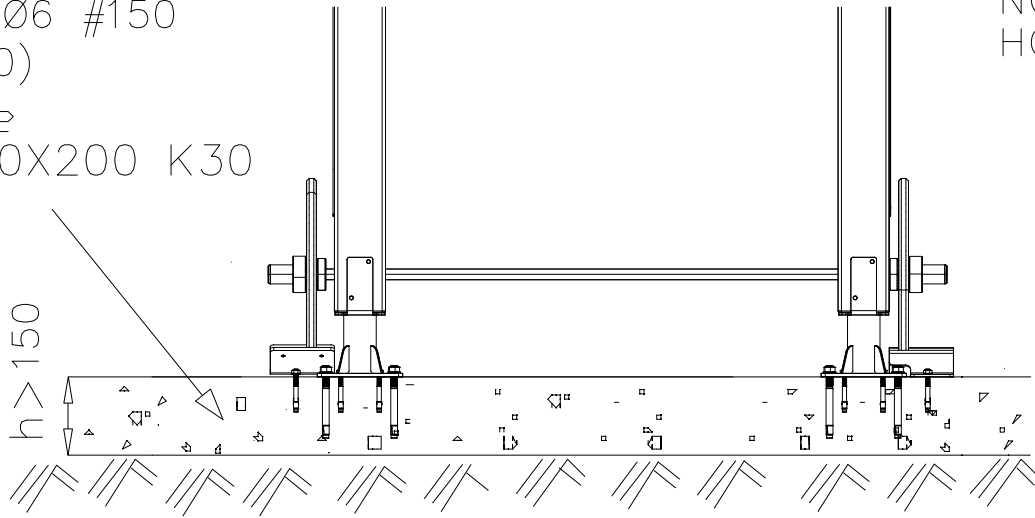

NOTE!
HOX!

DET 56

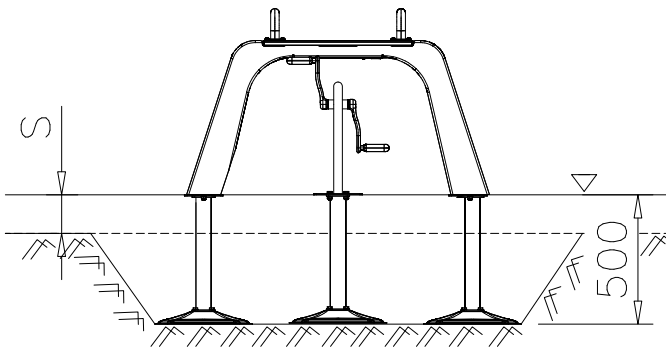

DET 57

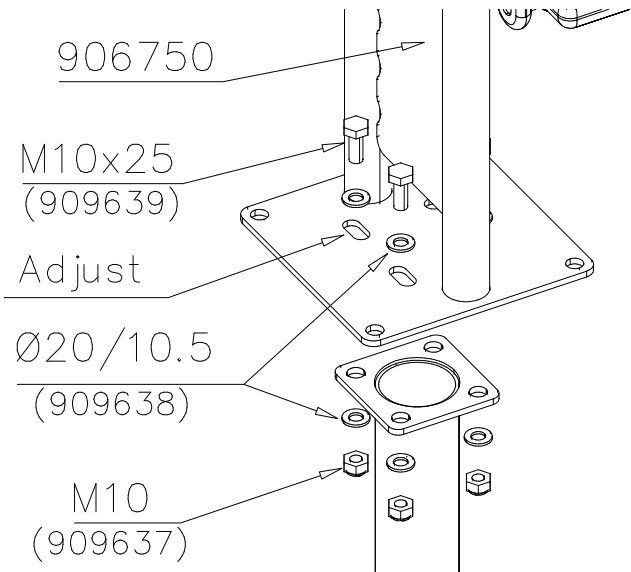

DET 58

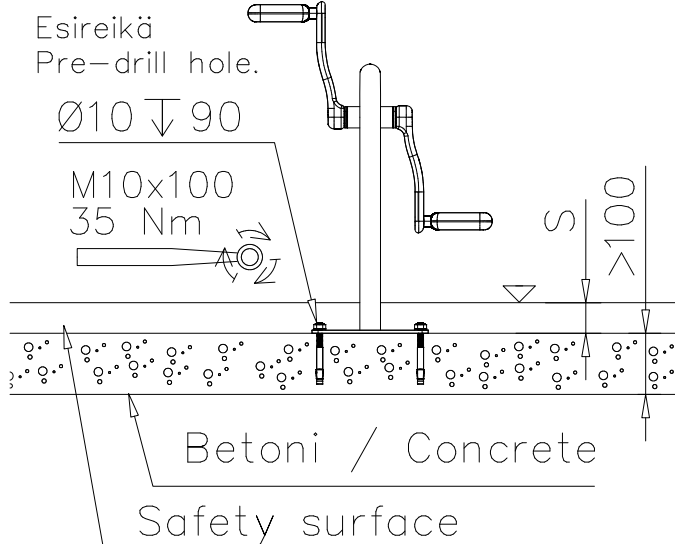

DET 59

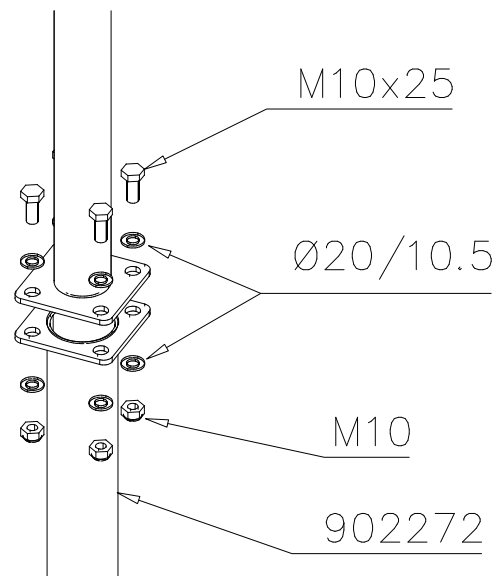

DET 1



DET 2



DET 3



DET 4



DET 5



DET 6





DET 13

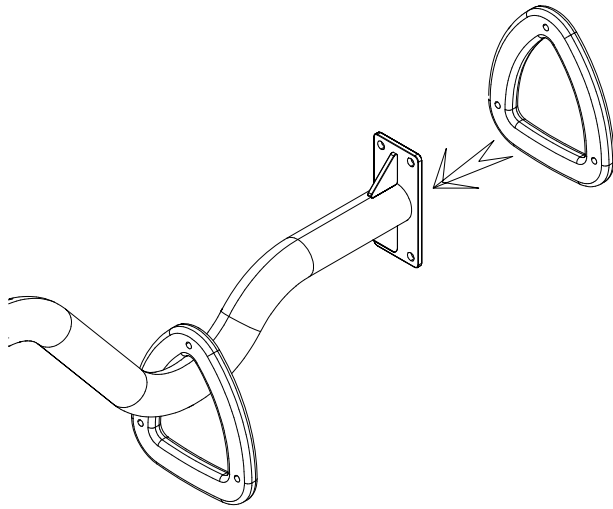

DET 14

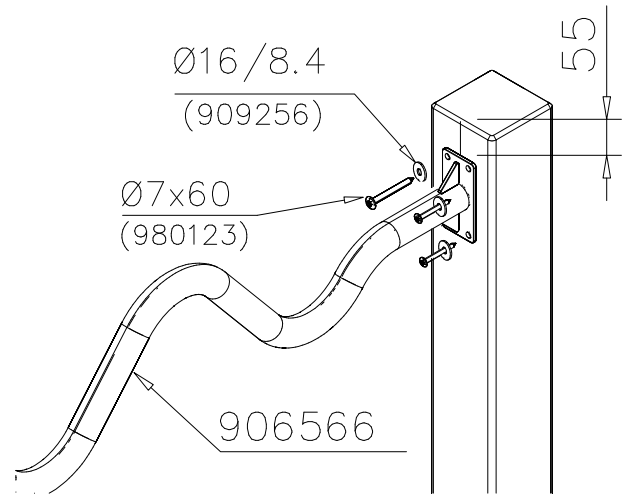

DET 15

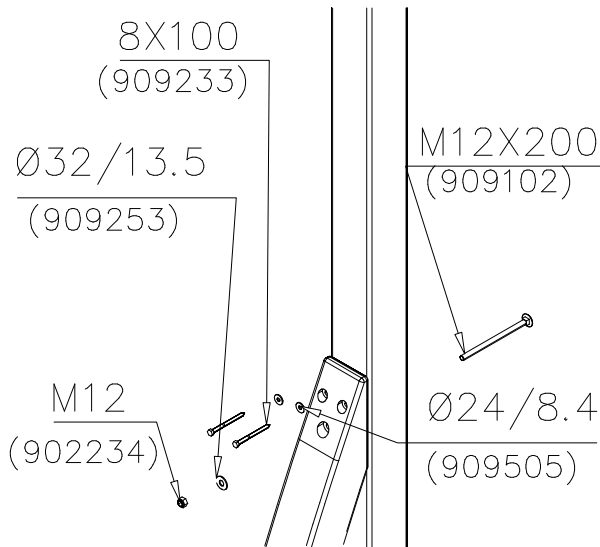

DET 16

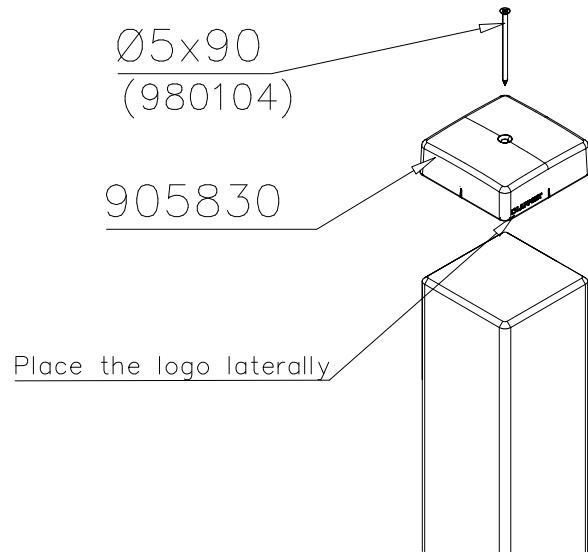

DET 17

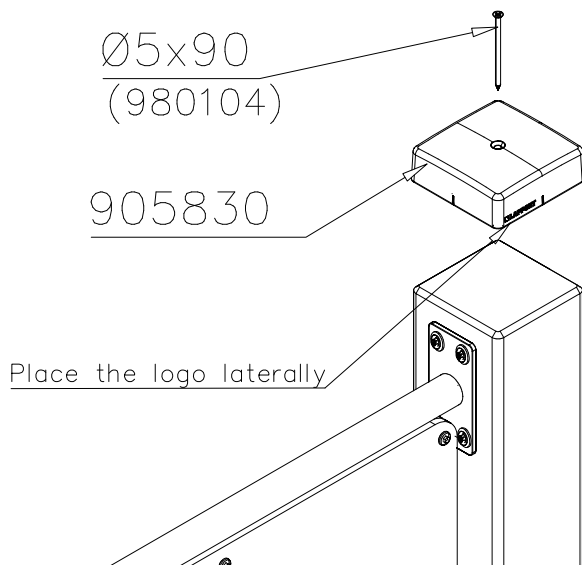

DET 18

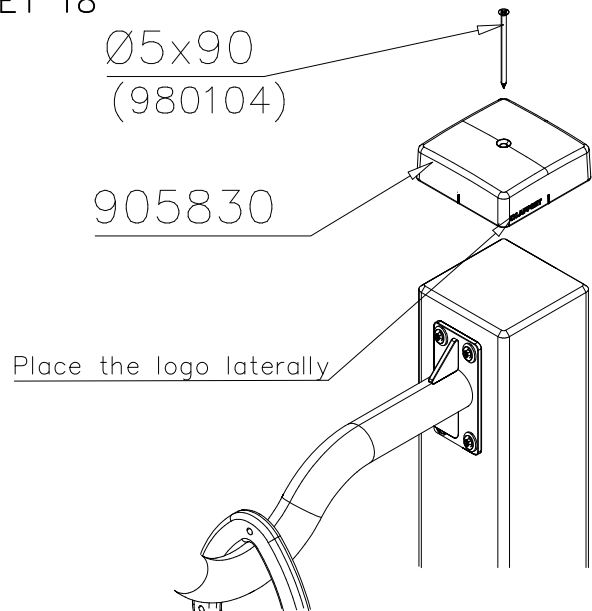

DET 19

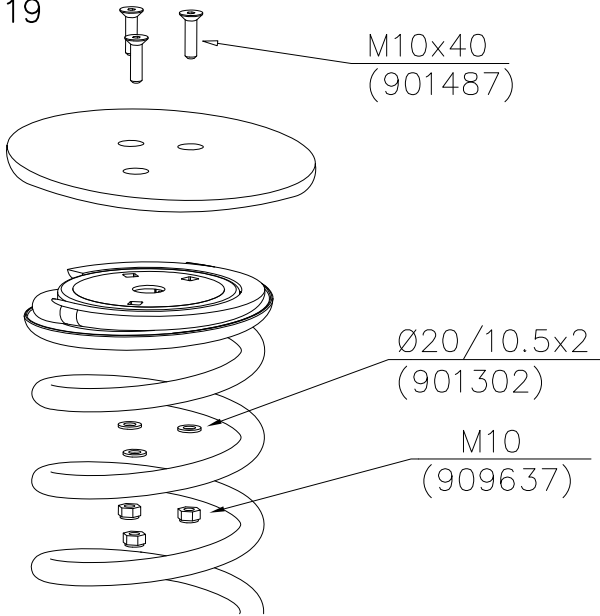

DET 20

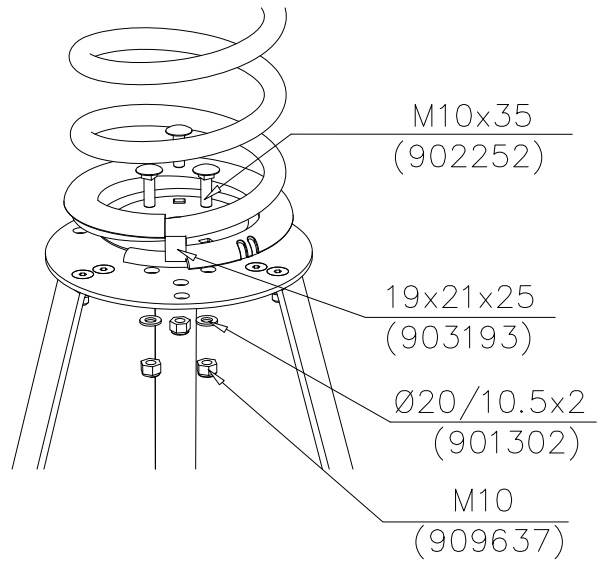

DET 21

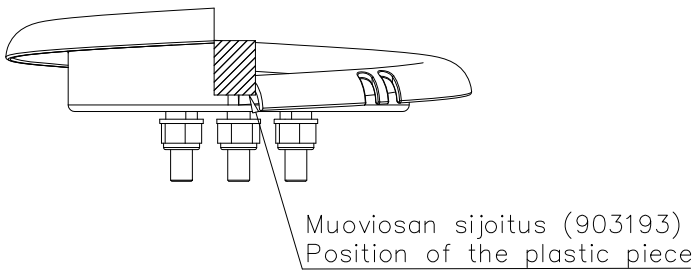

DET 22

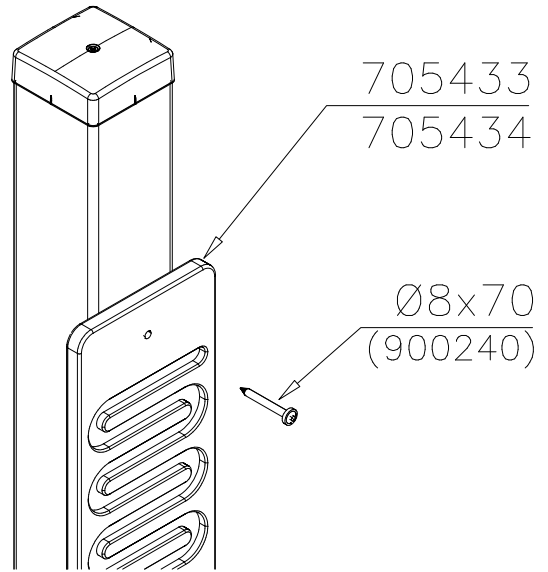

DET 23



DET 24

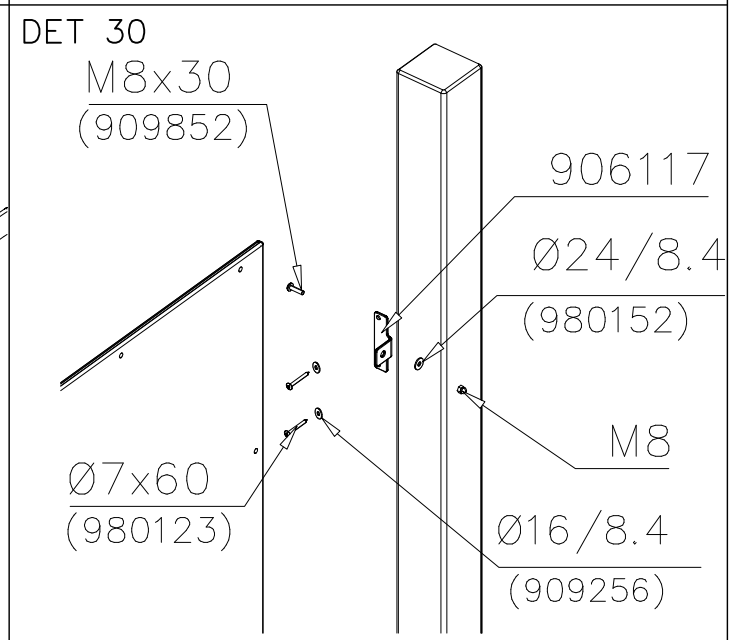
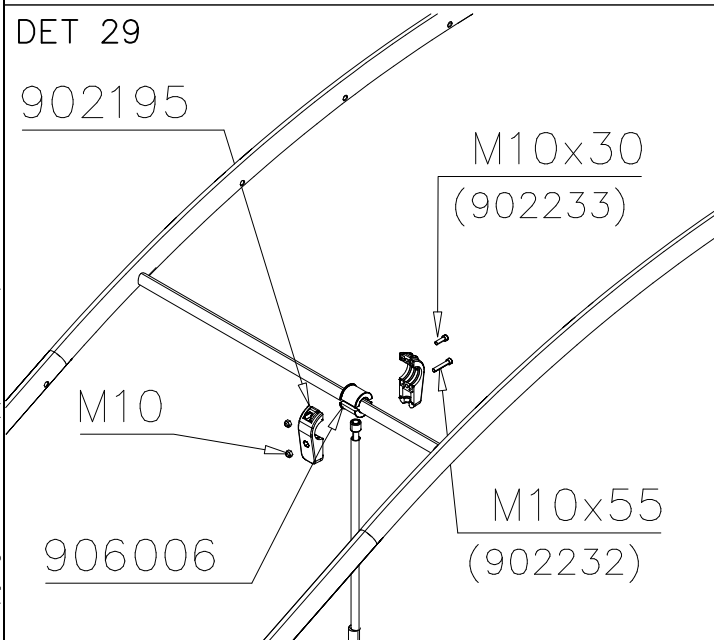
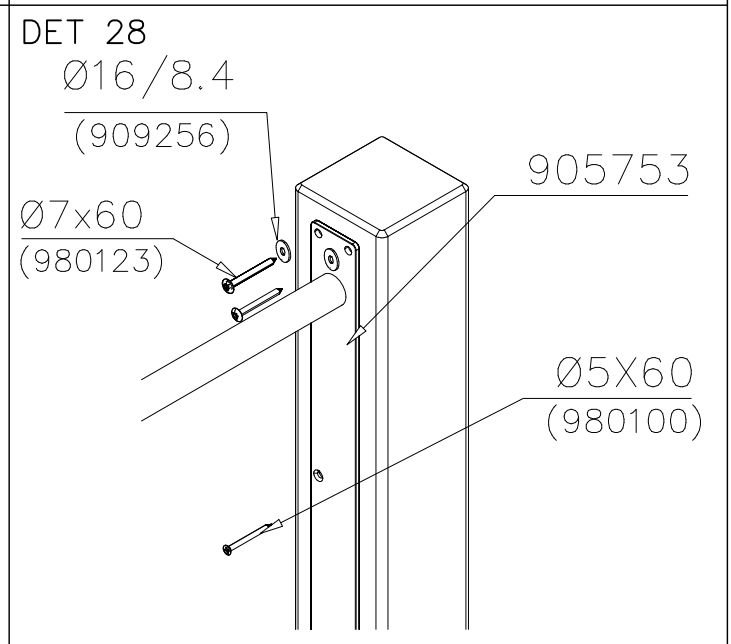
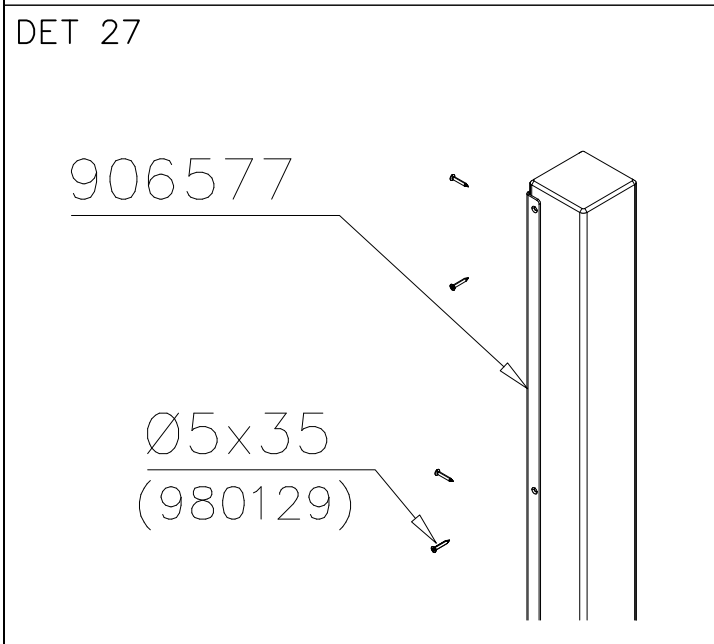
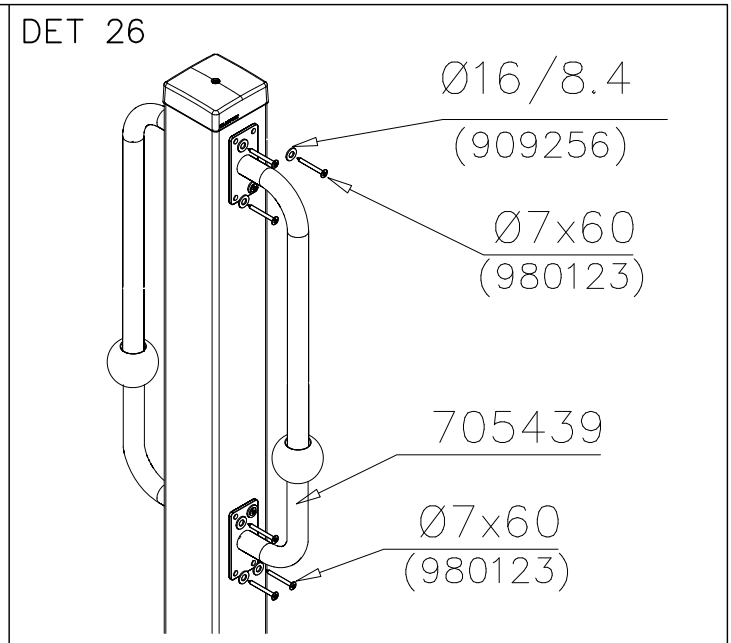
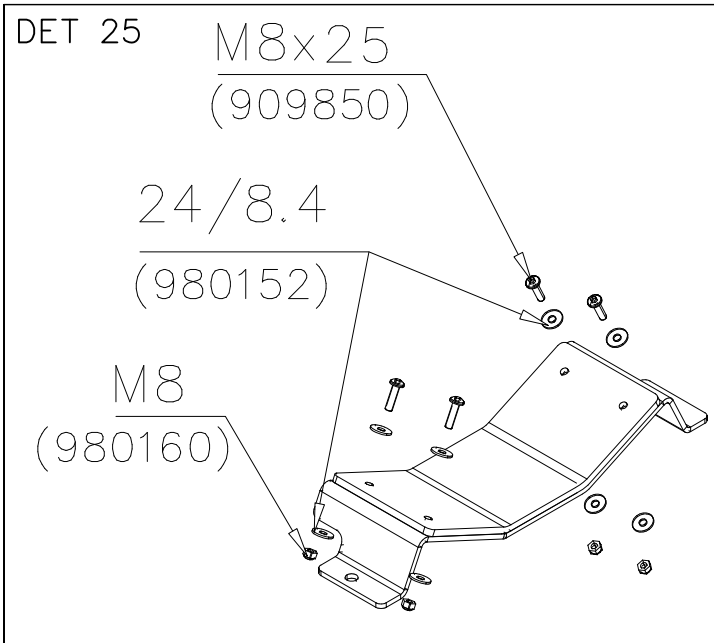

DET 31



DET 32

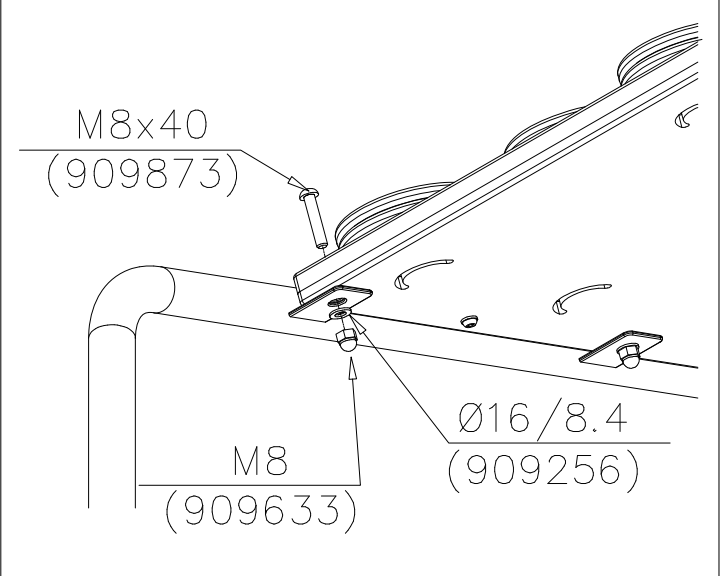

DET 33

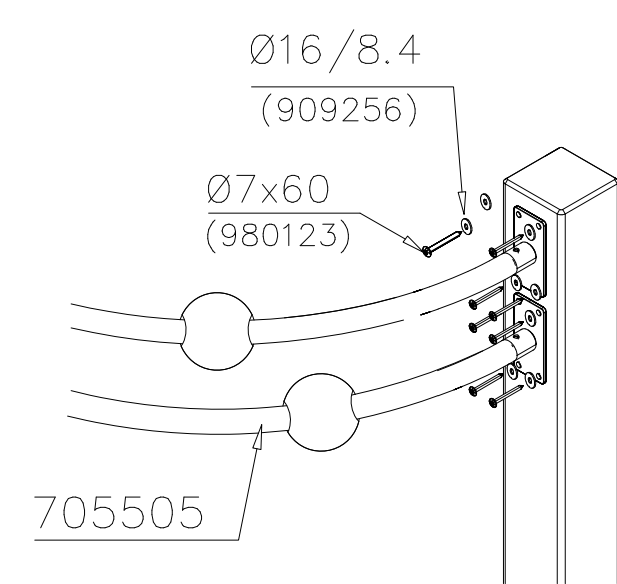

DET 34

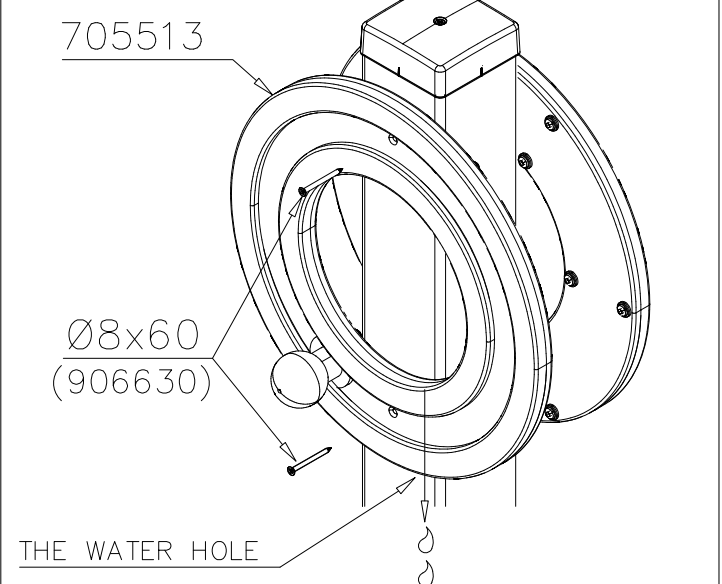

DET 35

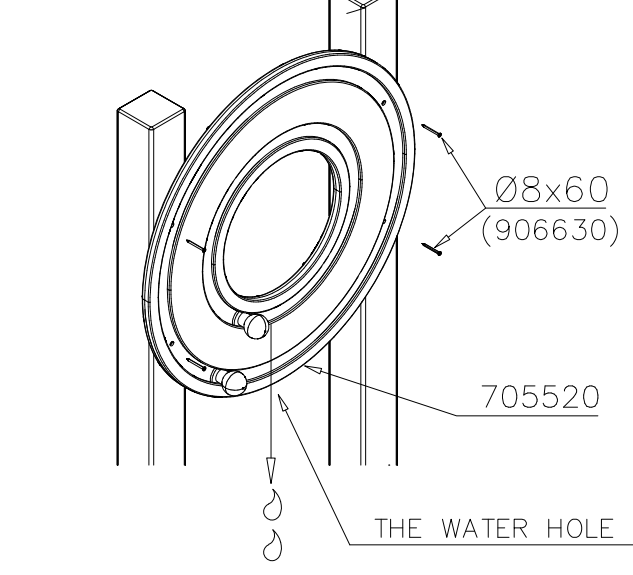

DET 36

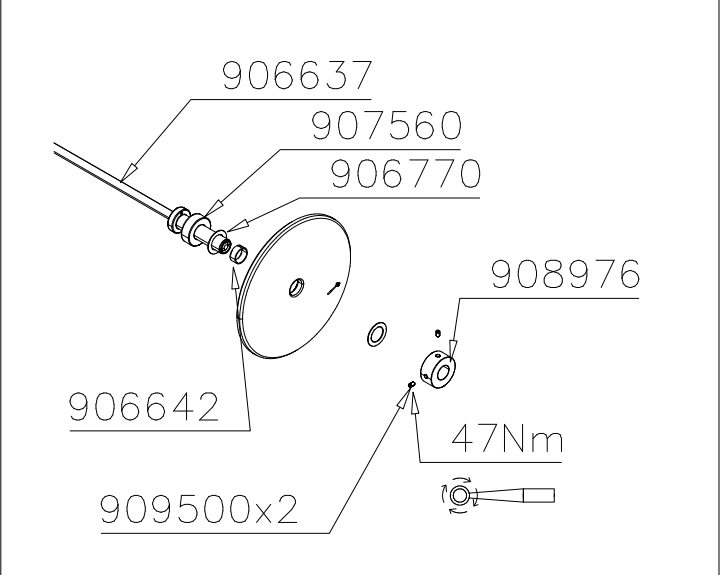

DET 37



DET 38



DET 39

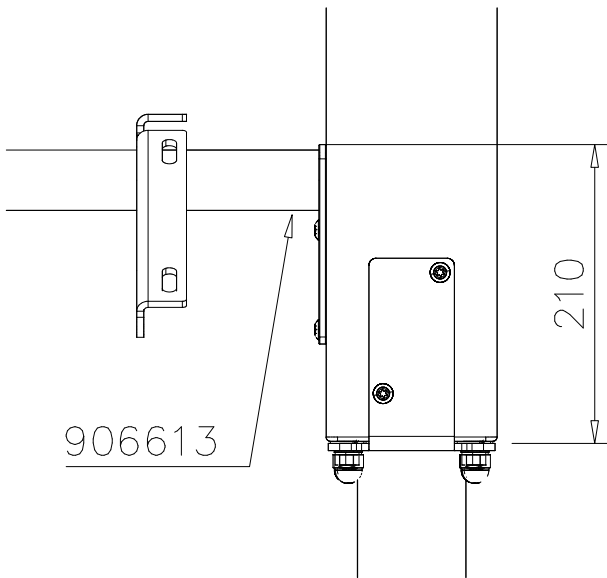

DET 40

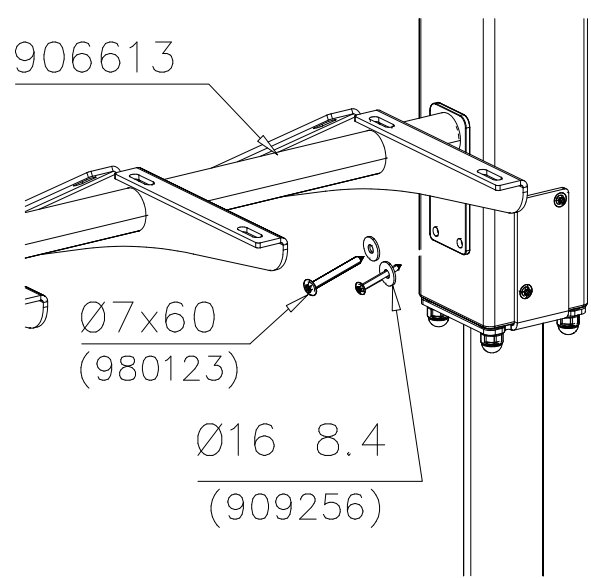

DET 41



DET 42

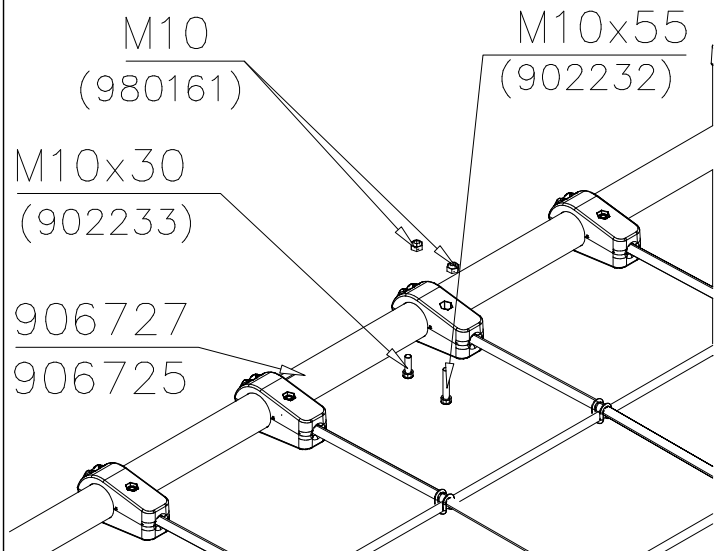

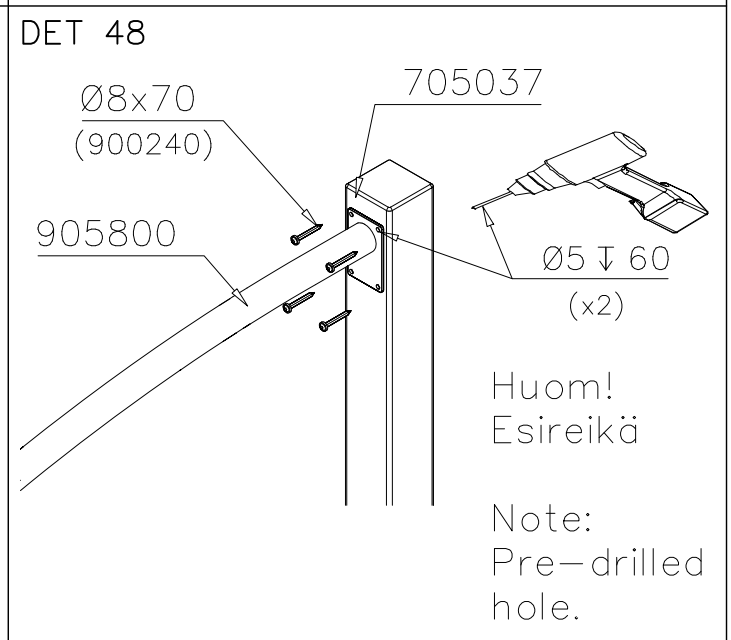
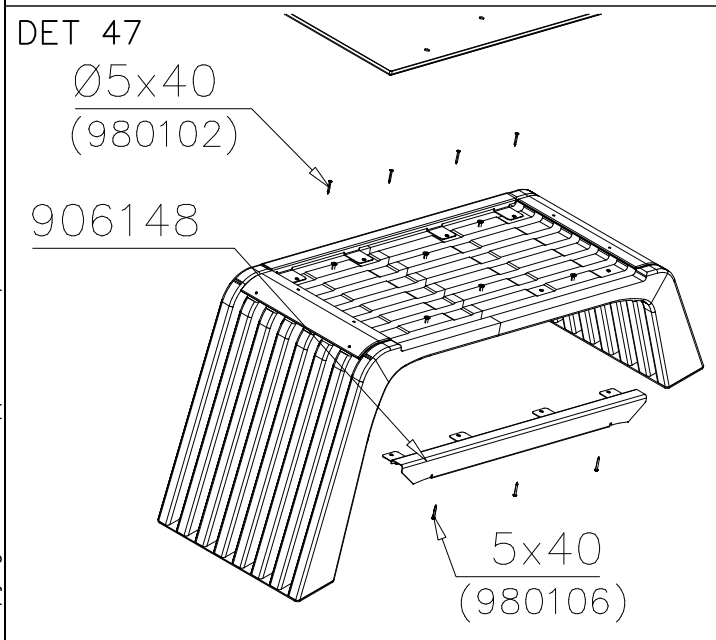

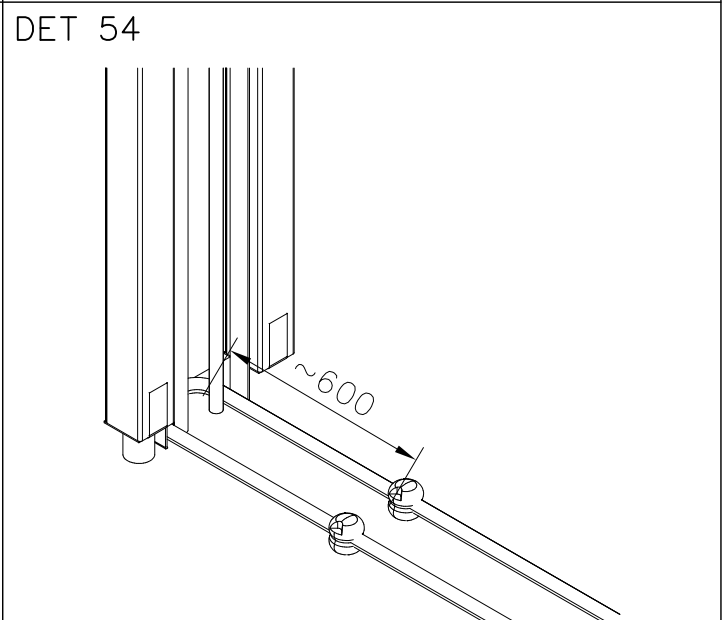
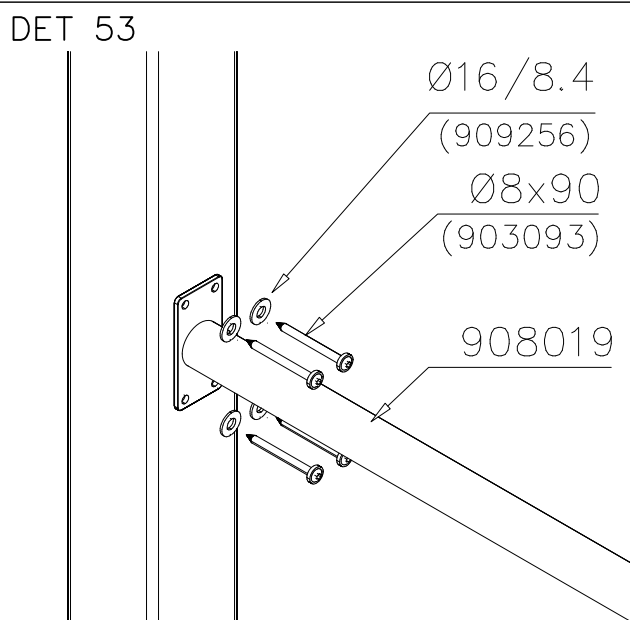
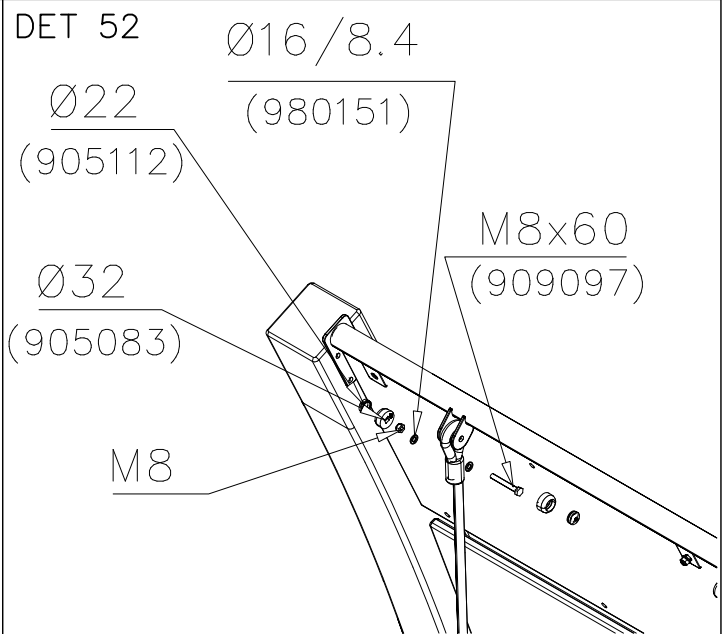
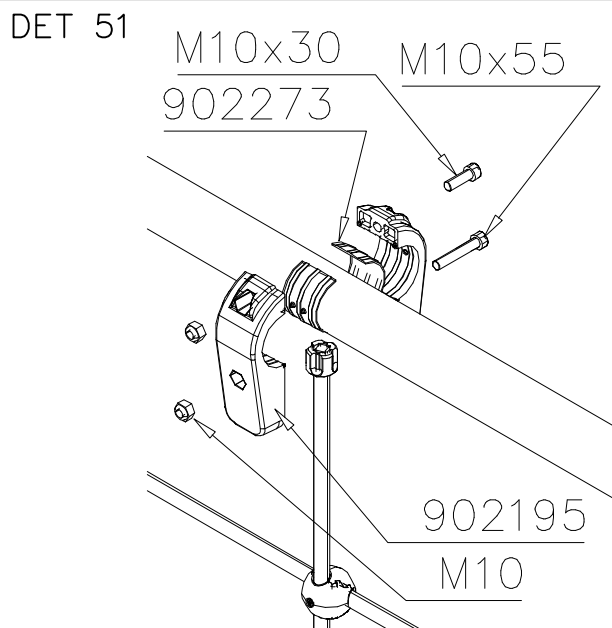
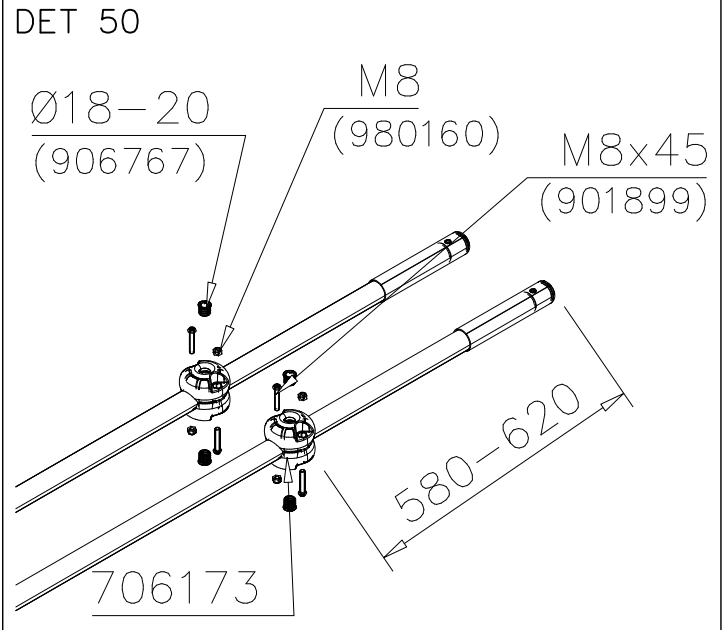
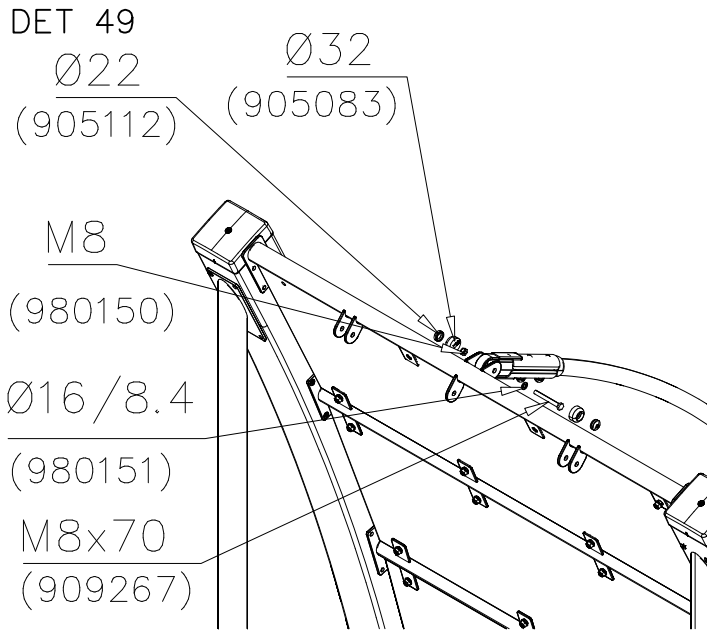

DET 55

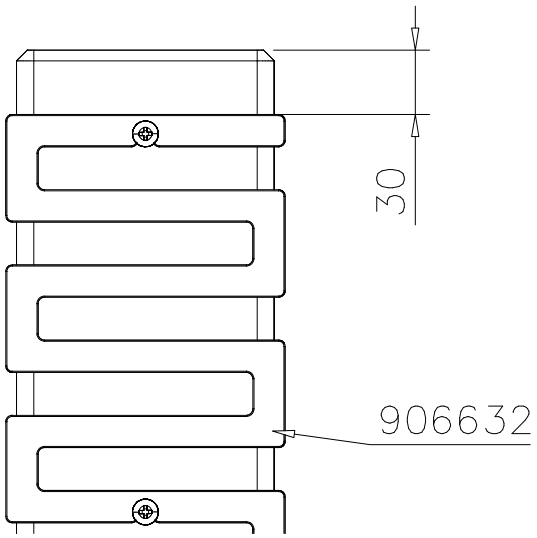

DET 56

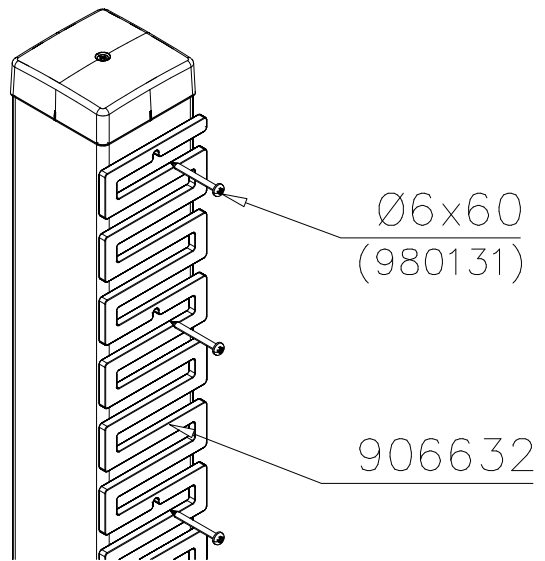

DET 57

DET 58

DET 59

DET 60

① SHEET METAL	PCS	② 980114	PCS
	1		4
118x78x0.7		Ø4x20	

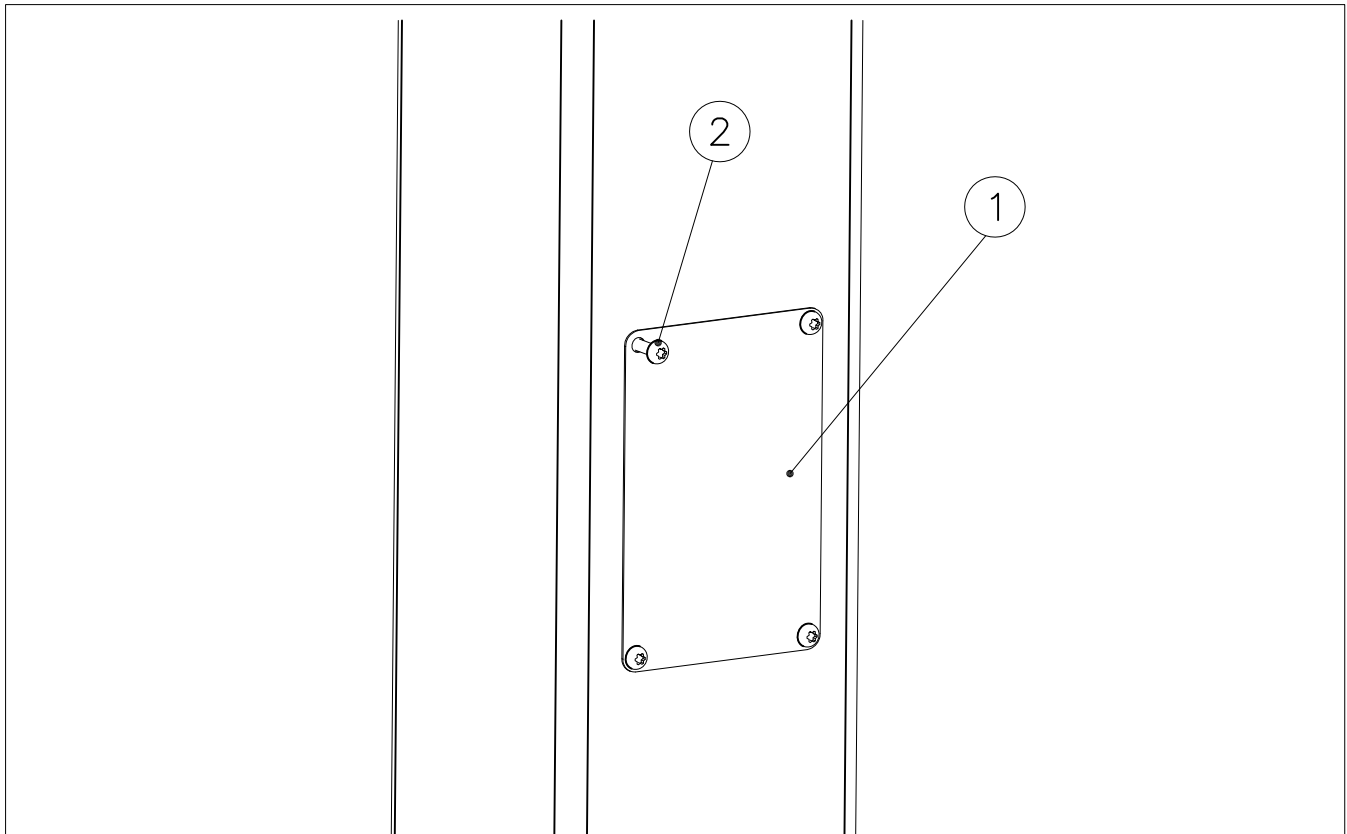

Example installation !
Esimerkki asennus !

Example installation !
Esimerkki asennus !

Example installation !
Esimerkki asennus !



Example installation !
Esimerkki asennus !

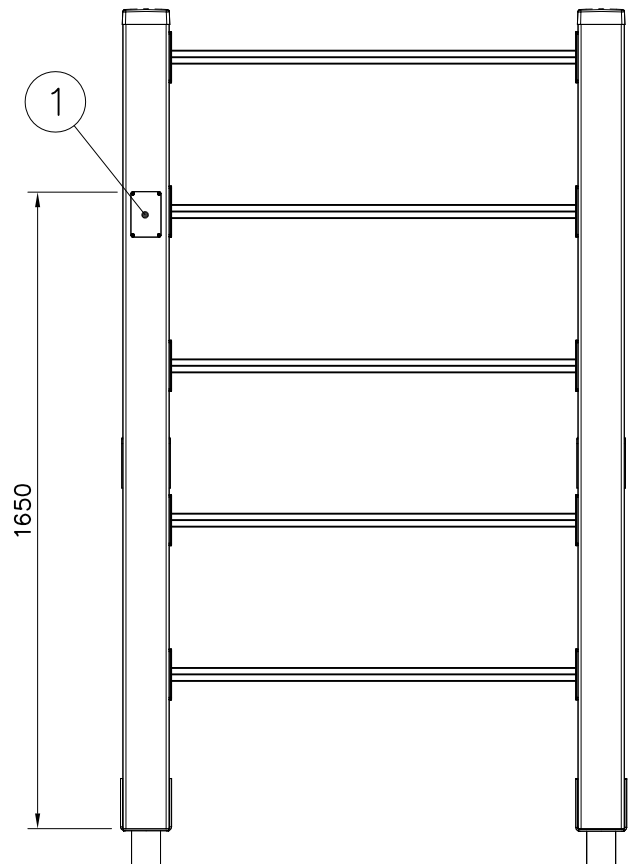

Example installation !
Esimerkki asennus !