

|   |            |     |   |              |     |
|---|------------|-----|---|--------------|-----|
| ① | 706043     | PCS | ② | 705018       | PCS |
|   |            | 1   |   |              | 2   |
|   |            |     |   | 120x120x1170 |     |
| ③ | 980123     | PCS | ④ | 980114       | PCS |
|   |            | 16  |   |              | 4   |
|   | Ø7x60      |     |   | Ø4x20        |     |
| ⑤ | 905104     | PCS | ⑥ | 905761       | PCS |
|   |            | 8   |   |              | 2   |
|   | M10        |     |   | 120x120x700  |     |
| ⑦ | 905830     | PCS | ⑧ | 906576       | PCS |
|   |            | 2   |   |              | 1   |
|   | 123x123x40 |     |   | 1960x130x60  |     |
| ⑨ | 980104     | PCS | ⑩ | 909256       | PCS |
|   |            | 2   |   |              | 16  |
|   | Ø5x90      |     |   | Ø16/8.4      |     |
|   |            | PCS |   |              | PCS |
|   |            |     |   |              |     |
|   |            | PCS |   |              | PCS |
|   |            |     |   |              |     |
|   |            | PCS |   |              | PCS |
|   |            |     |   |              |     |

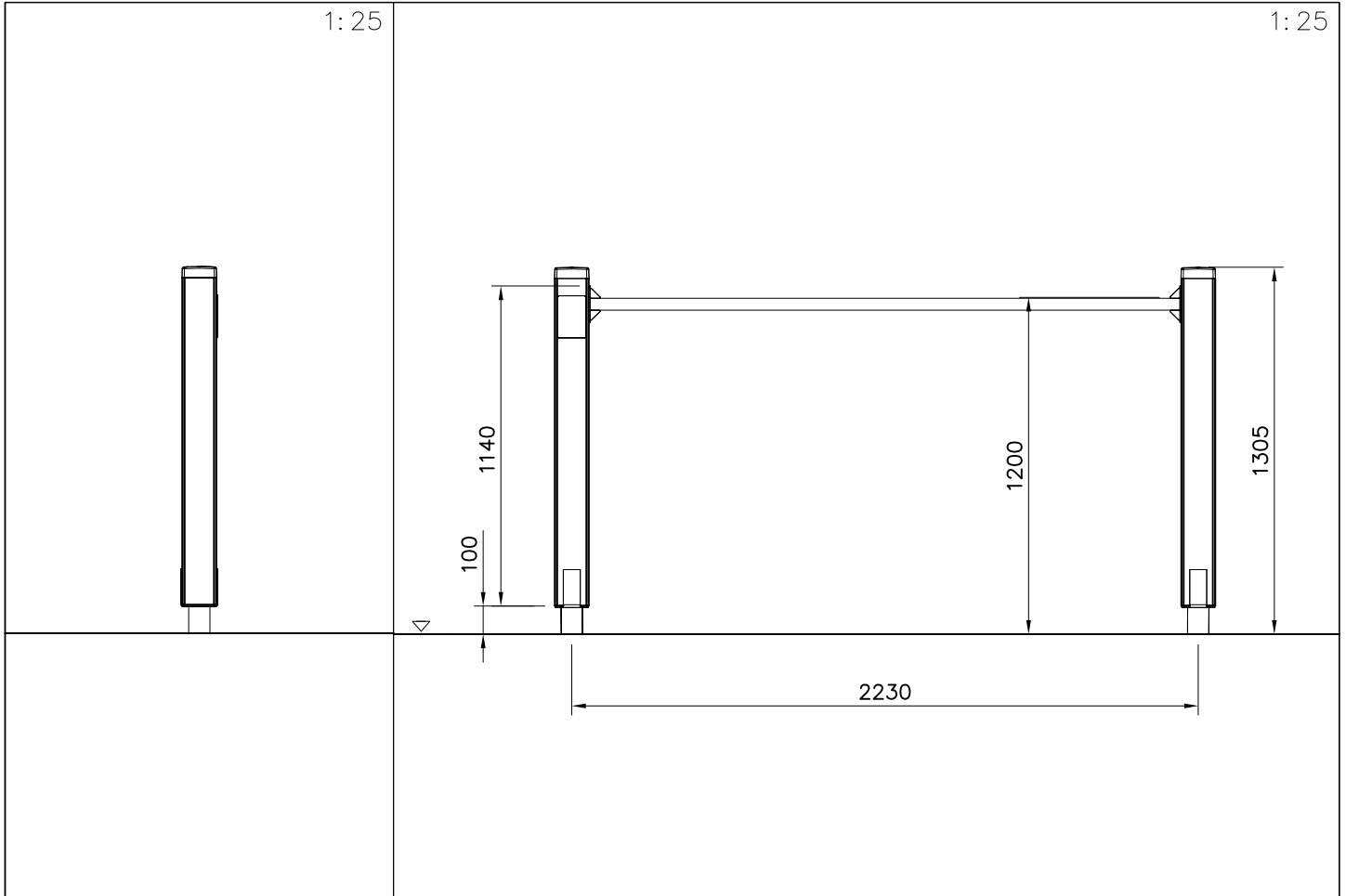

Area of Movement 14.8 m<sup>2</sup>  
Impact Area 14.8 m<sup>2</sup>  
Training Space 7.4 m<sup>2</sup>  
Max Falling Height 1200 mm

1:40

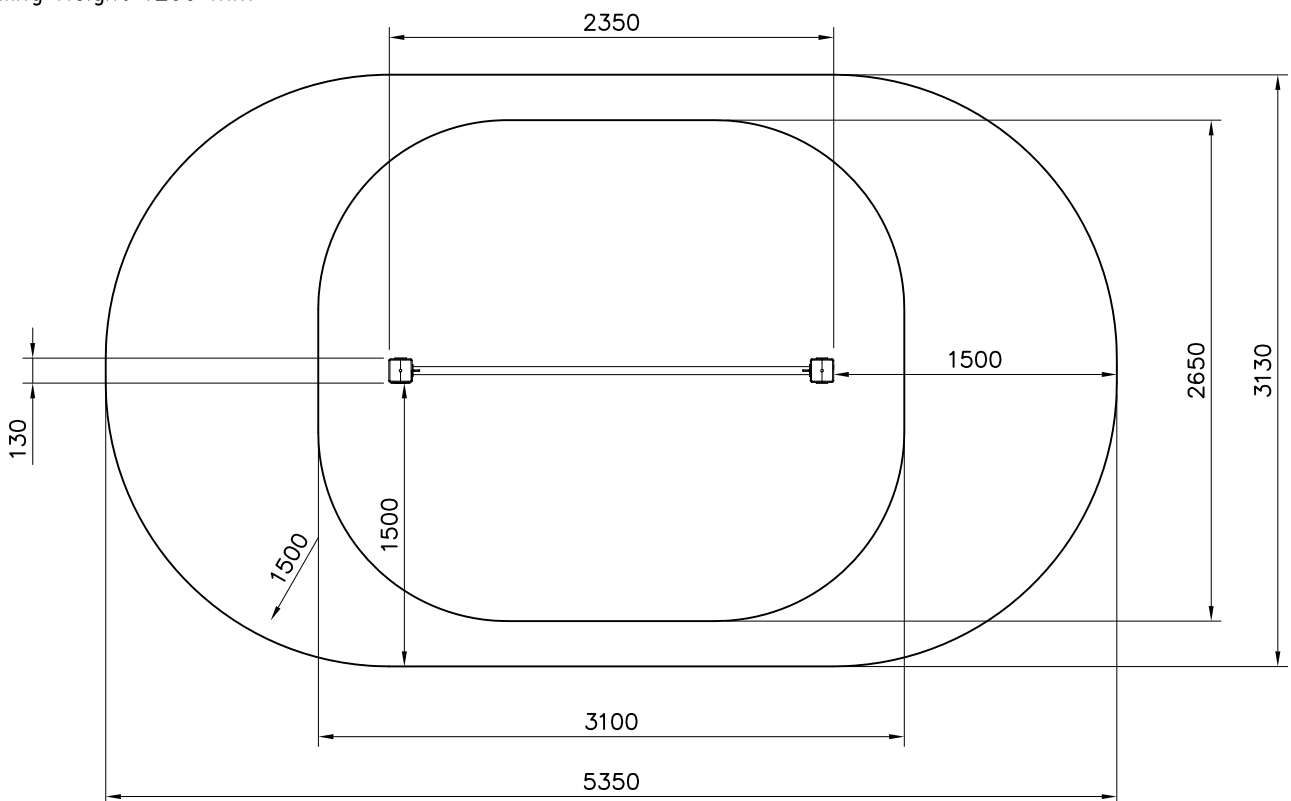

|   |  |   |                 |                 |                |         |                |         |                |       |                |   |
|---|--|---|-----------------|-----------------|----------------|---------|----------------|---------|----------------|-------|----------------|---|
|                 |  |   |                 |                 |                |         |                |         |                |       |                |   |
| <p><b><math>h &lt; 600</math></b></p> <p>Without movement and therefore without Impact Area</p> | <p>Totally hard surfaces.</p> <p>Note. Lappset does <u>not recommend</u> totally hard surfaces at all.</p>   | <p>E.g. concrete or asphalt</p>    |                 |                 |                |         |                |         |                |       |                |   |
| <p><b><math>h &lt; 600</math></b></p> <p>With movement e.g. rocking</p>                         | <p>Materials with very limited impact attenuating properties.</p>  | <p>E.g. wood</p>   |                 |                 |                |         |                |         |                |       |                |   |
| <p><b><math>h &lt; 1000</math></b></p>  | <p>Materials with significant impact attenuating properties.</p>   | <p>fine gravel 0–8 mm</p>  <p>grass</p>  <p>unsorted sand</p>  |                 |                 |                |         |                |         |                |       |                |   |
| <p><b><math>h &lt; 3000</math></b></p>  | <p>Loose fill material</p> <p>E.g.<br/>sand/gravel 0,25...8 mm D60/D10&lt;3,0<br/>Woodchips 5...30 mm<br/>bark 20...80 mm</p>  |  <table data-bbox="1021 1691 1332 1792"> <tr> <td><math>\underline{S}</math></td> <td><math>\underline{h}</math></td> </tr> <tr> <td>30 cm</td> <td>&lt; 2,0 m</td> </tr> <tr> <td>40 cm</td> <td>&lt; 3,0 m</td> </tr> </table>       | $\underline{S}$ | $\underline{h}$ | 30 cm          | < 2,0 m | 40 cm          | < 3,0 m |                |       |                |   |
| $\underline{S}$   | $\underline{h}$  |   |                 |                 |                |         |                |         |                |       |                |   |
| 30 cm   | < 2,0 m  |   |                 |                 |                |         |                |         |                |       |                |   |
| 40 cm   | < 3,0 m  |   |                 |                 |                |         |                |         |                |       |                |   |
|   | <p>Syntethic granulates</p> <table data-bbox="406 1892 758 2060"> <tr> <td><math>\underline{S}</math></td> <td><math>\underline{h}</math></td> </tr> <tr> <td>40 mm</td> <td>~&gt; 1,2...1,3 m</td> </tr> <tr> <td>50 mm</td> <td>~&gt; 1,5...1,7 m</td> </tr> <tr> <td>60 mm</td> <td>~&gt; 1,8...2,0 m</td> </tr> <tr> <td>70 mm</td> <td>~&gt; 2,1...2,5 m</td> </tr> </table> <p>Note. For accurate values, see manufacturer's instructions.</p> | $\underline{S}$   | $\underline{h}$ | 40 mm           | ~> 1,2...1,3 m | 50 mm   | ~> 1,5...1,7 m | 60 mm   | ~> 1,8...2,0 m | 70 mm | ~> 2,1...2,5 m |  |
| $\underline{S}$   | $\underline{h}$  |   |                 |                 |                |         |                |         |                |       |                |   |
| 40 mm   | ~> 1,2...1,3 m   |   |                 |                 |                |         |                |         |                |       |                |   |
| 50 mm   | ~> 1,5...1,7 m   |   |                 |                 |                |         |                |         |                |       |                |   |
| 60 mm   | ~> 1,8...2,0 m   |   |                 |                 |                |         |                |         |                |       |                |   |
| 70 mm   | ~> 2,1...2,5 m   |   |                 |                 |                |         |                |         |                |       |                |   |

REMOVE SAFETY SURFACE/SAND/GRAVEL  
TO CHECK FOUNDATION



REMOVE SAFETY SURFACE/SAND/GRAVEL  
TO CHECK FOUNDATION



DET 1

$\varnothing 16 \downarrow > 130$

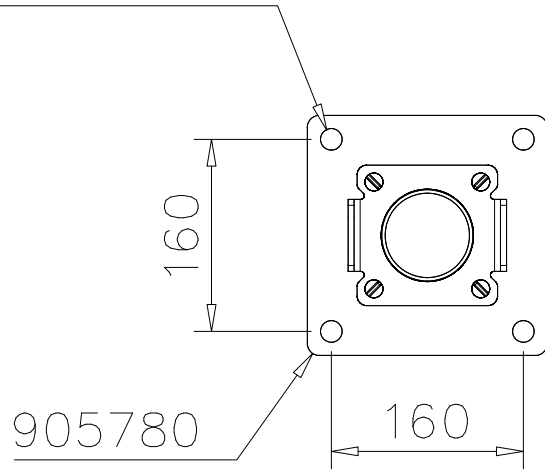

DET 2



DET 3



DET 4



DET 5

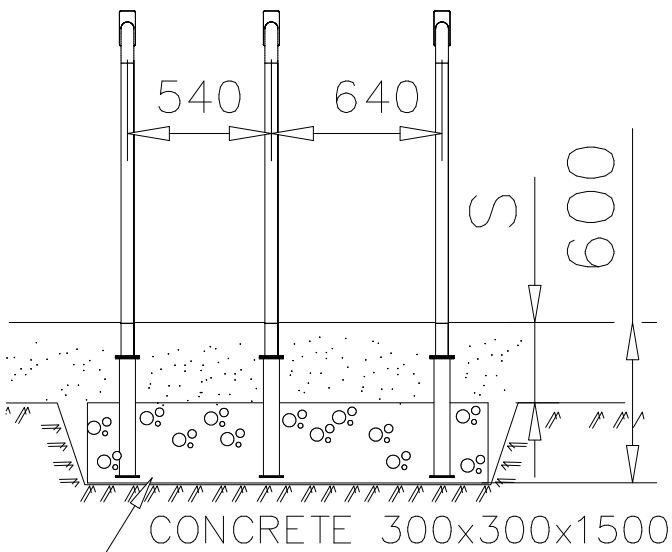

DET 6

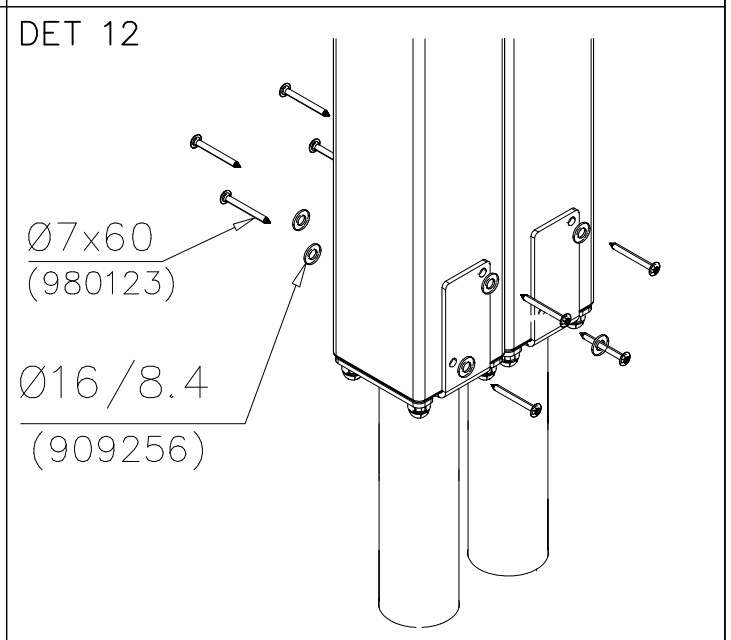
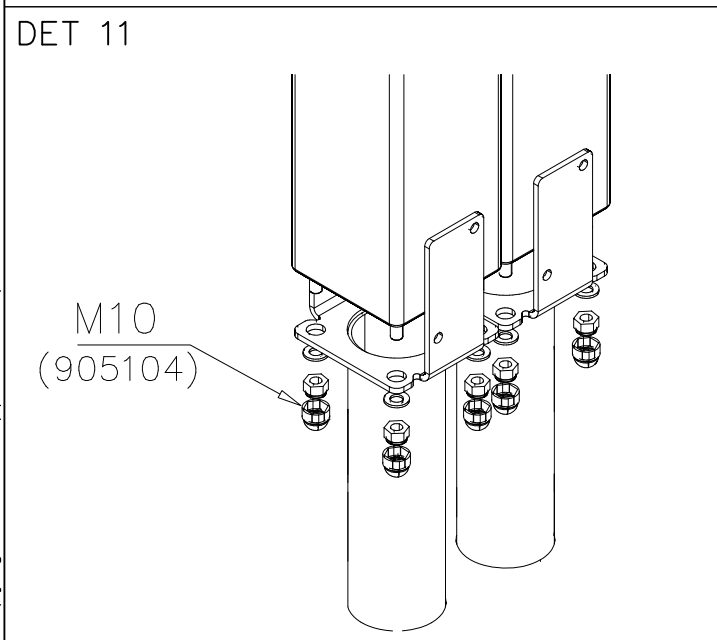
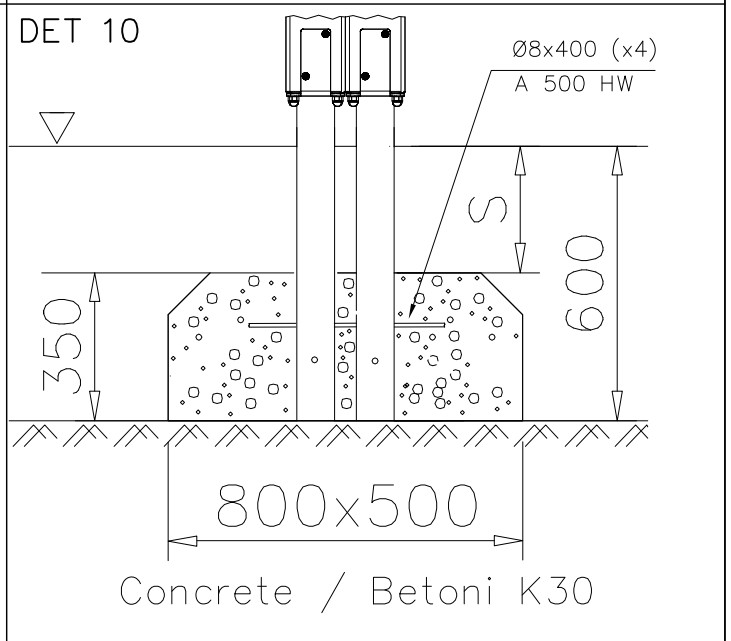
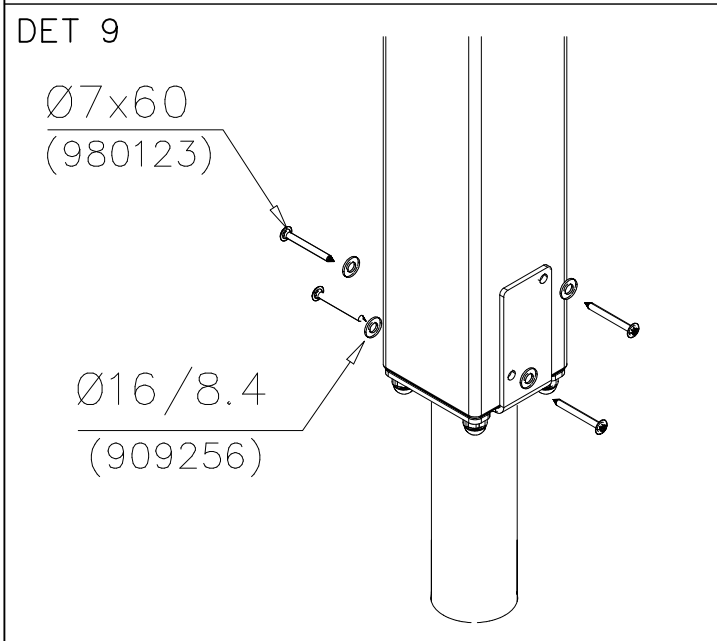
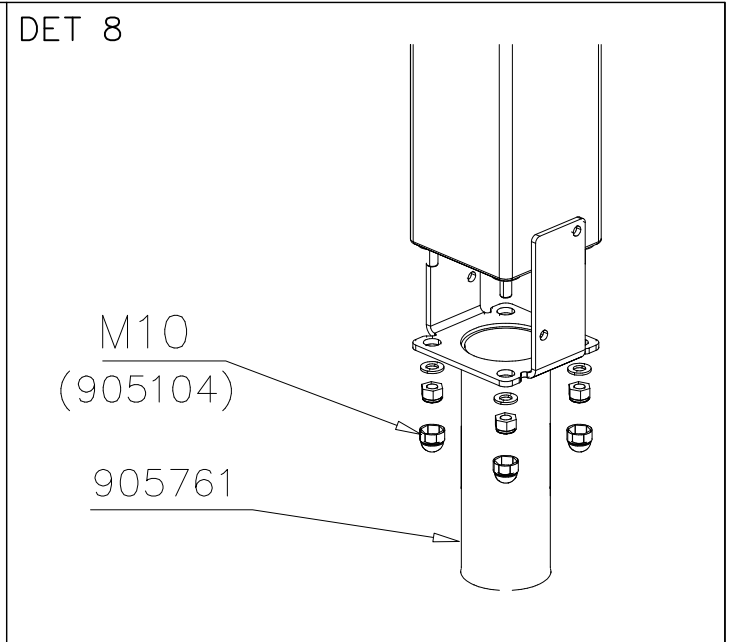
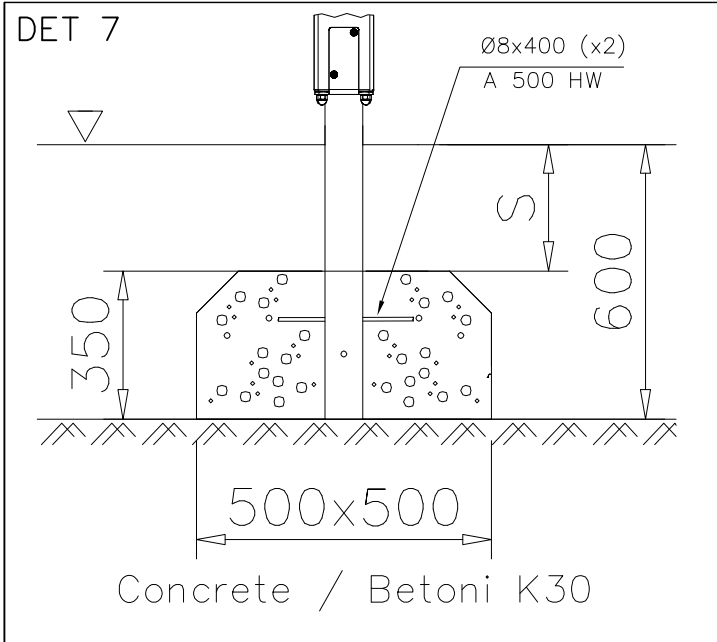

DET 13



DET 14



DET 15



DET 16

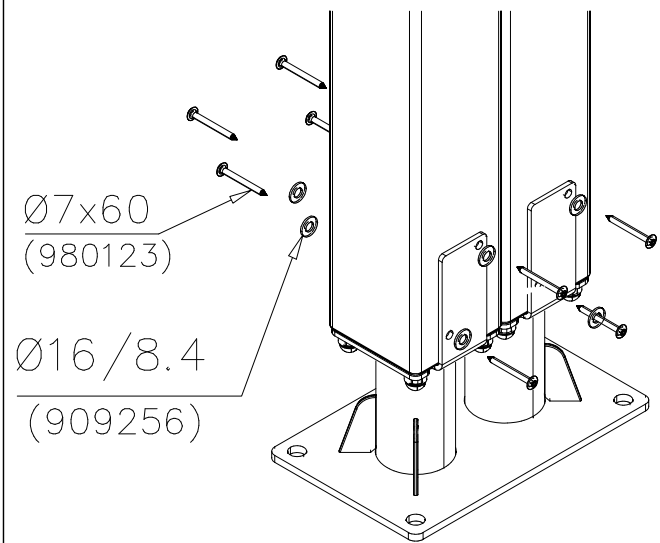

DET 17

DET 18

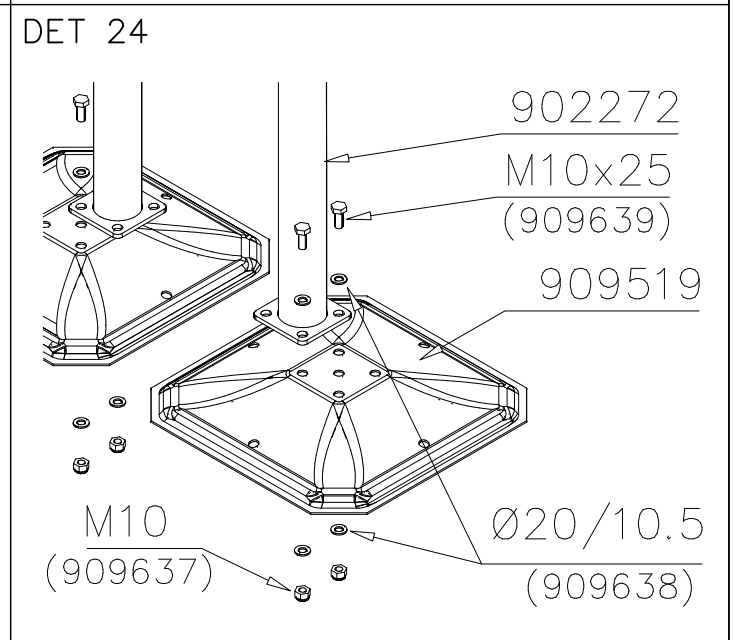
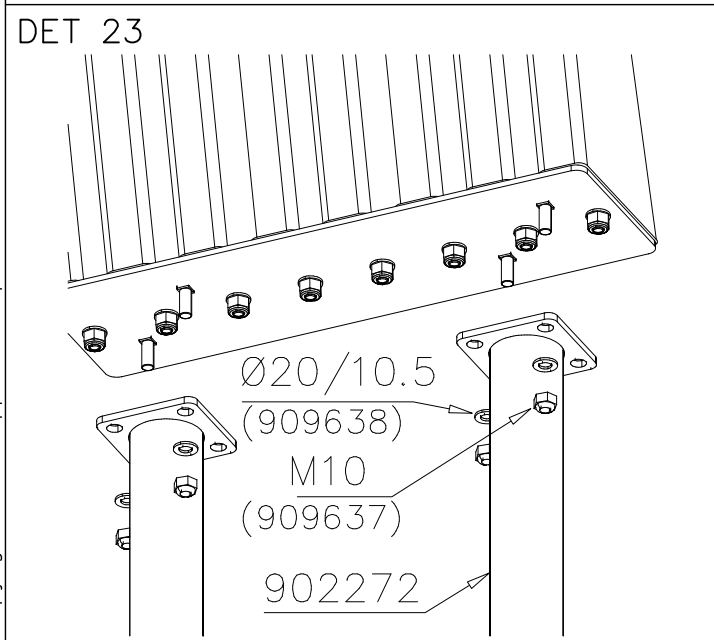
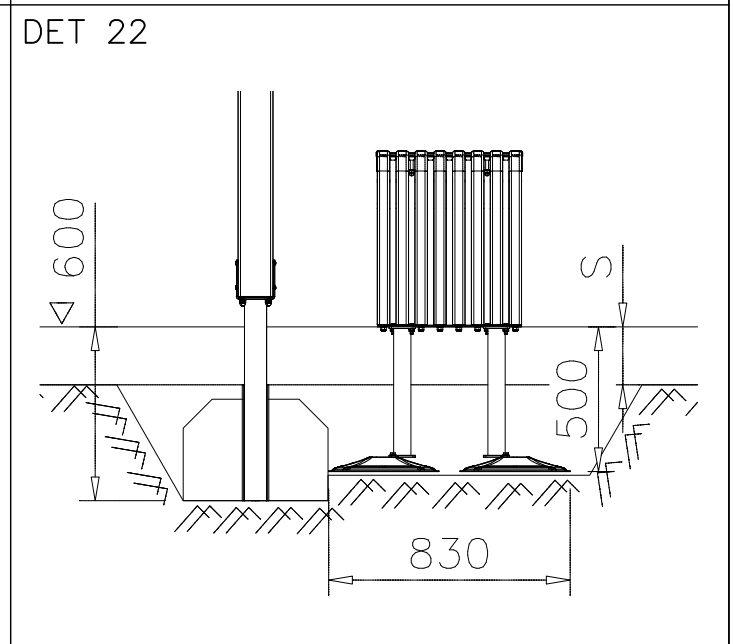
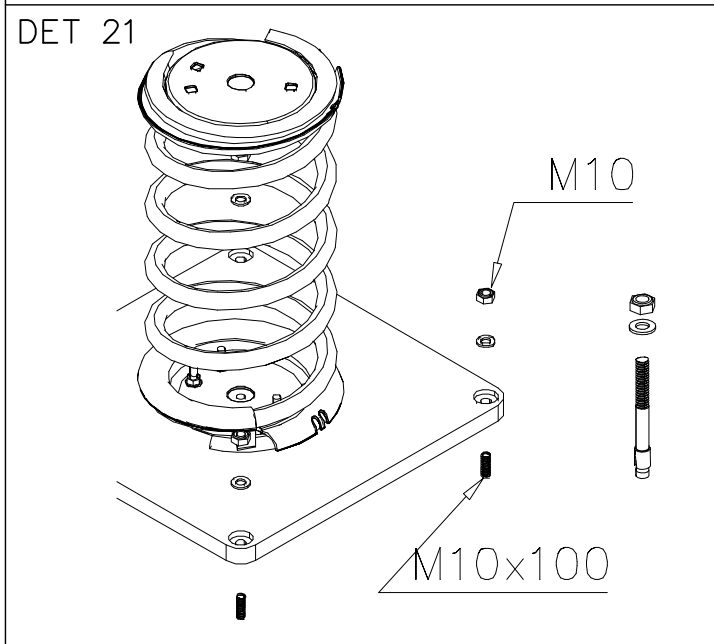
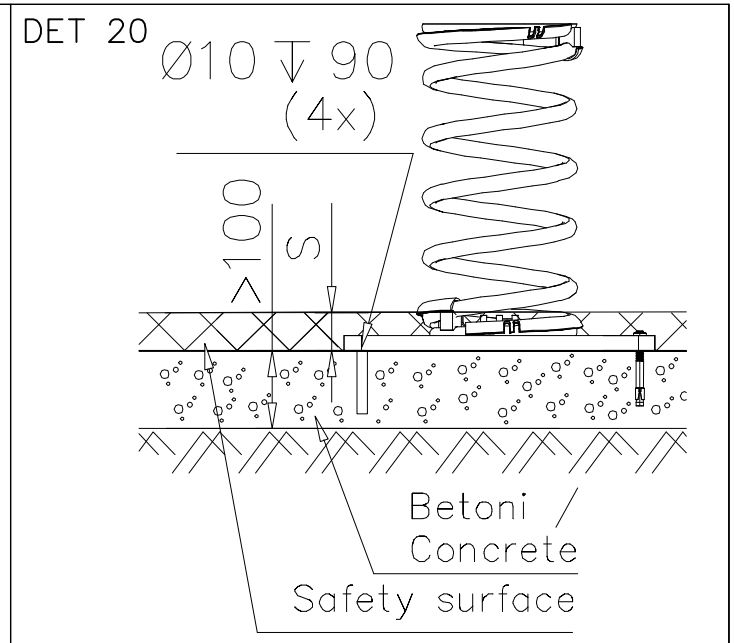
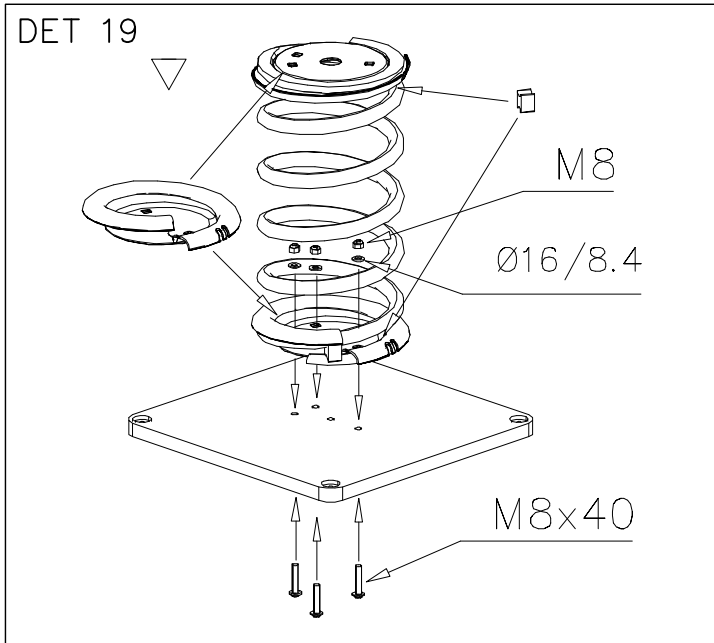





DET 31



DET 32

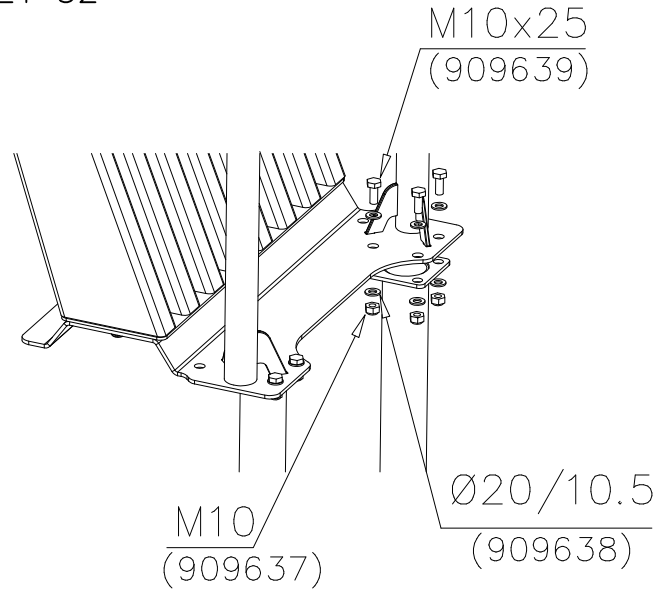

DET 33

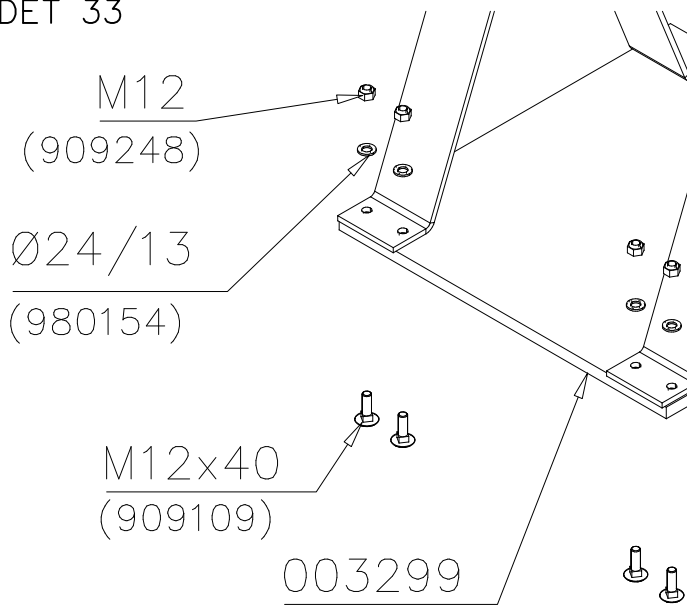

DET 34

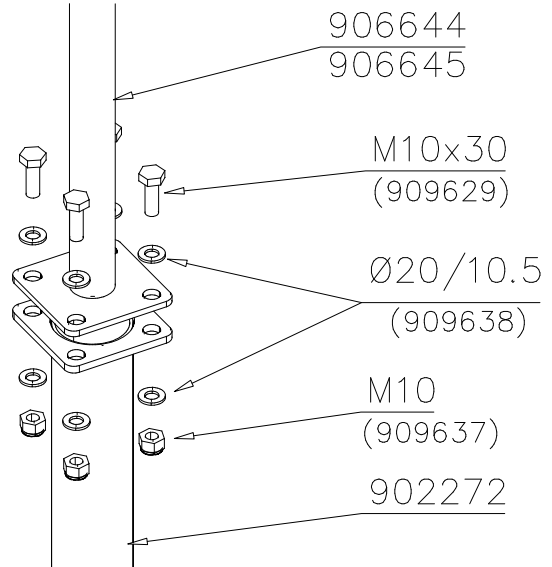

DET 35



DET 36



DET 37



DET 38



DET 39



DET 40



DET 41



DET 42

# LAPPSET SPORT

# BASE

DATE: 15.8.2017

8(10)

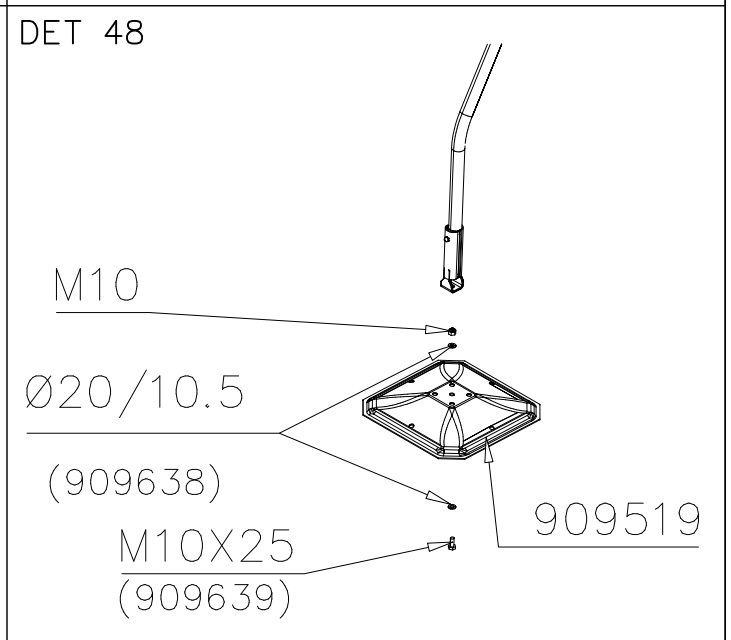
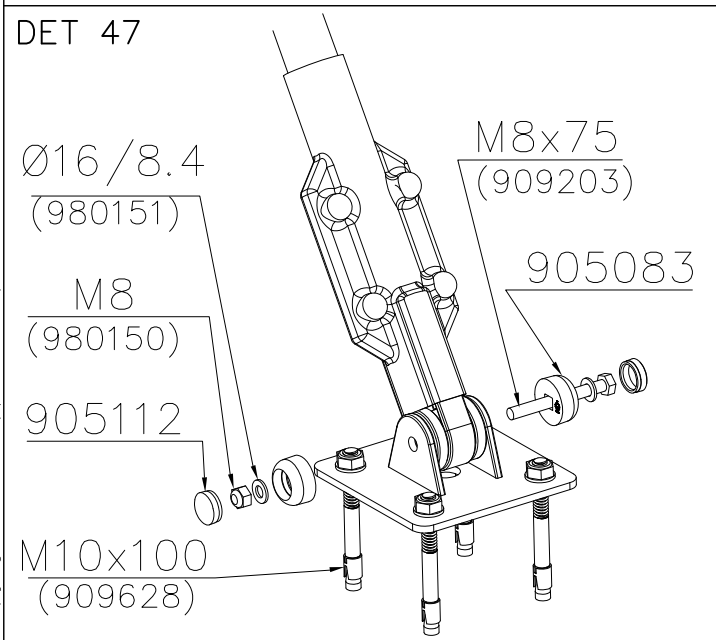
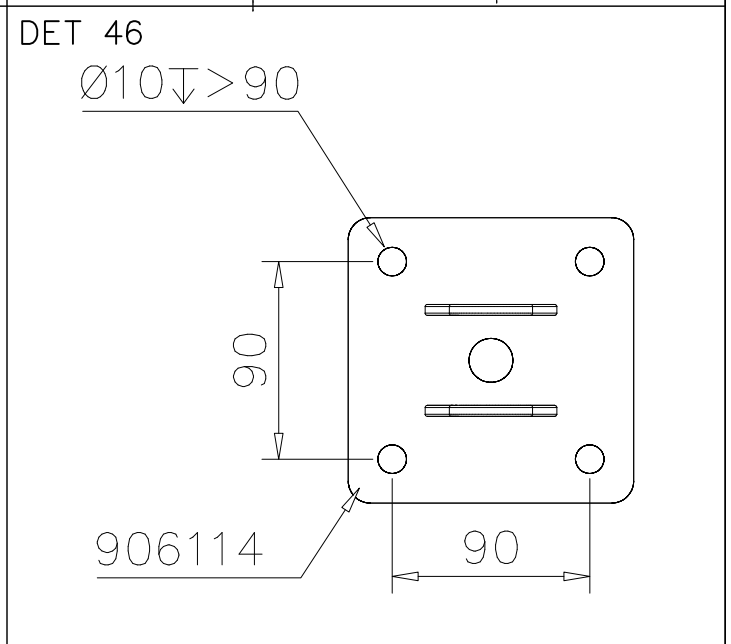
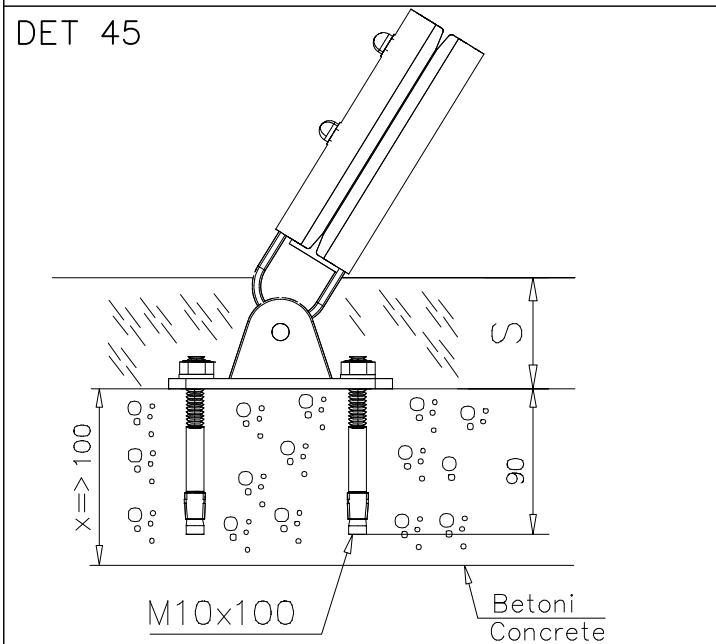
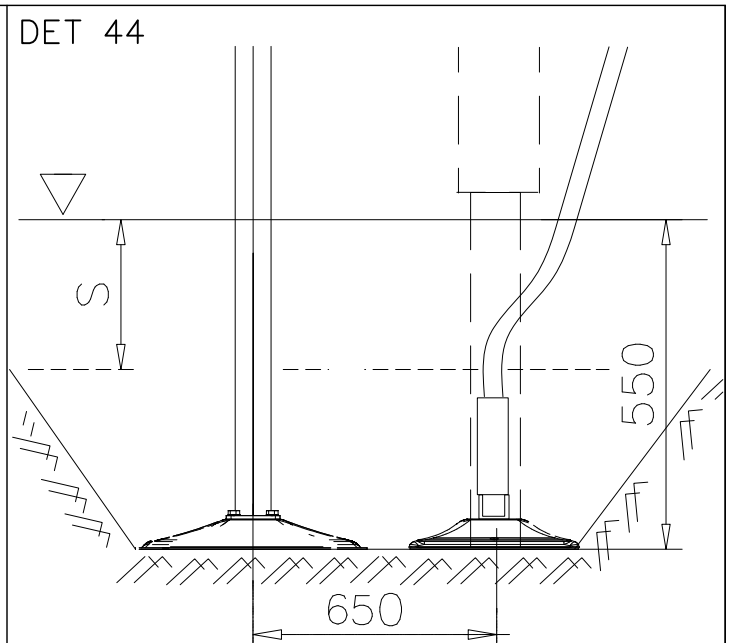
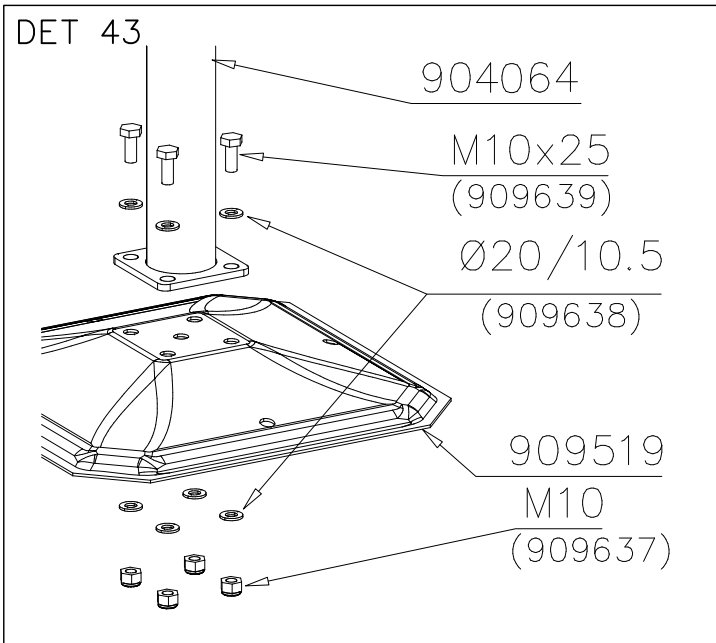

DET 49

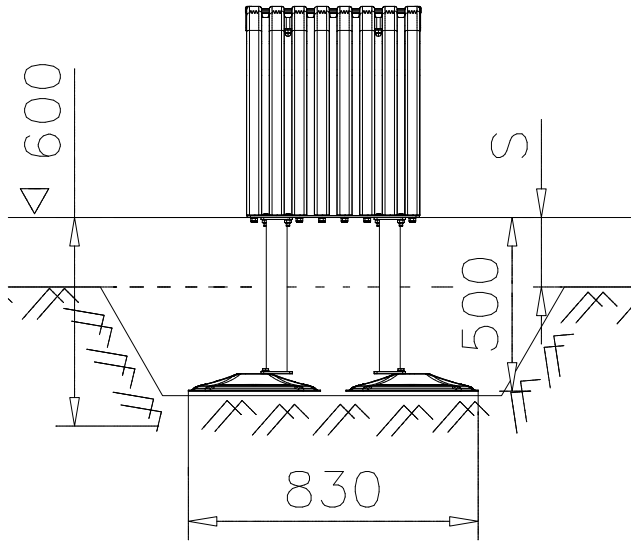

DET 50



DET 51

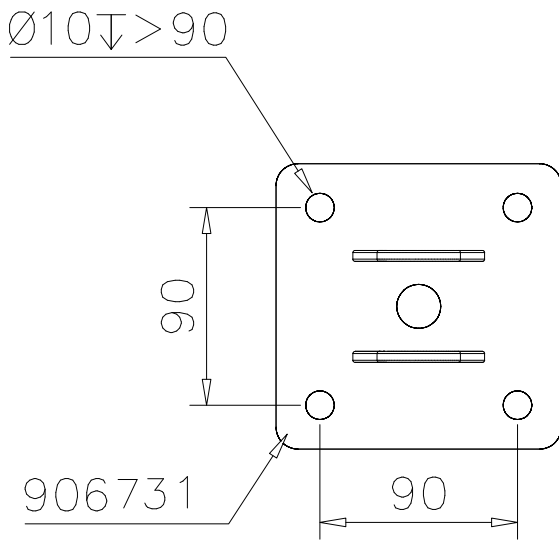

DET 52

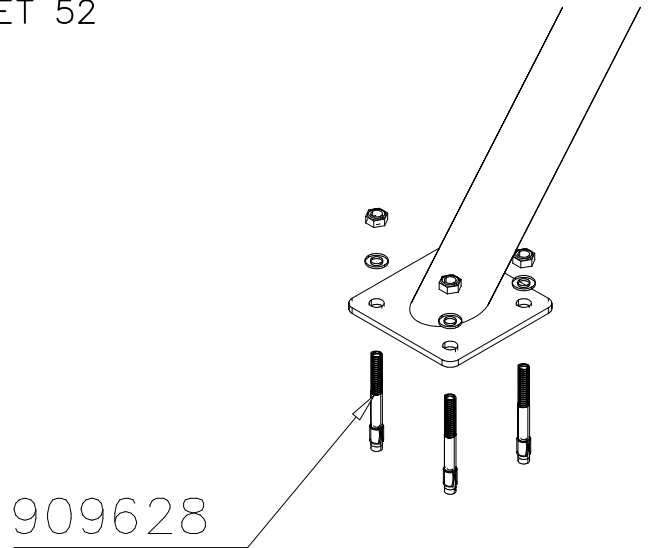

DET 53

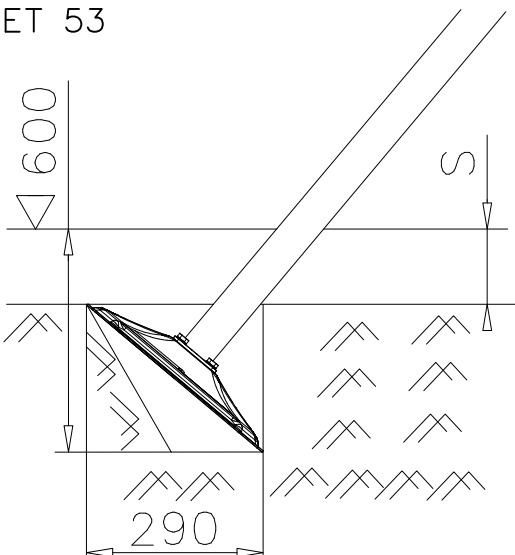

DET 54



DET 55

STEELNET Ø6 #150  
(1400x2100)  
Concrete  
1500X2200X200 K30

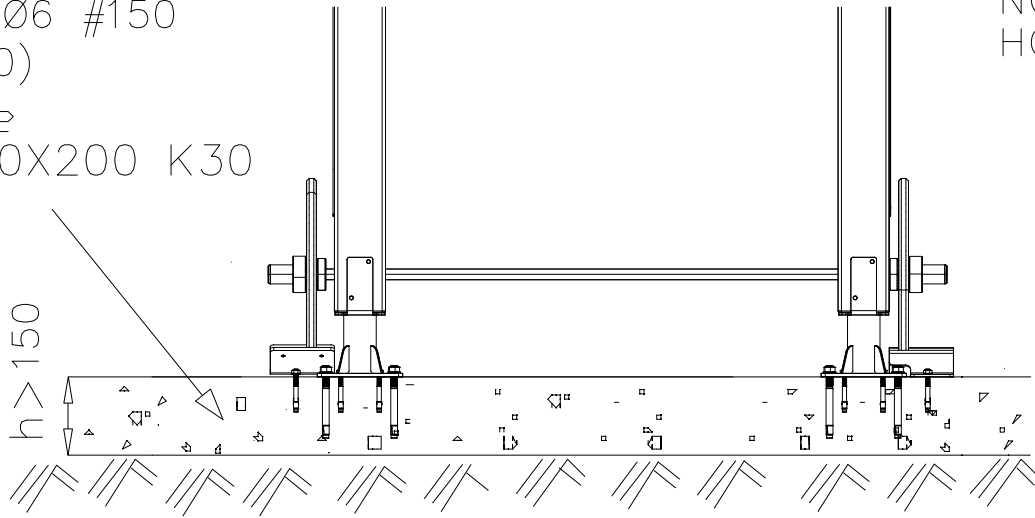

NOTE!  
HOX!

DET 56

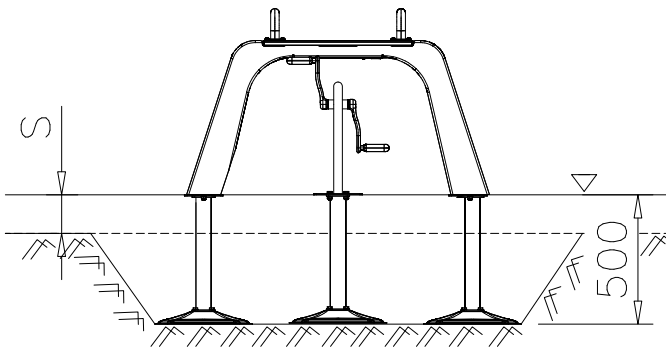

DET 57

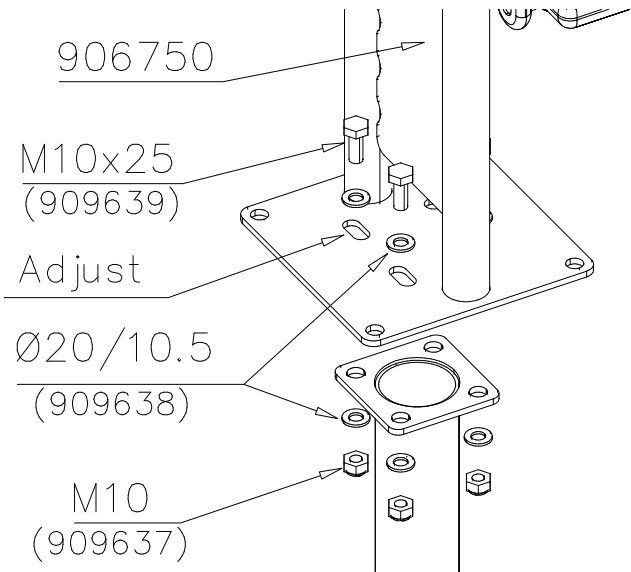

DET 58

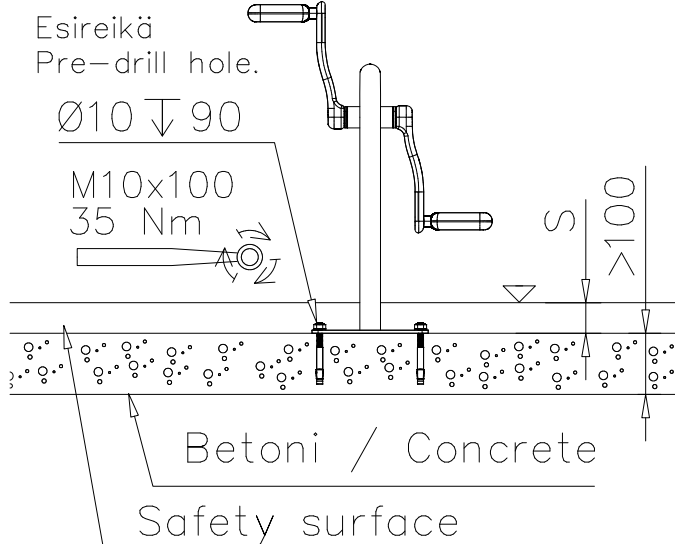

DET 59

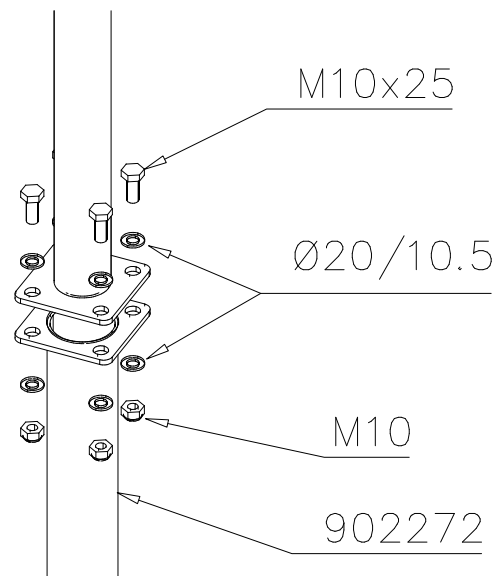

DET 1



DET 2



DET 3



DET 4



DET 5



DET 6

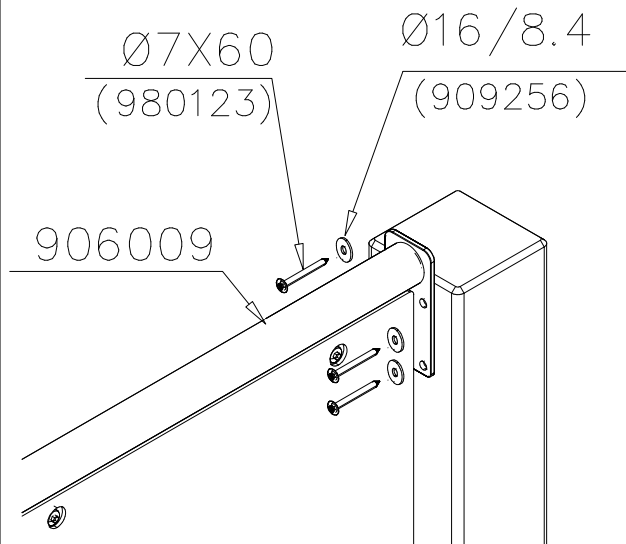





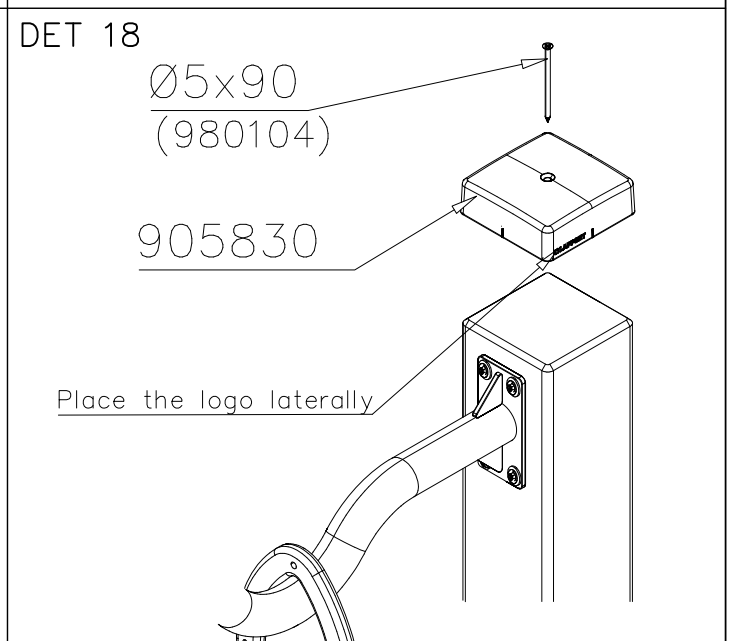
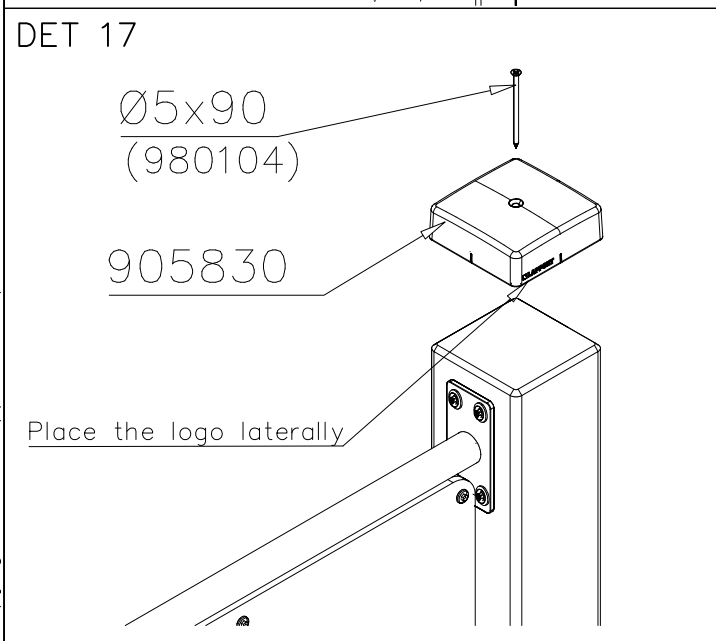
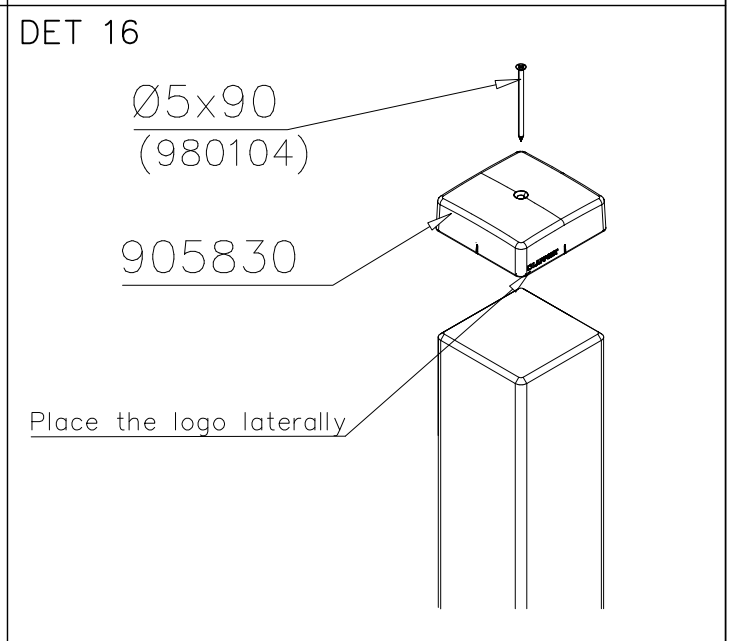
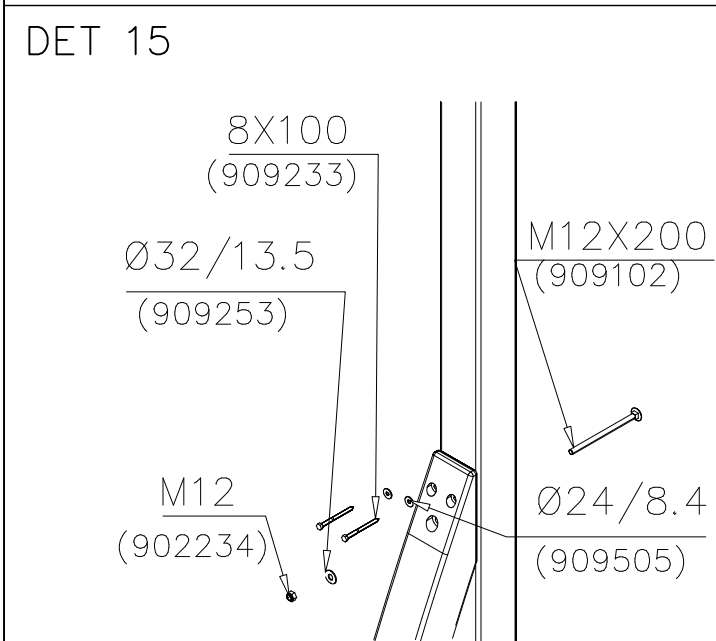
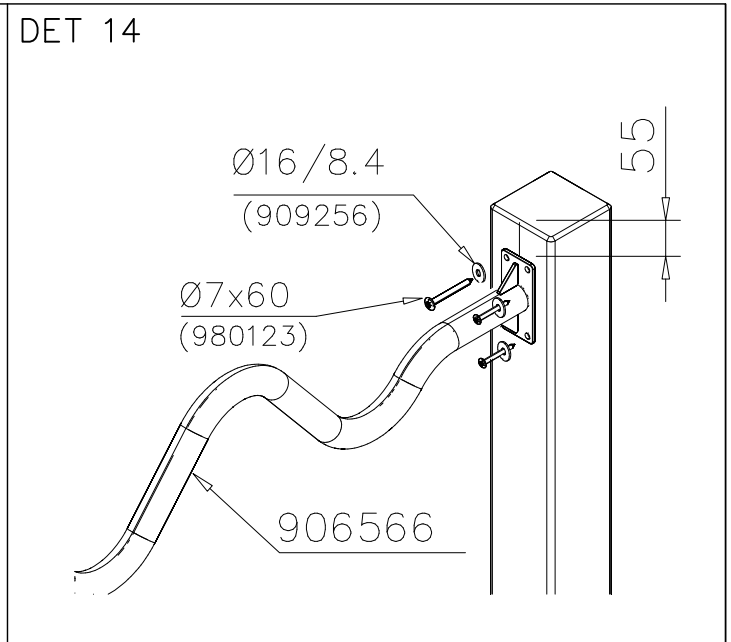
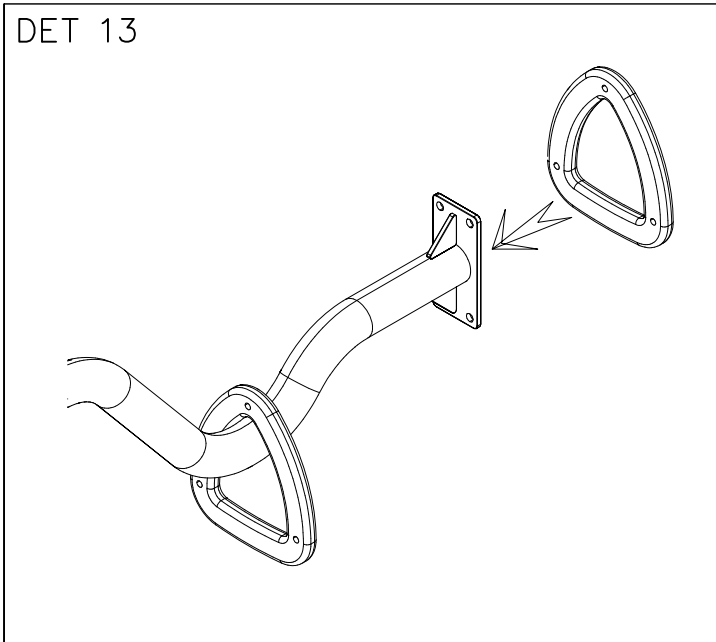

DET 19

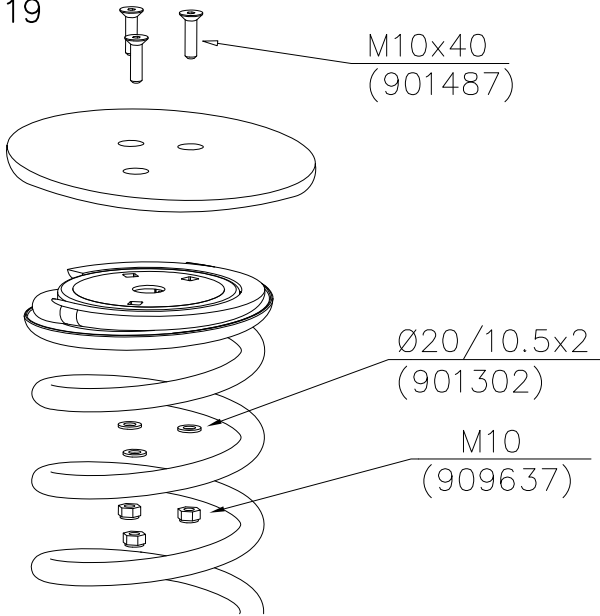

DET 20

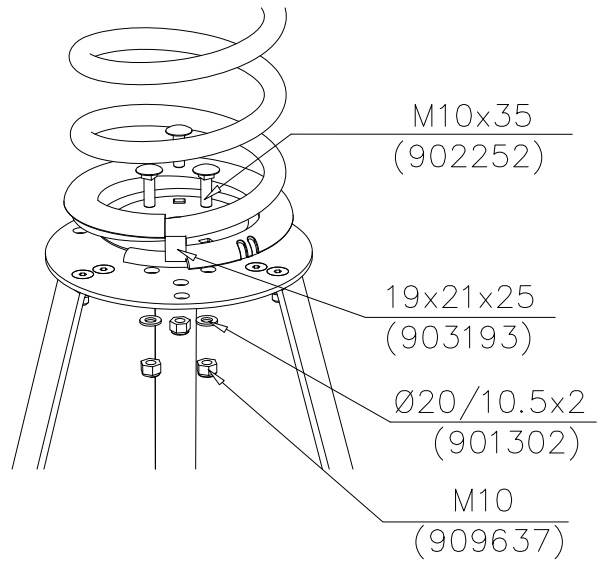

DET 21

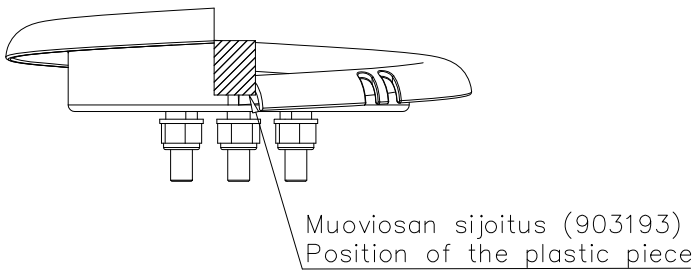

DET 22

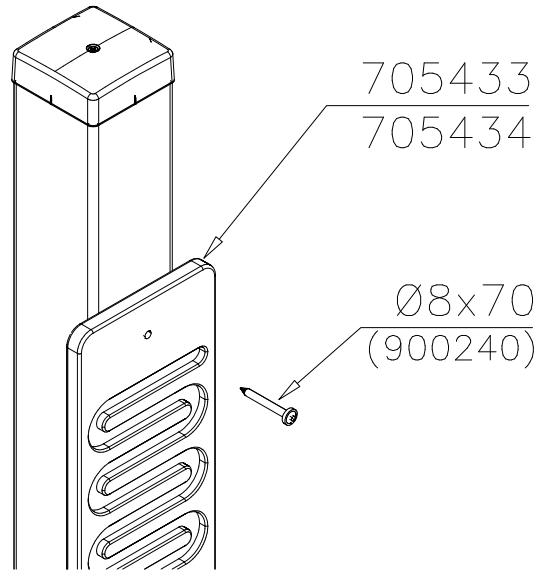

DET 23



DET 24

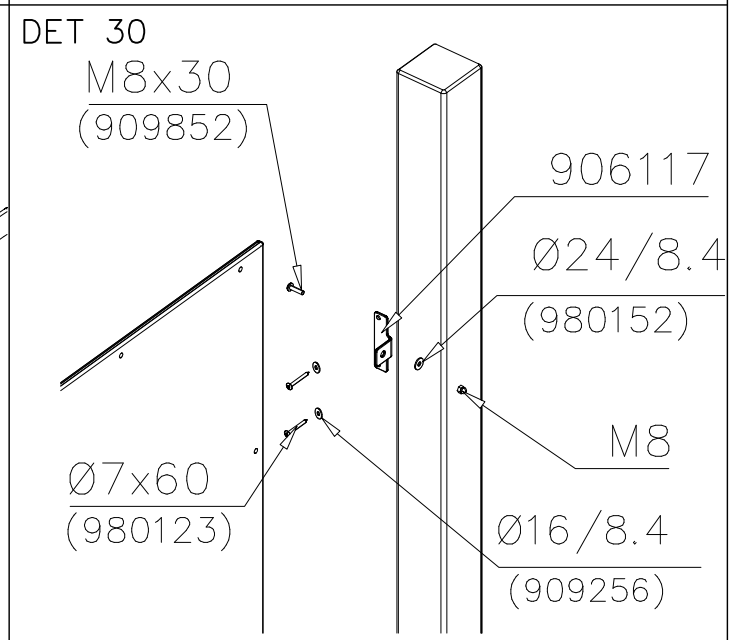
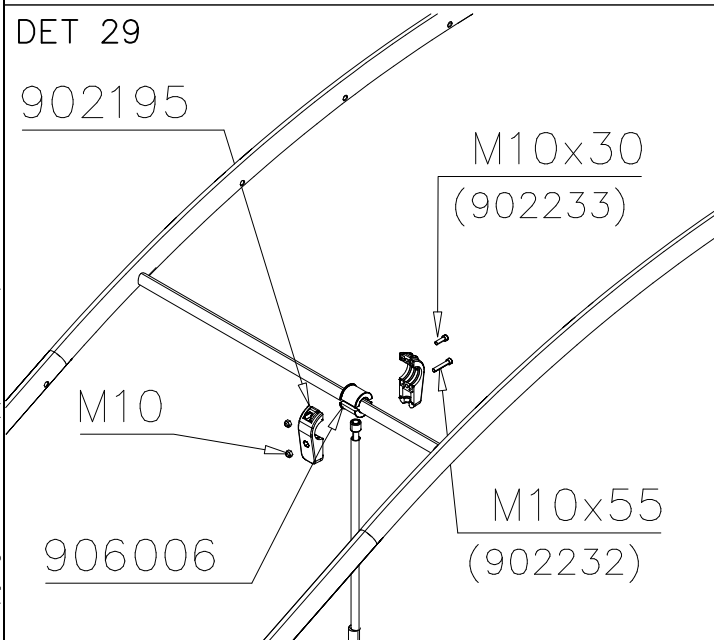
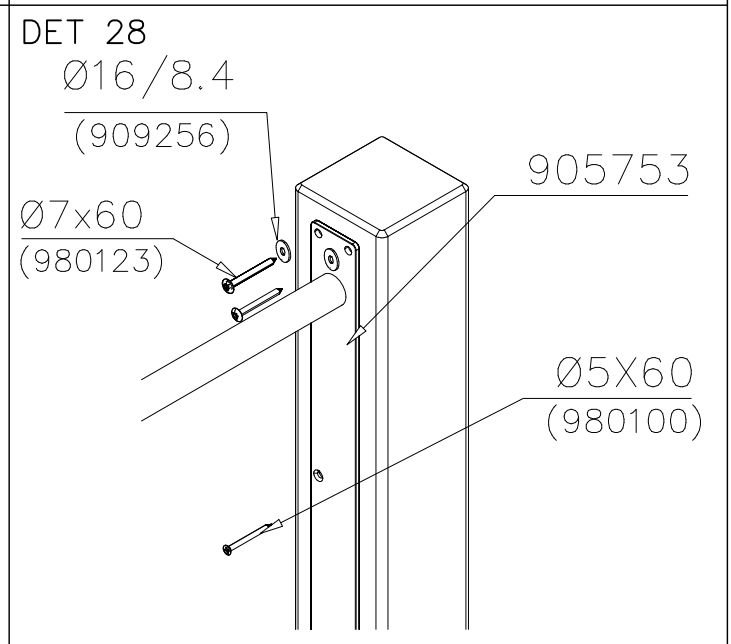
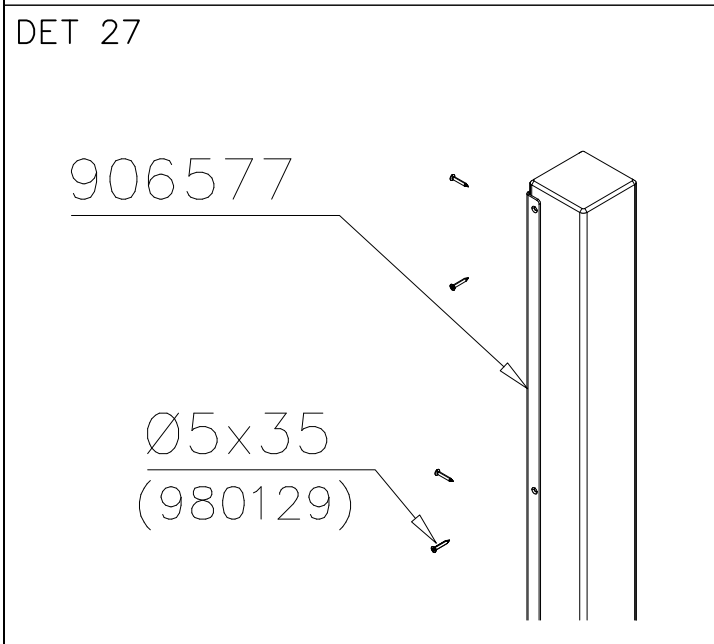
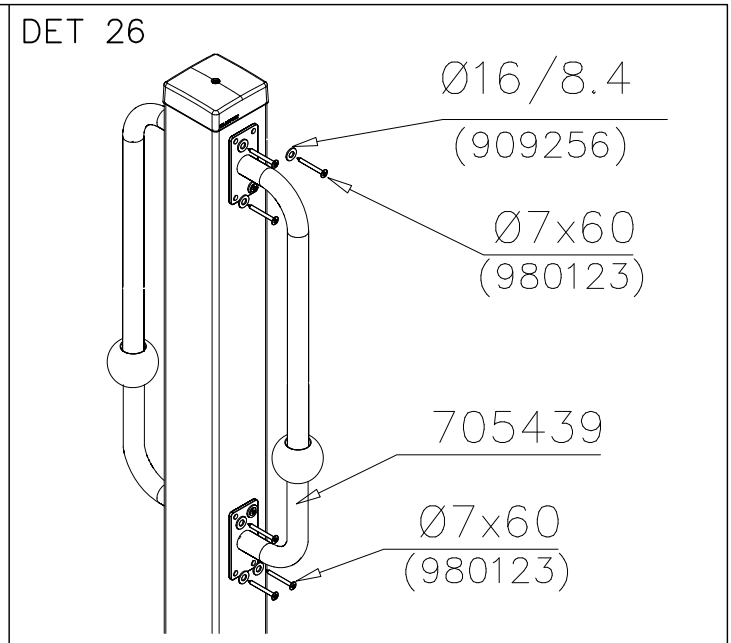
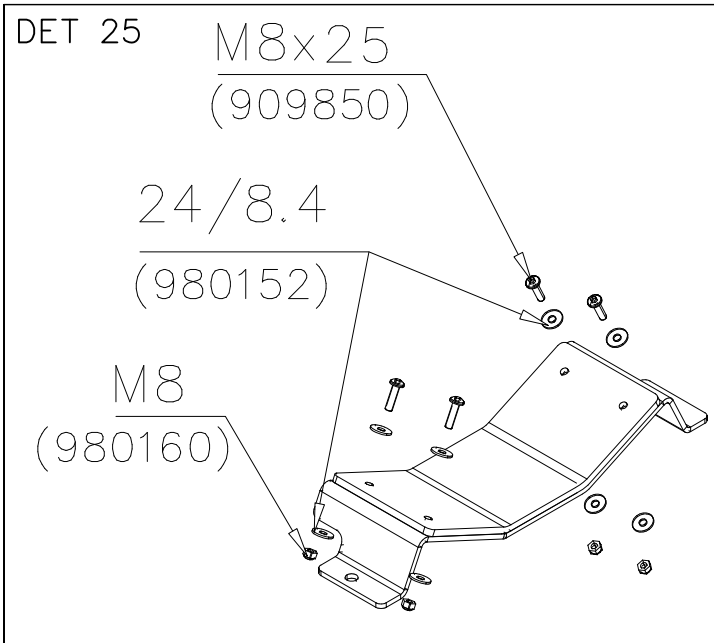

DET 31



DET 32

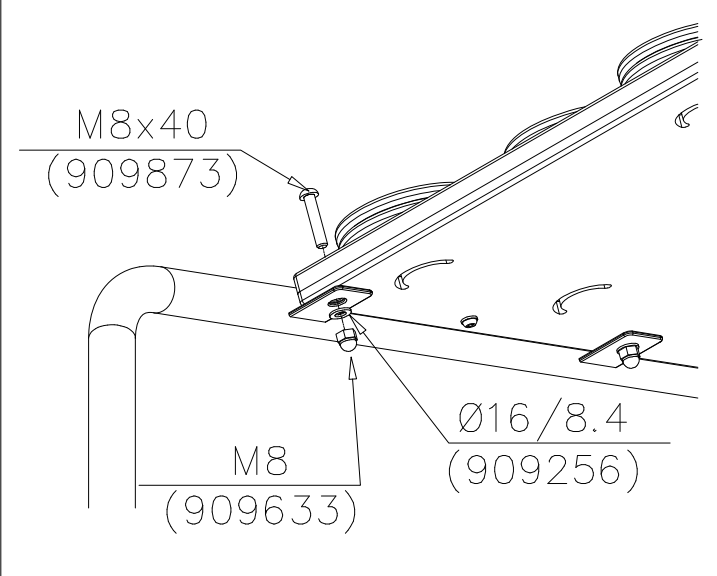

DET 33

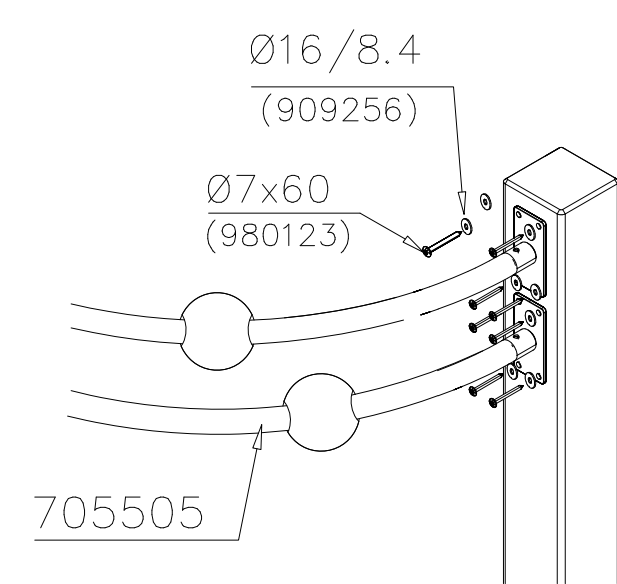

DET 34

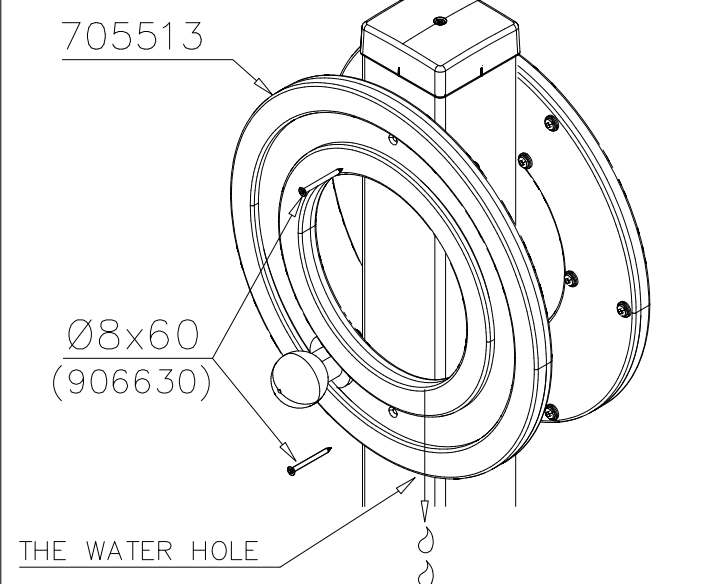

DET 35

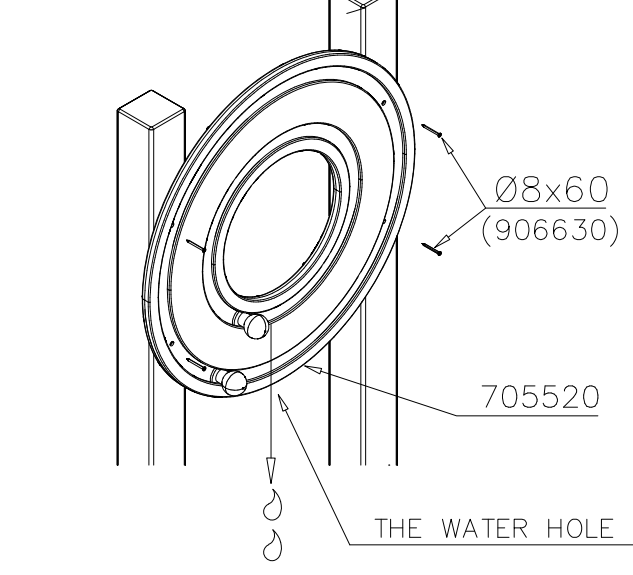

DET 36

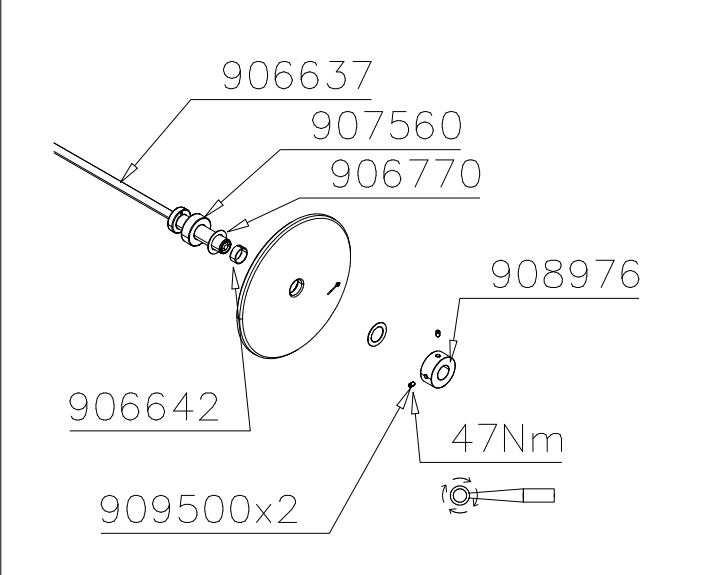

DET 37



DET 38



DET 39

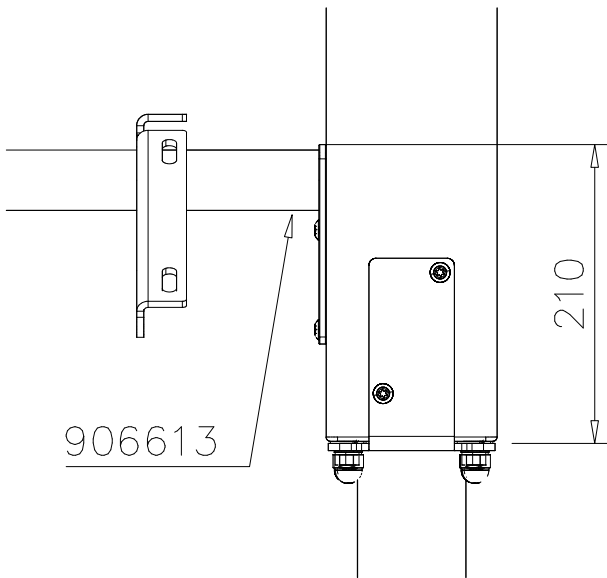

DET 40

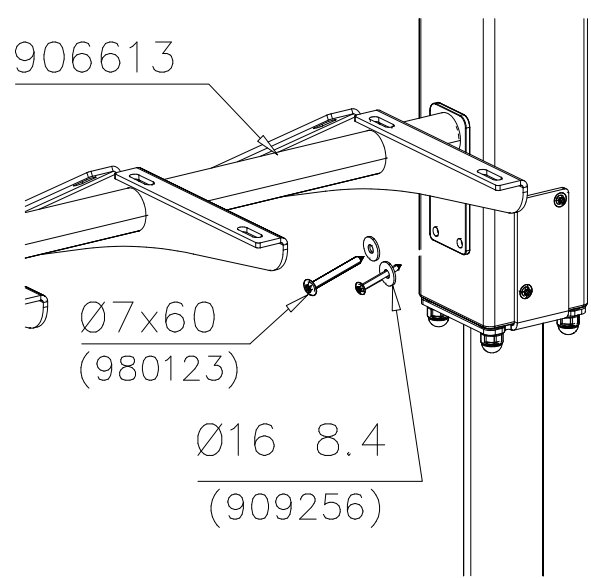

DET 41



DET 42

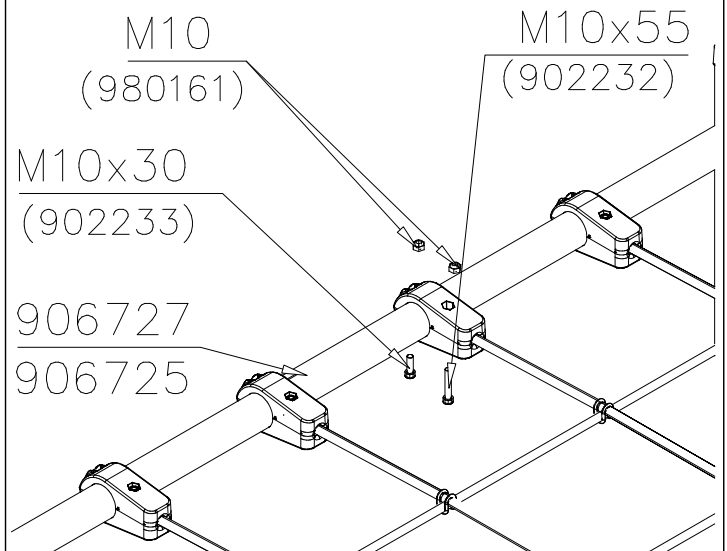

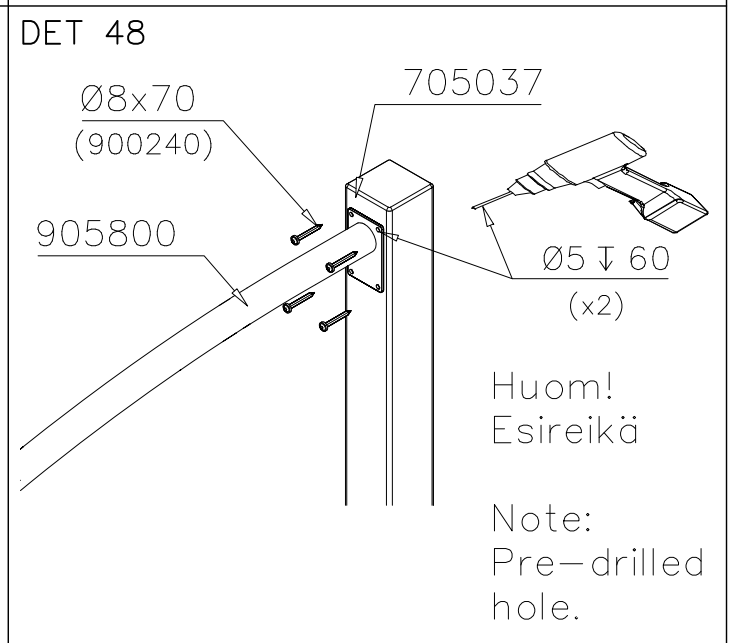
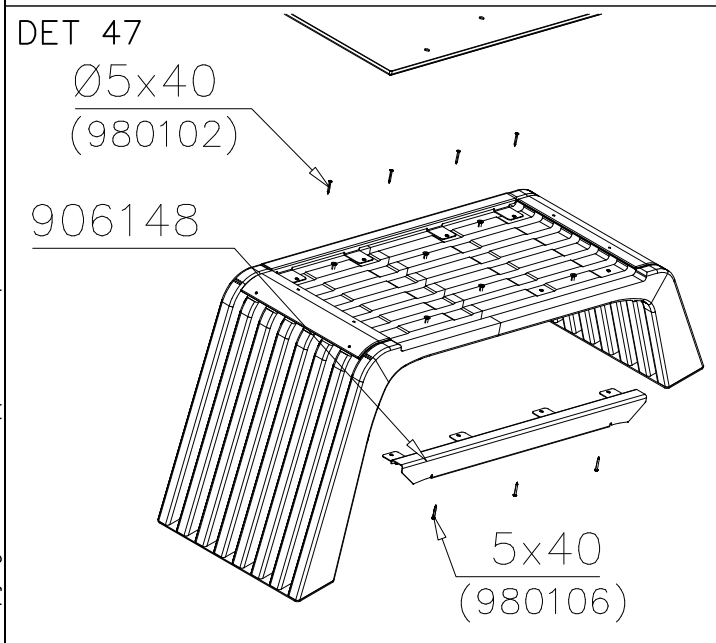

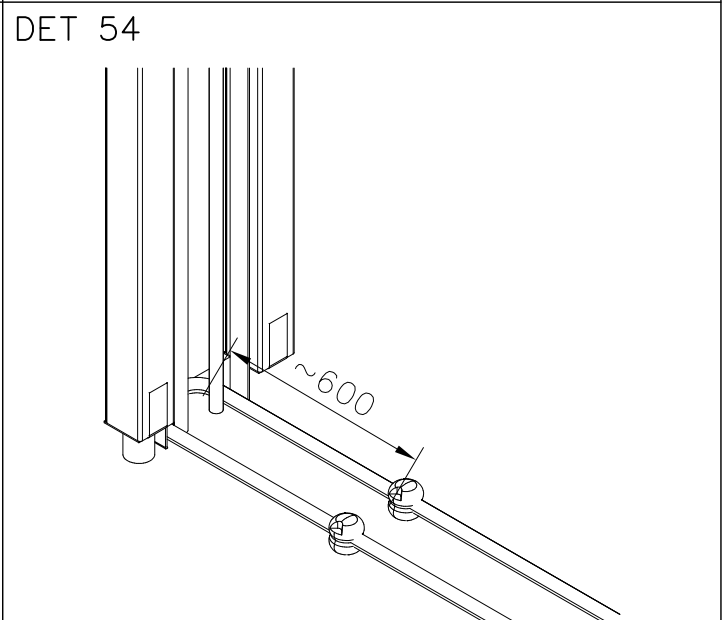
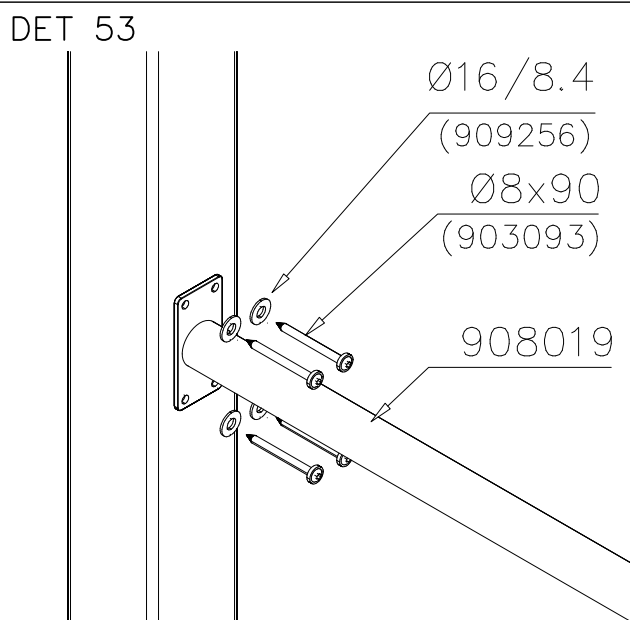
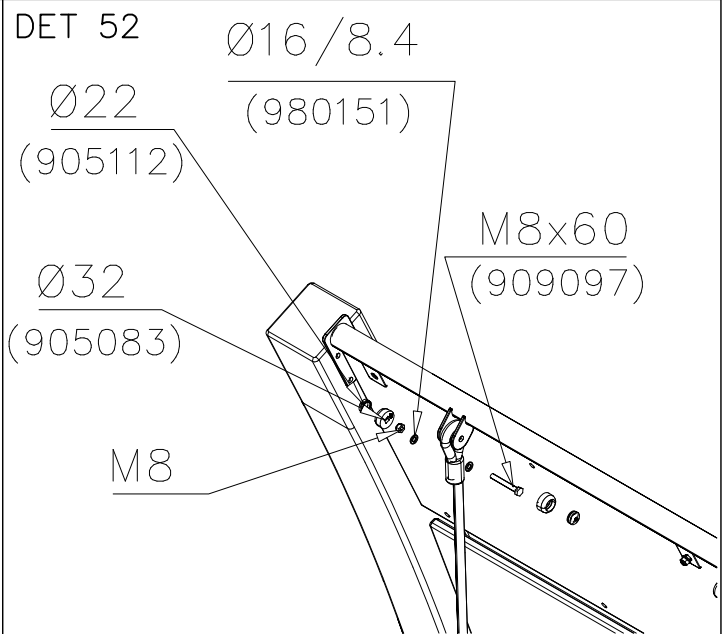
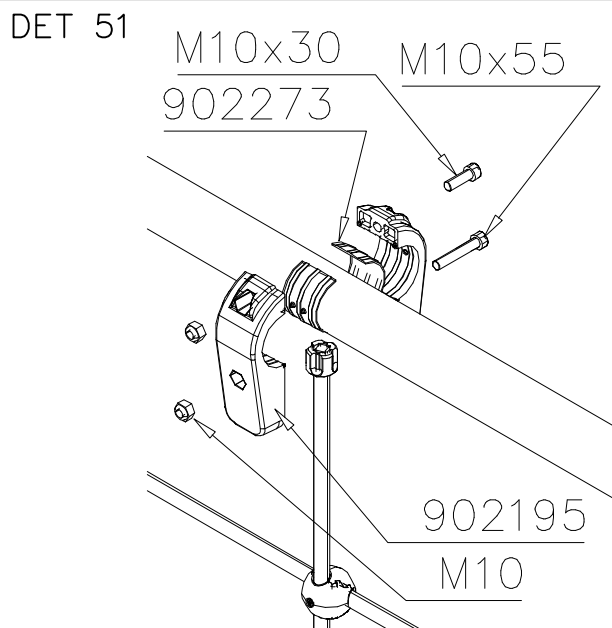
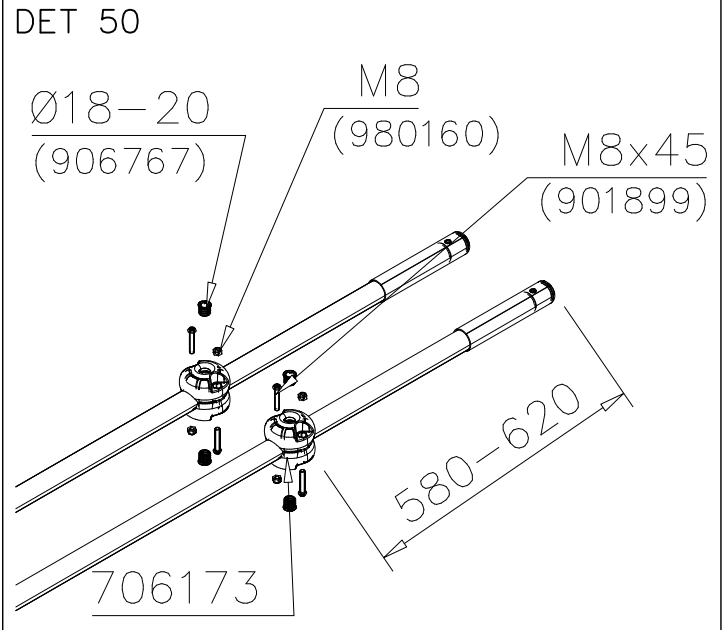
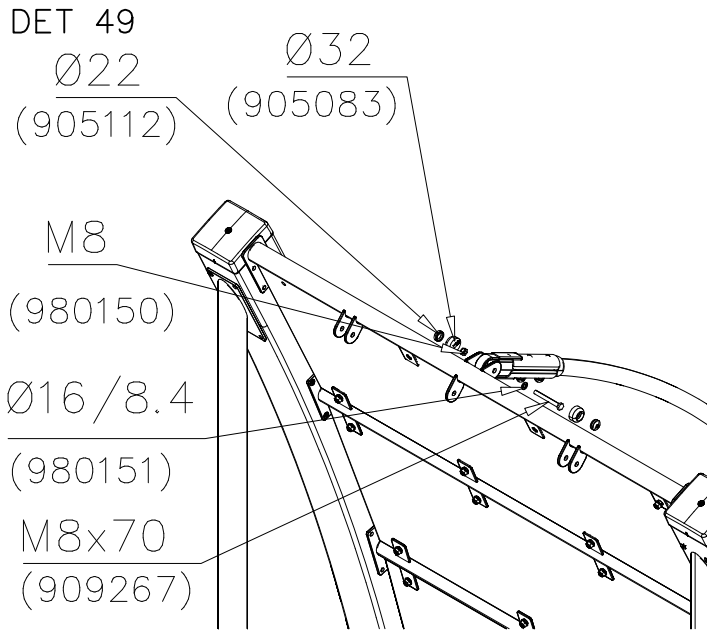

DET 55

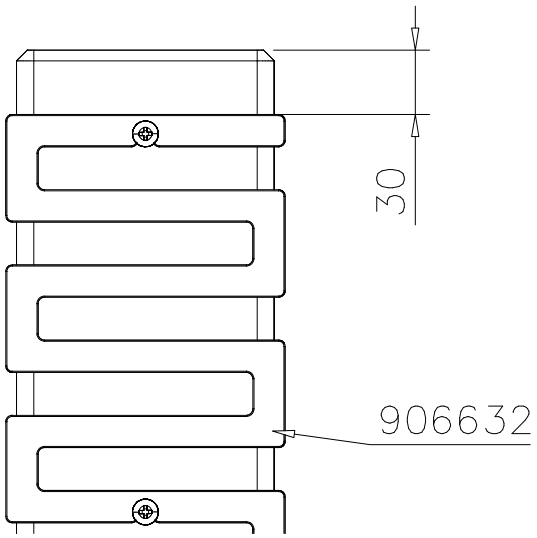

DET 56

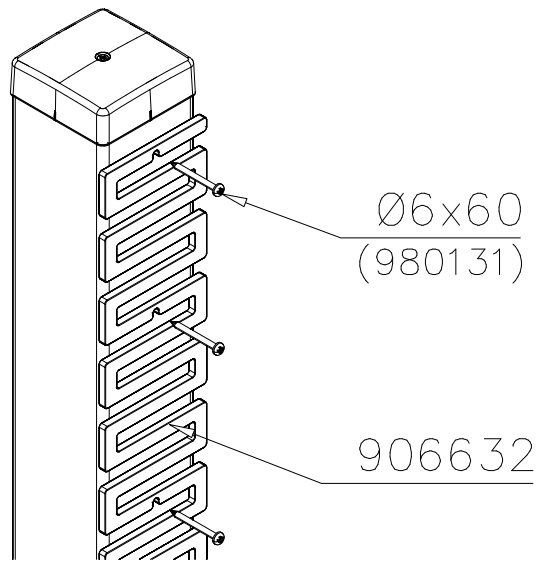

DET 57

DET 58

DET 59

DET 60



|   |     |   |     |
|---|-----|---|-----|
| ① SHEET METAL   | PCS | ② 980114  | PCS |
|  | 1   |  | 4   |
| 118x78x0.7  |     | Ø4x20   |     |

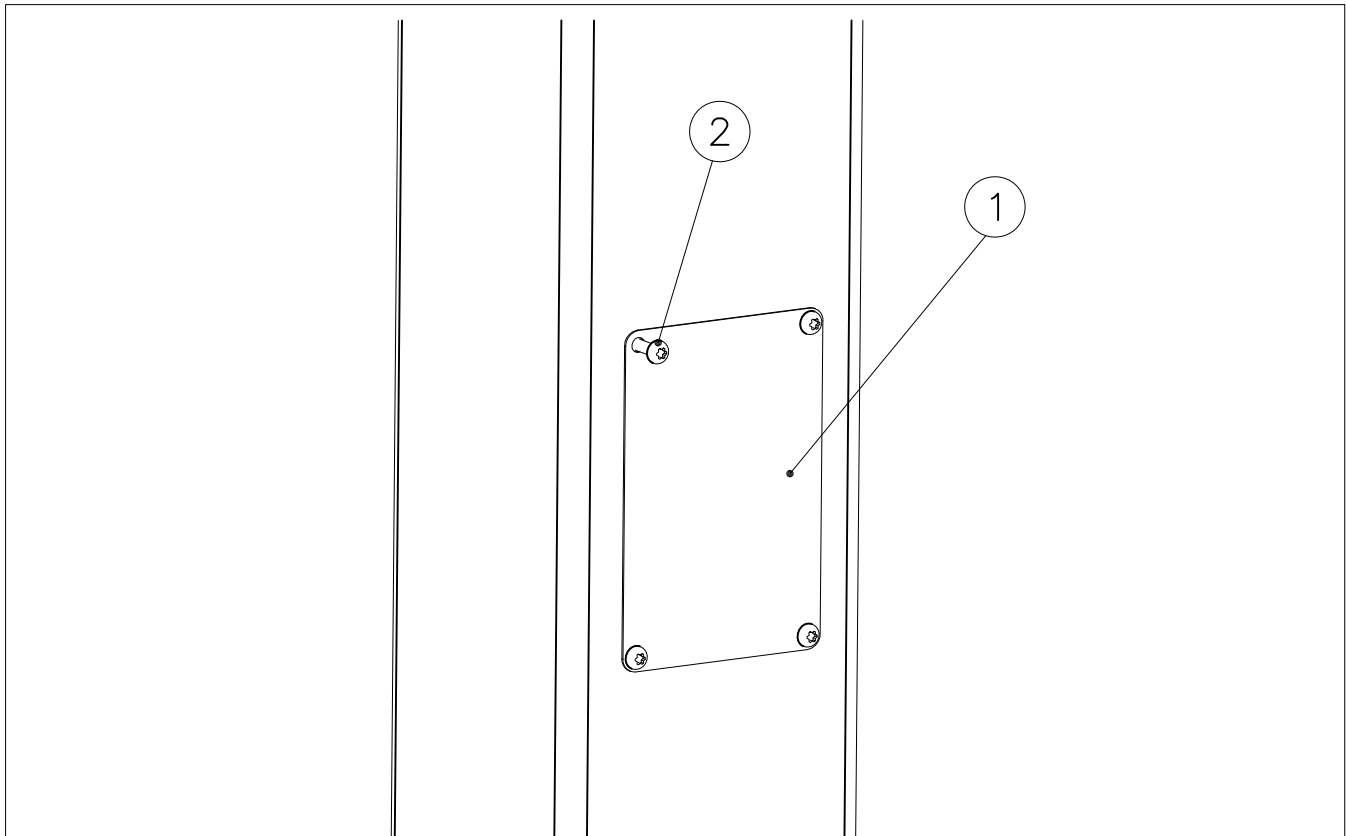

Example installation !  
Esimerkki asennus !

Example installation !  
Esimerkki asennus !

Example installation !  
Esimerkki asennus !



Example installation !  
Esimerkki asennus !

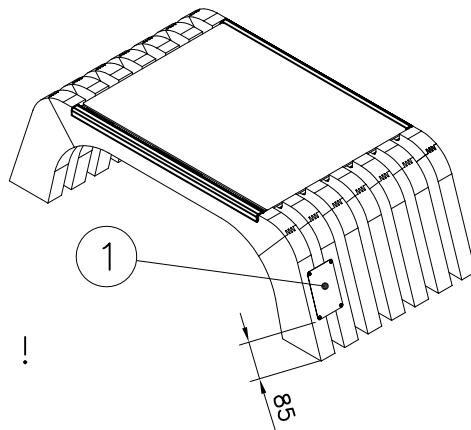
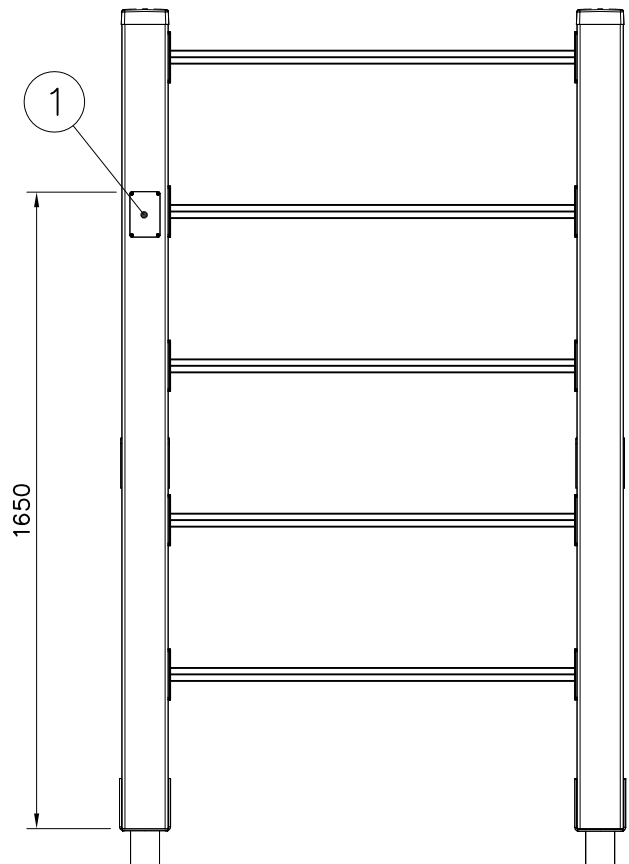

Example installation !  
Esimerkki asennus !