

①	705330	PCS	②	705460	PCS
		2			1
	120x120x870				
③	902272	PCS	④	905104	PCS
		2			8
	90x90x450			M10	
⑤	905761	PCS	⑥	905830	PCS
		2			2
	120x120x700			123x123x40	
⑦	909519	PCS	⑧	909629	PCS
		2			8
	50x380x380			M10x30	
⑨	909637	PCS	⑩	909638	PCS
		16			32
	M10			Ø20/10.5	
⑪	909639	PCS	⑫	980104	PCS
		8			2
	M10x25			Ø5x90	
⑬	906644	PCS	⑭	906645	PCS
		1			1
	LEFT			RIGHT	
⑮	980123	PCS	⑯	909873	PCS
		16			6
	Ø7x60			M8x40	
⑰	706055	PCS	⑱	980114	PCS
		1			4
				Ø4x20	
⑲	909256	PCS	⑳	909633	PCS
		22			6
	Ø16/8.4			M8	

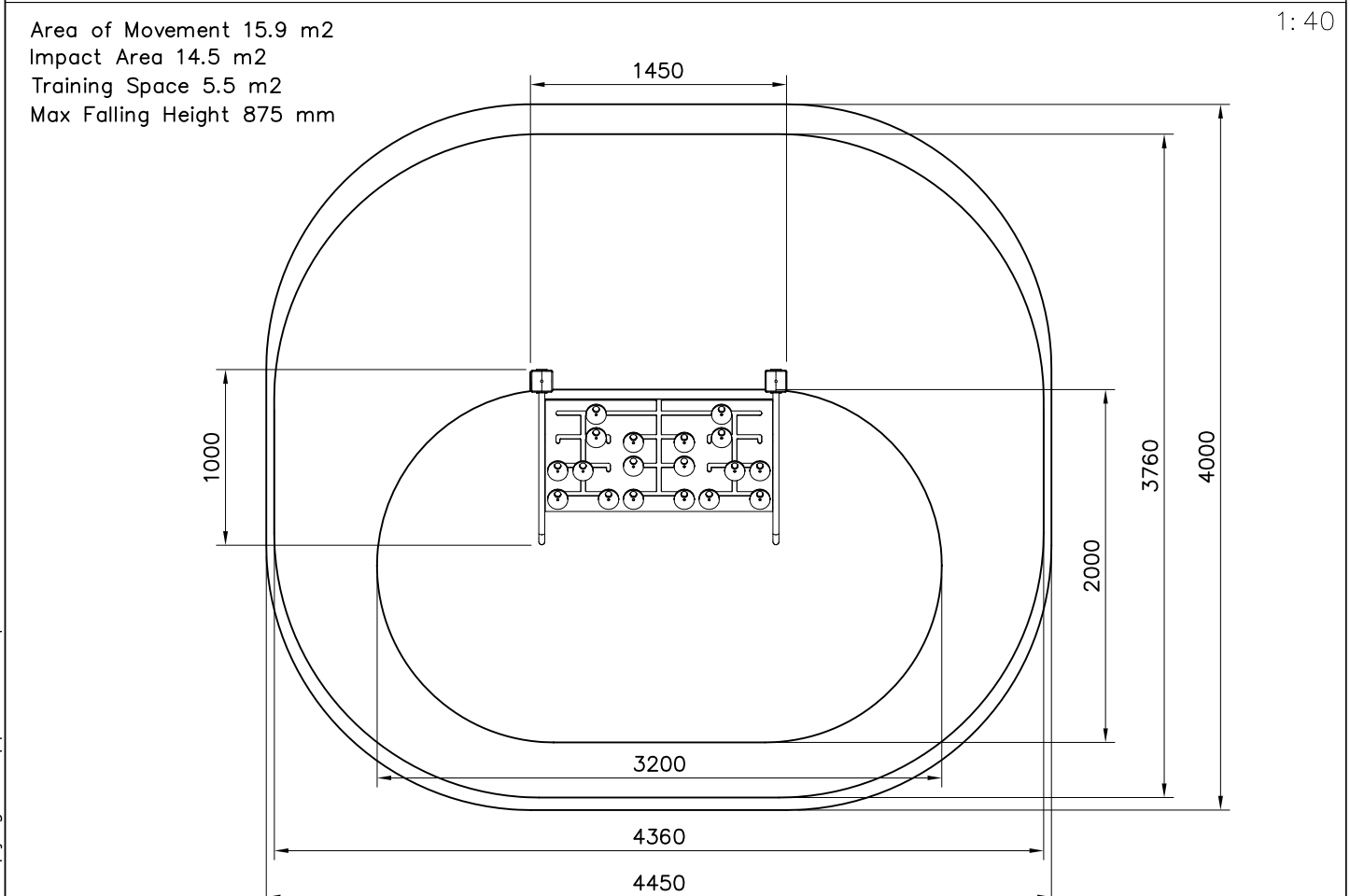

Game options:		Bars left options:			
<p>1290x670</p>	705460-701	ACTIVE		906644-215	Turquoise
	705460-702	JOY		906644-216	Pearl Light Gray
	705460-703	SLOW		906644-217	Lime
	705460-704	SOLID		906644-218	Pink

Bars right options:		1: 25
	906645-215	Turquoise
	906645-216	Pearl Light Gray
	906645-217	Lime
	906645-218	Pink

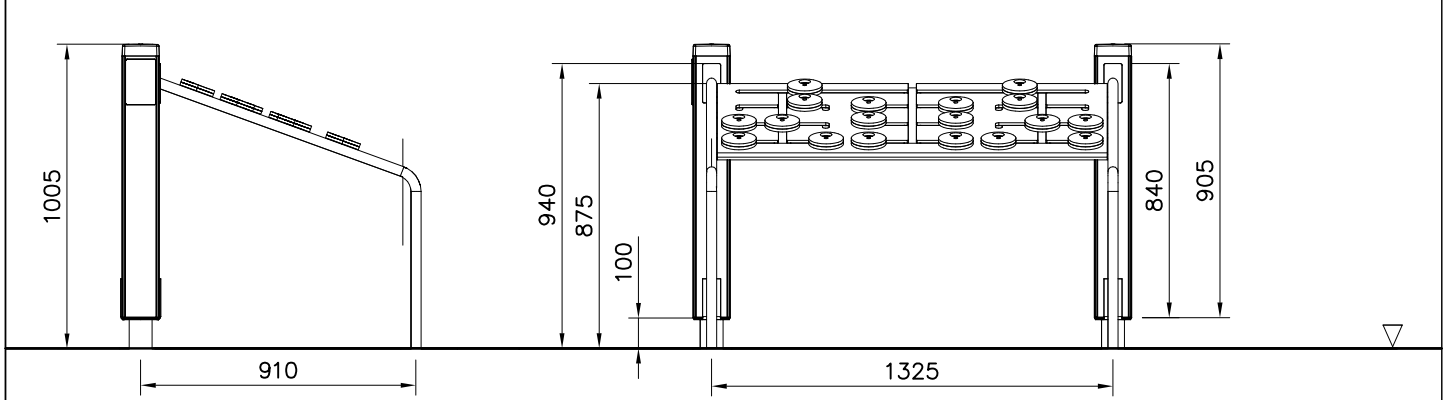

												
<p>$h < 600$</p> <p>Without movement and therefore without Impact Area</p>	<p>Totally hard surfaces.</p> <p>Note. Lappset does <u>not recommend</u> totally hard surfaces at all.</p>	<p>E.g. concrete or asphalt</p> 										
<p>$h < 600$</p> <p>With movement e.g. rocking</p>	<p>Materials with very limited impact attenuating properties.</p>	<p>E.g. wood</p> 										
<p>$h < 1000$</p>	<p>Materials with significant impact attenuating properties.</p>	<p>fine gravel 0–8 mm</p>  <p>grass</p>  <p>unsorted sand</p> 										
<p>$h < 3000$</p>	<p>Loose fill material</p> <p>E.g. sand/gravel 0,25...8 mm D60/D10<3,0 Woodchips 5...30 mm bark 20...80 mm</p>	 <table data-bbox="1024 1691 1332 1792"> <tr> <td>\underline{S}</td> <td>\underline{h}</td> </tr> <tr> <td>30 cm</td> <td>< 2,0 m</td> </tr> <tr> <td>40 cm</td> <td>< 3,0 m</td> </tr> </table>	\underline{S}	\underline{h}	30 cm	< 2,0 m	40 cm	< 3,0 m				
\underline{S}	\underline{h}											
30 cm	< 2,0 m											
40 cm	< 3,0 m											
	<p>Syntethic granulates</p> <table data-bbox="406 1892 758 2060"> <tr> <td>\underline{S}</td> <td>\underline{h}</td> </tr> <tr> <td>40 mm</td> <td>~> 1,2...1,3 m</td> </tr> <tr> <td>50 mm</td> <td>~> 1,5...1,7 m</td> </tr> <tr> <td>60 mm</td> <td>~> 1,8...2,0 m</td> </tr> <tr> <td>70 mm</td> <td>~> 2,1...2,5 m</td> </tr> </table> <p>Note. For accurate values, see manufacturer's instructions.</p>	\underline{S}	\underline{h}	40 mm	~> 1,2...1,3 m	50 mm	~> 1,5...1,7 m	60 mm	~> 1,8...2,0 m	70 mm	~> 2,1...2,5 m	
\underline{S}	\underline{h}											
40 mm	~> 1,2...1,3 m											
50 mm	~> 1,5...1,7 m											
60 mm	~> 1,8...2,0 m											
70 mm	~> 2,1...2,5 m											

REMOVE SAFETY SURFACE/SAND/GRAVEL
TO CHECK FOUNDATION



REMOVE SAFETY SURFACE/SAND/GRAVEL
TO CHECK FOUNDATION



DET 1

$\varnothing 16 \downarrow > 130$

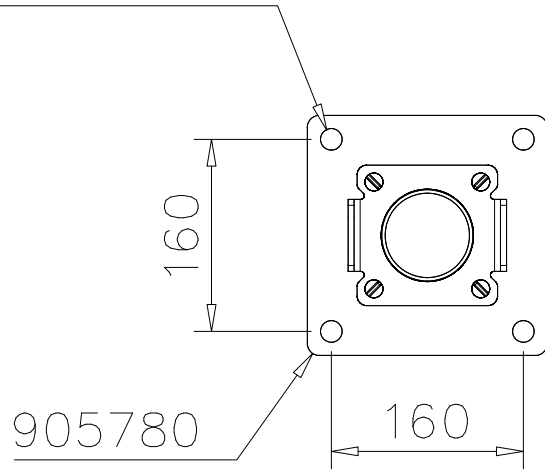

DET 2



DET 3



DET 4



DET 5

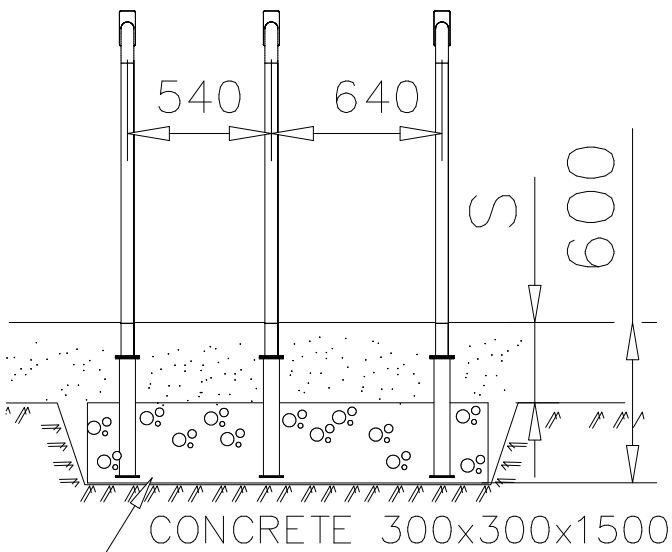

DET 6

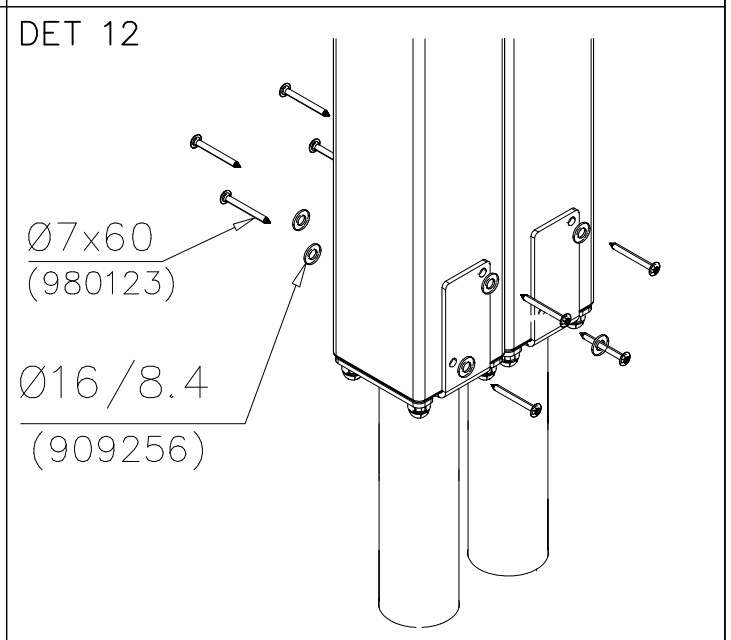
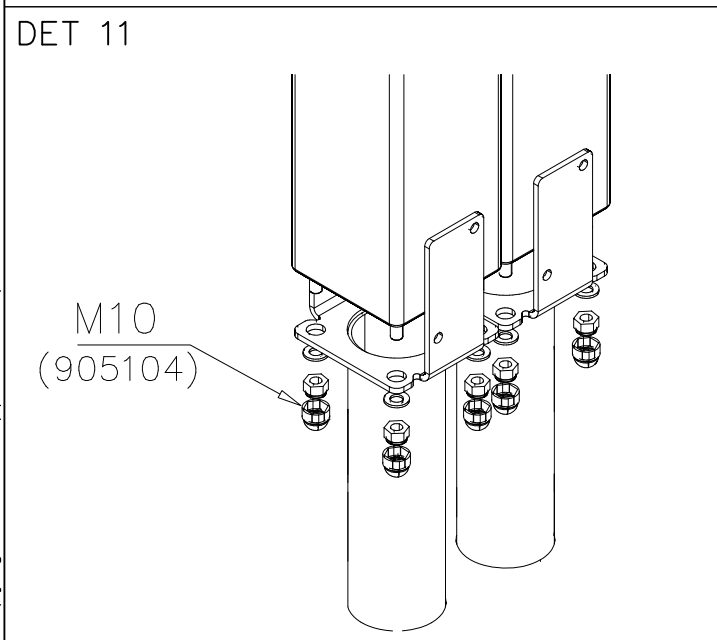
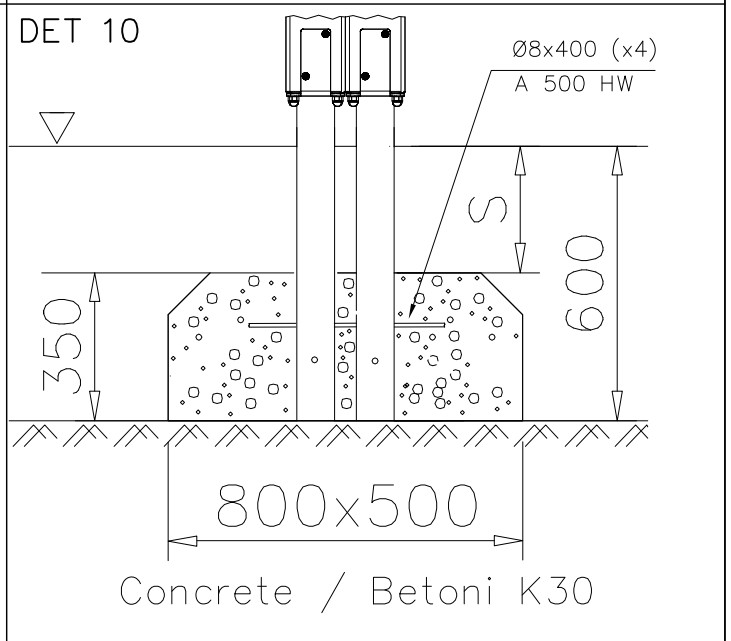
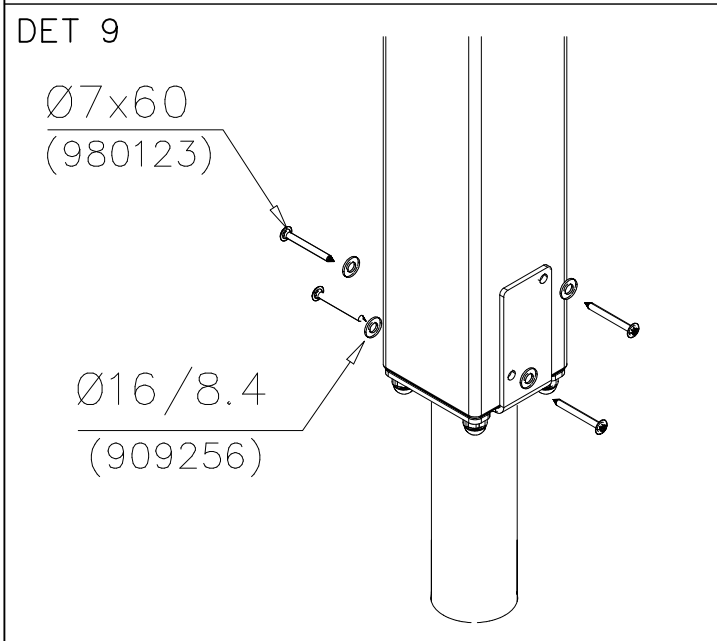
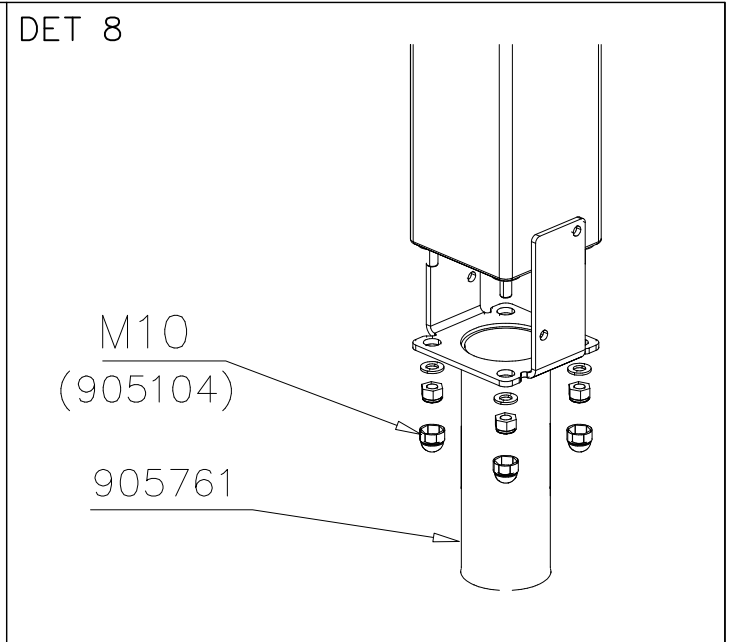
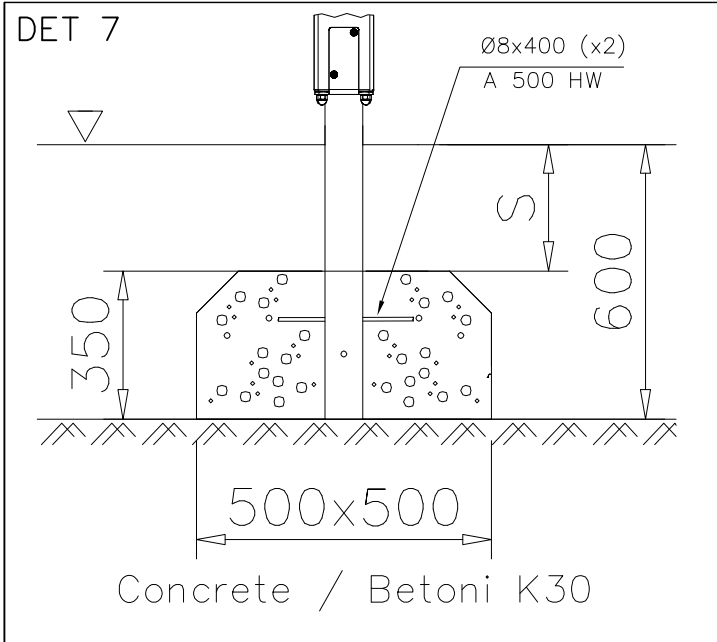

DET 13



DET 14



DET 15



DET 16

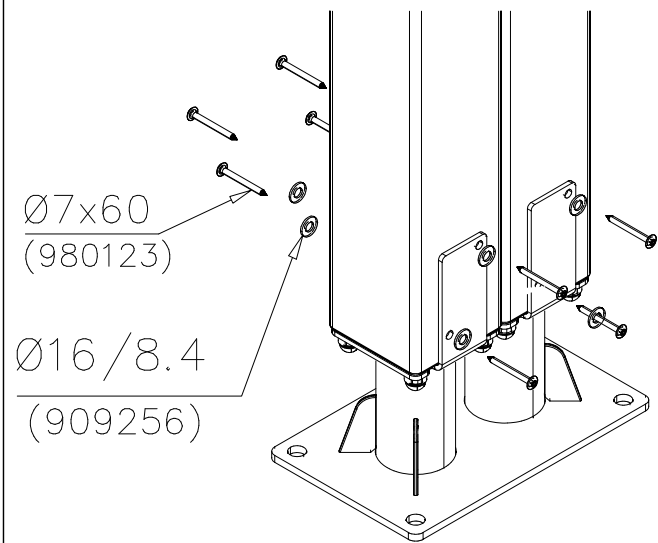

DET 17

DET 18

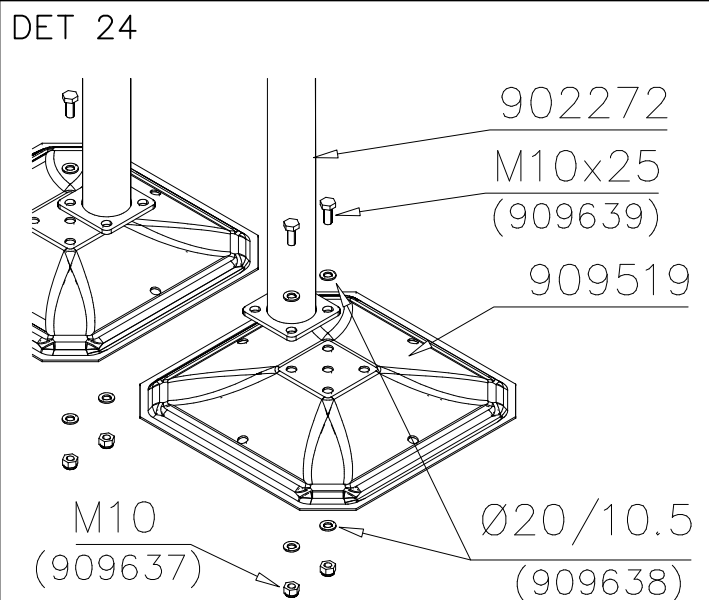
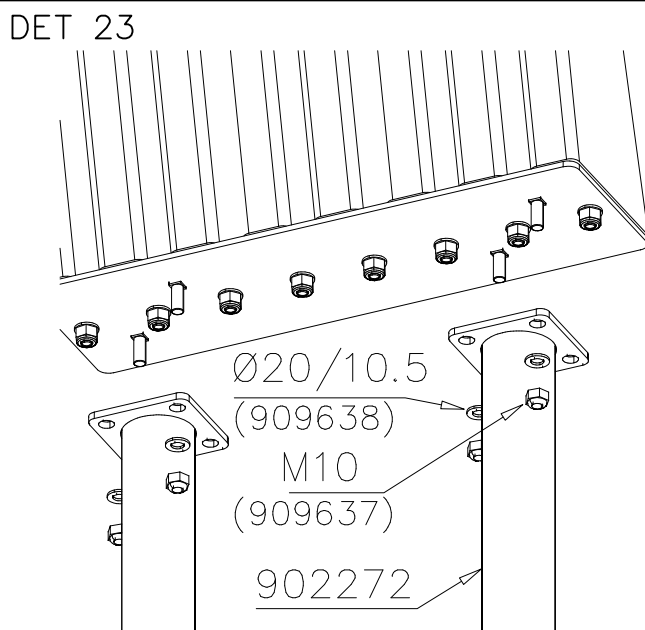
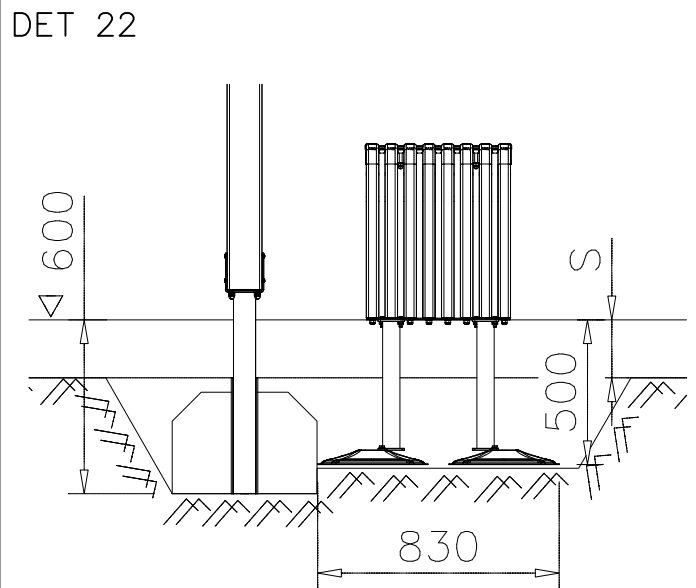
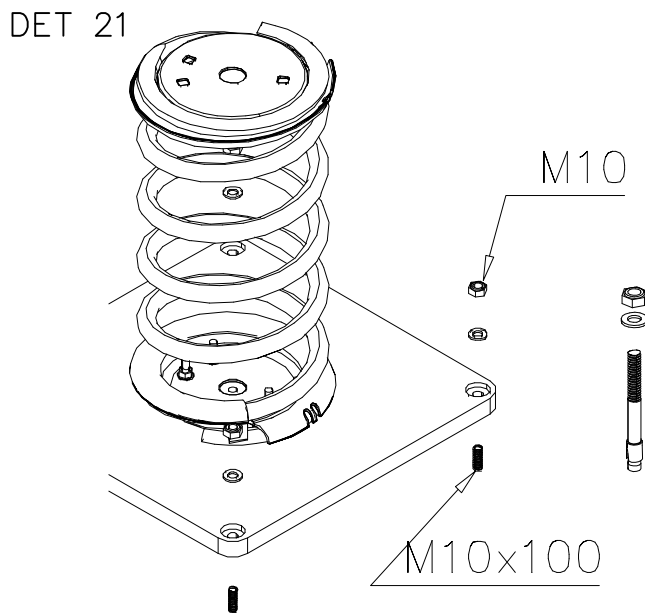
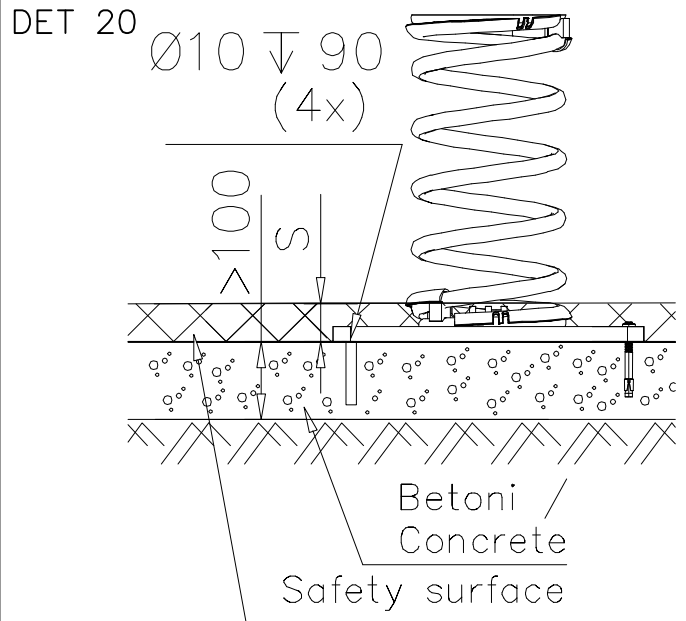
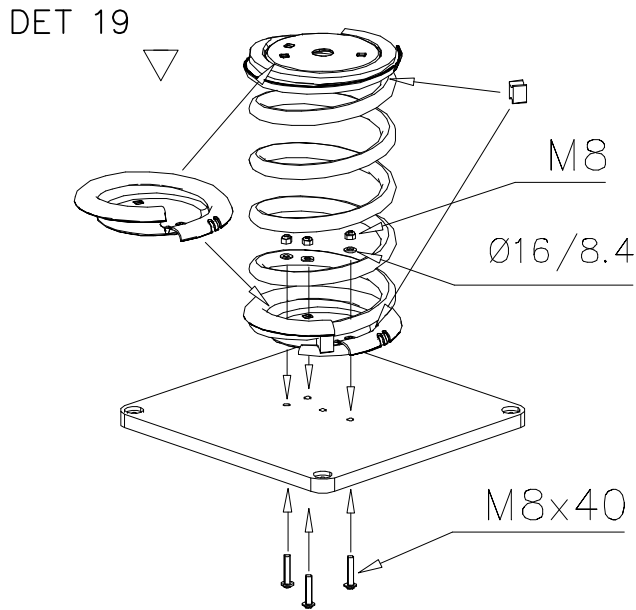

LAPPSET SPORT

BASE

DATE: 29.4.2015

5(10)



DET 31



DET 32

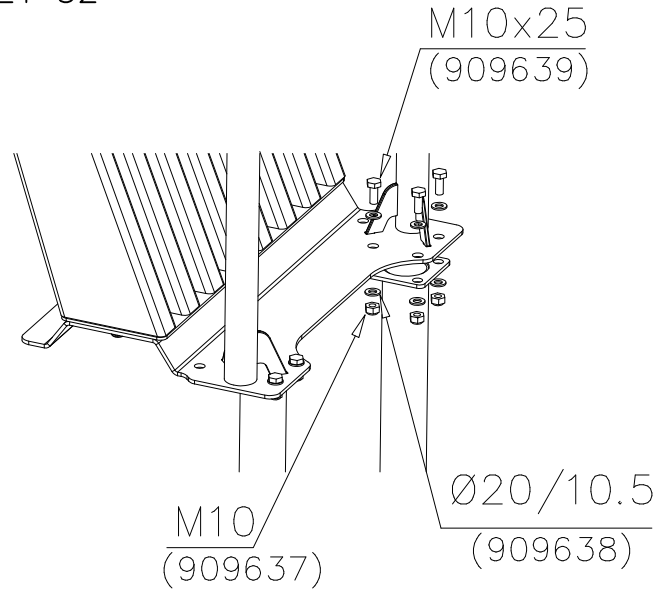

DET 33

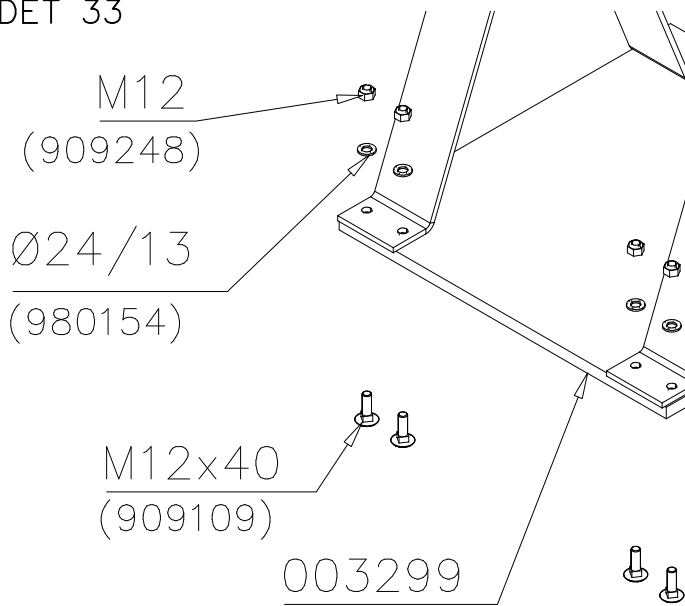

DET 34

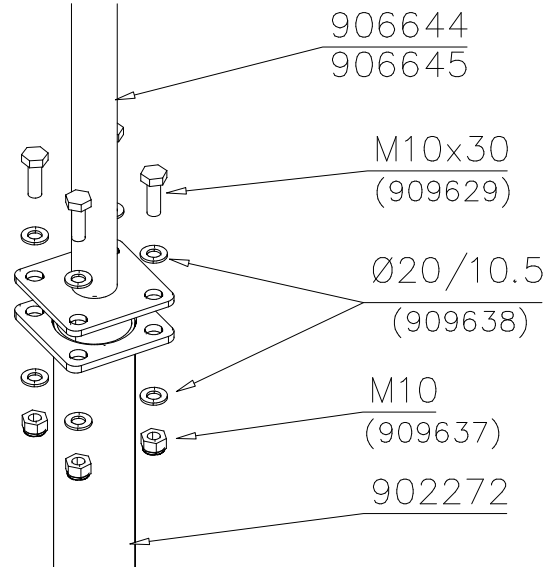

DET 35



DET 36



DET 37



DET 38



DET 39



DET 40



DET 41



DET 42

LAPPSET SPORT

BASE

DATE: 15.8.2017

8(10)

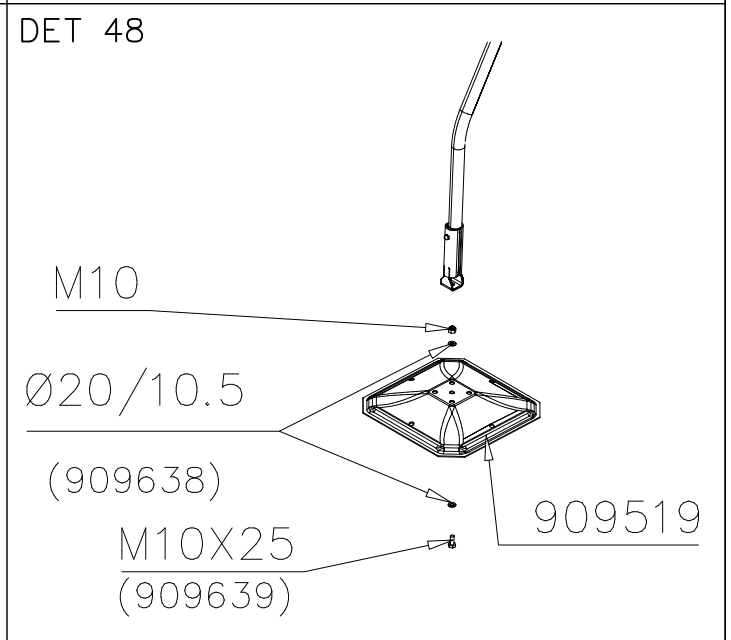
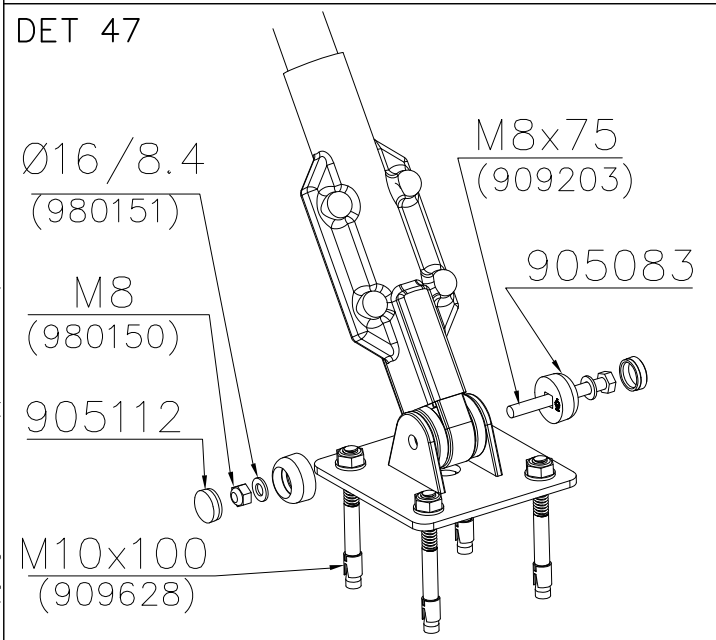
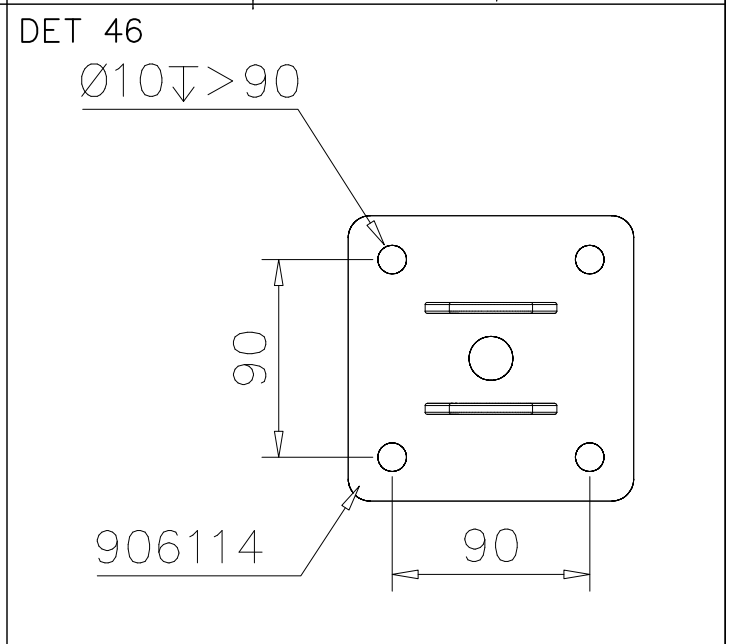
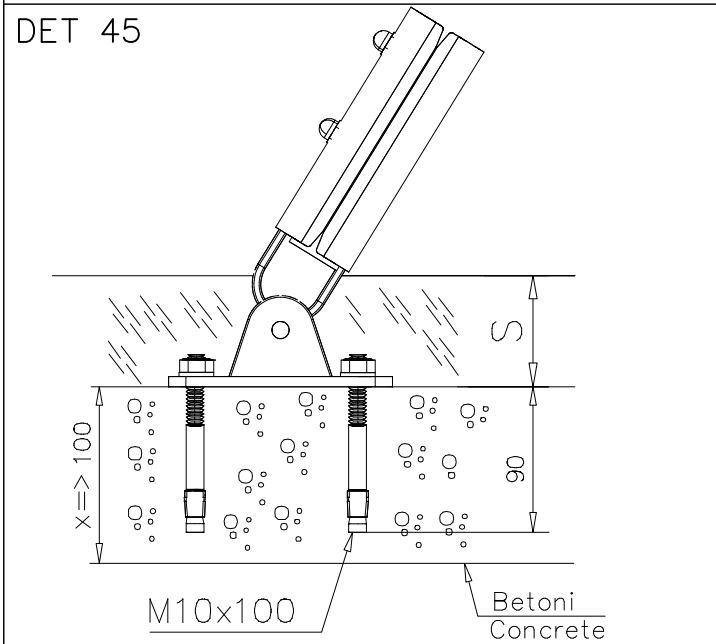
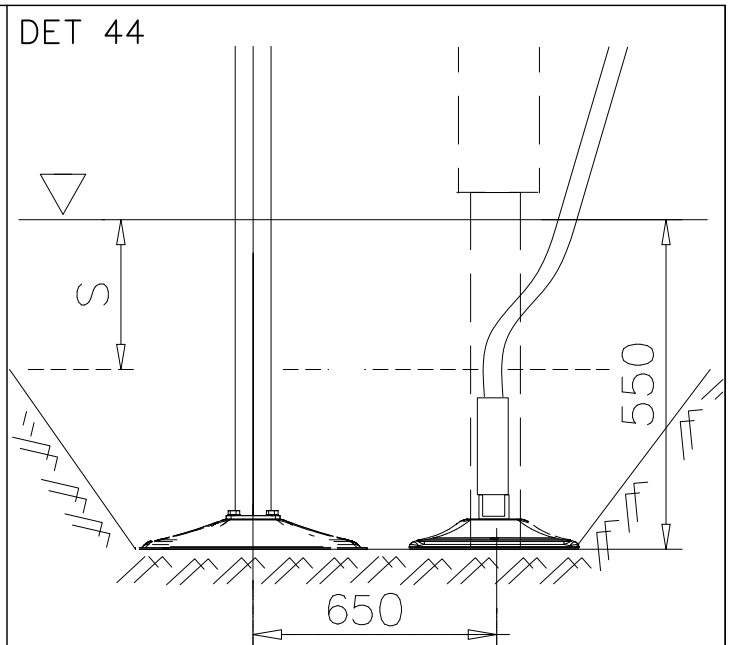
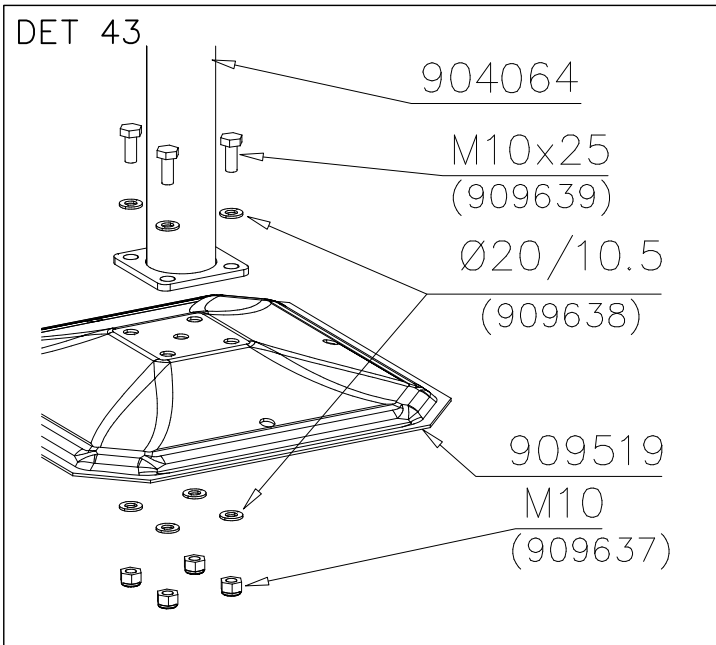

DET 49

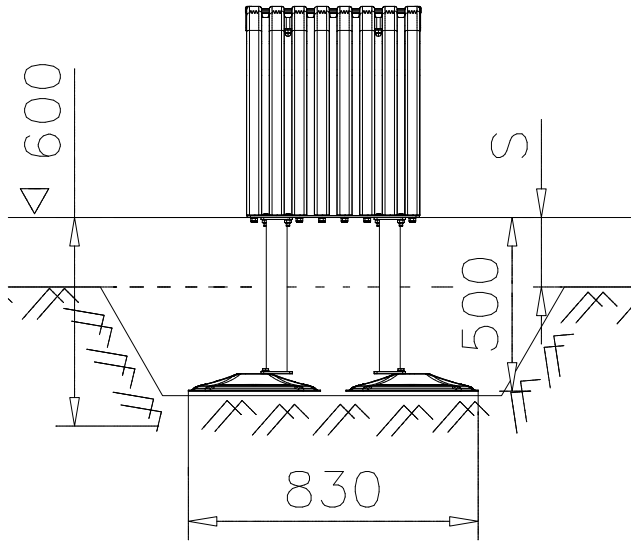

DET 50



DET 51

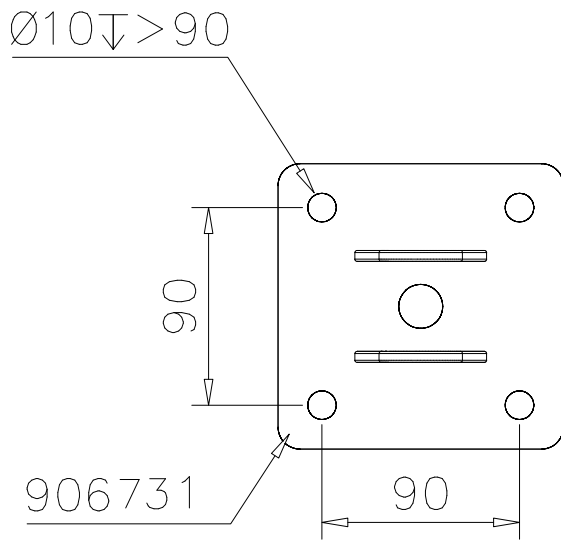

DET 52

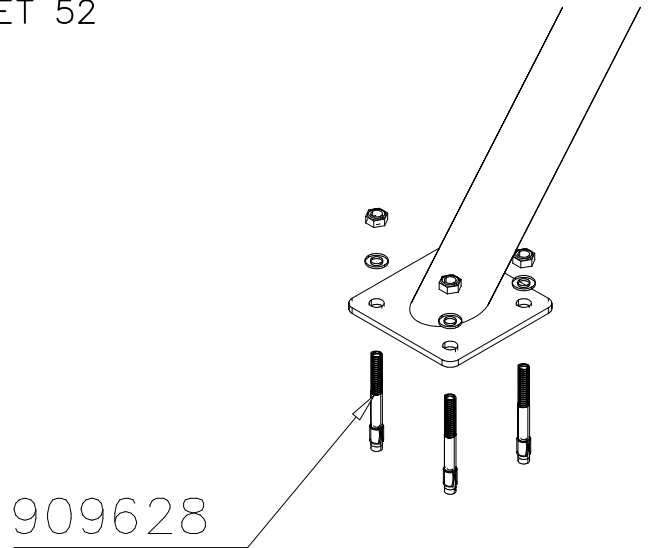

DET 53

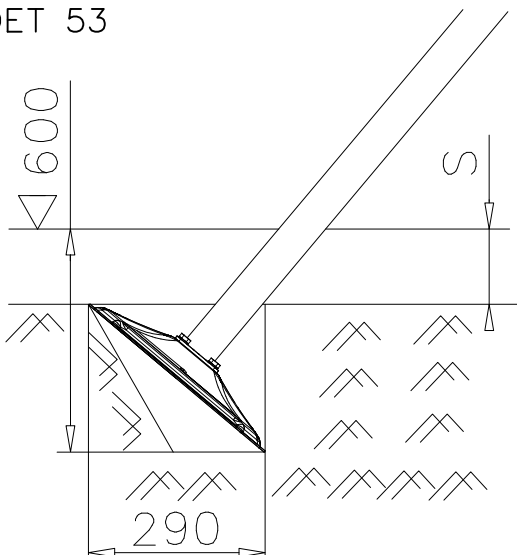

DET 54



DET 55

STEELNET Ø6 #150
(1400x2100)
Concrete
1500X2200X200 K30

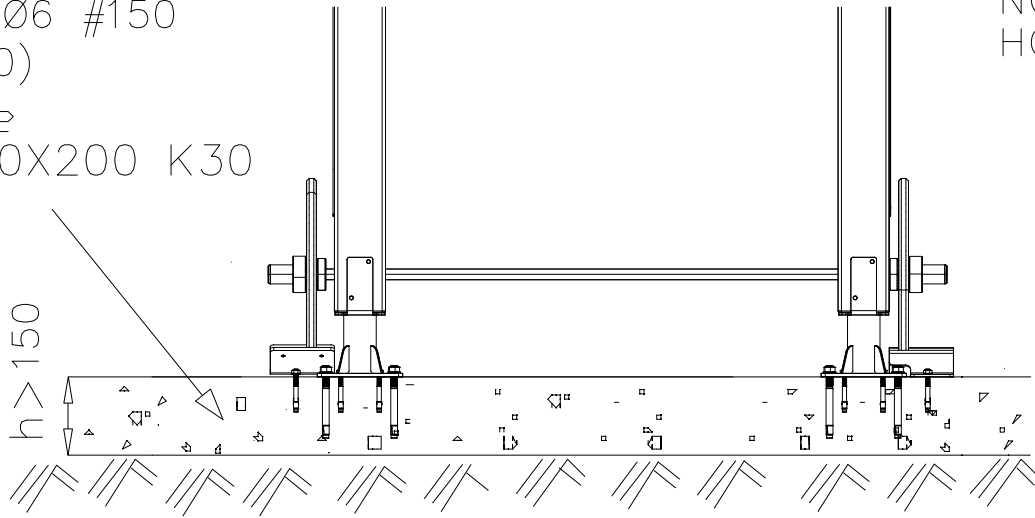

NOTE!
HOX!

DET 56

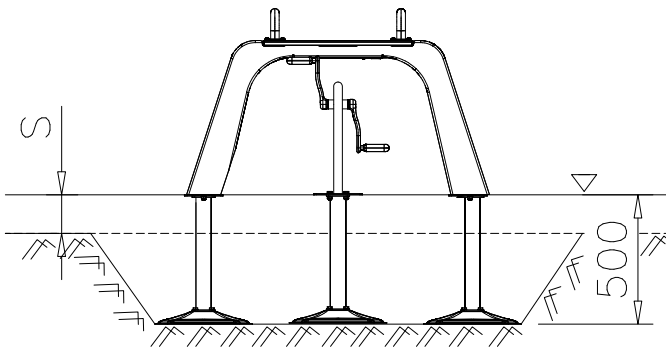

DET 57

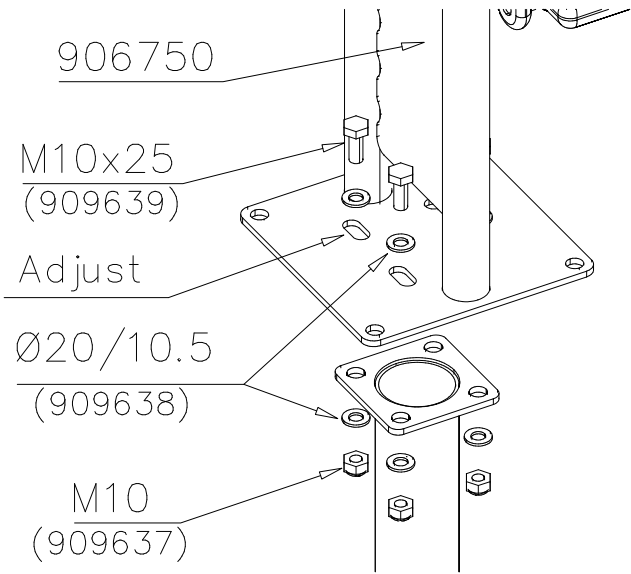

DET 58

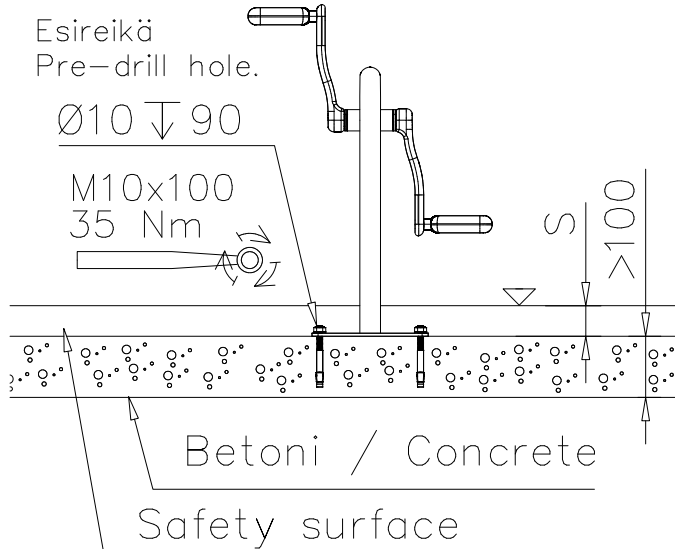

DET 59

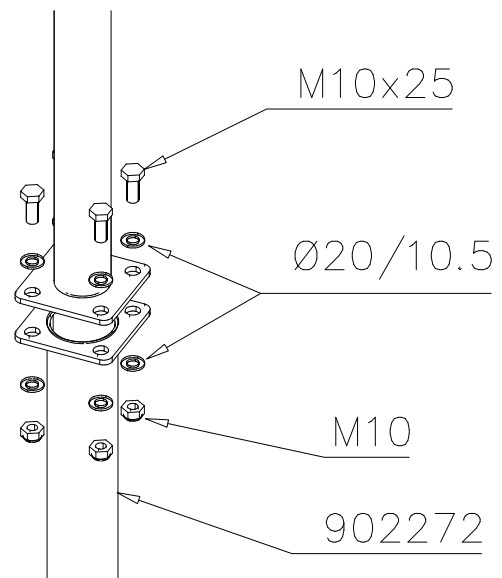

DET 1



DET 2



DET 3



DET 4



DET 5



DET 6





DET 13

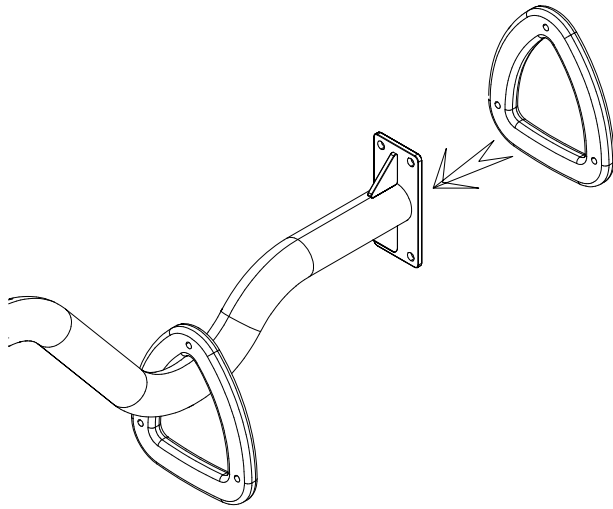

DET 14

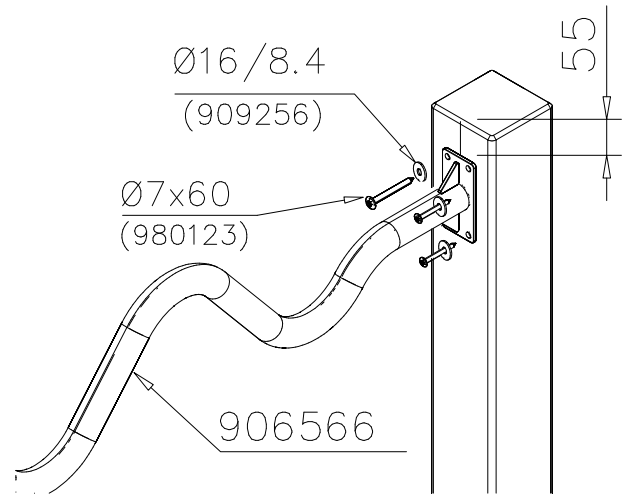

DET 15

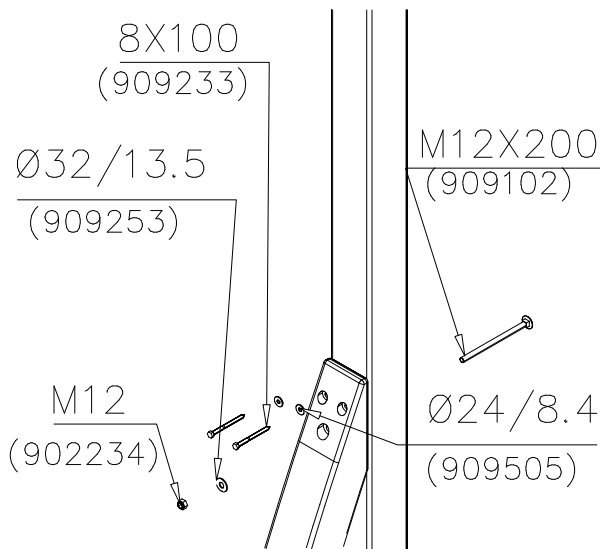

DET 16

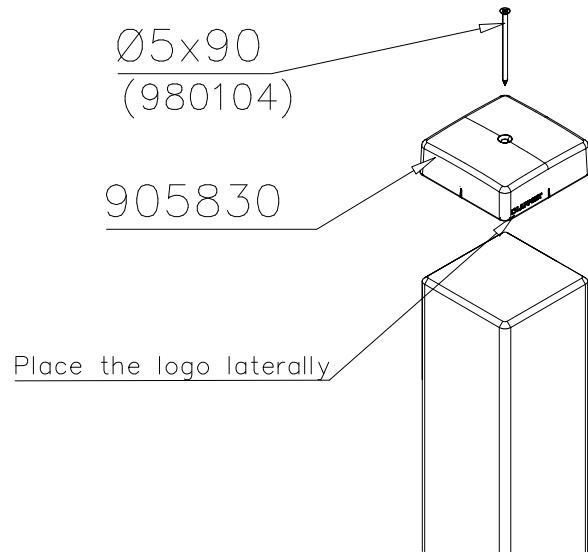

DET 17

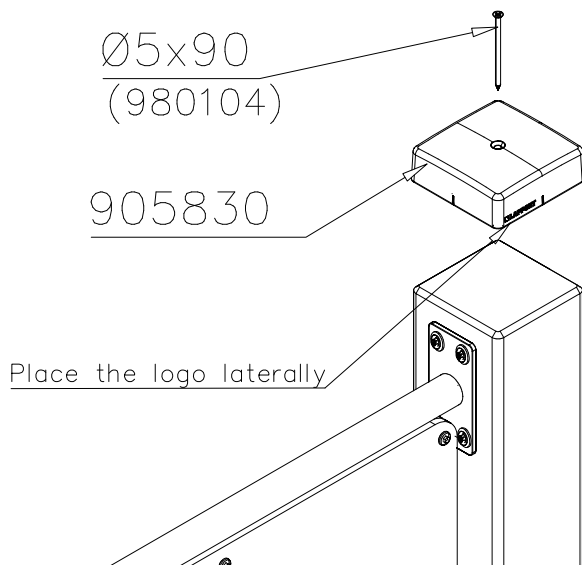

DET 18

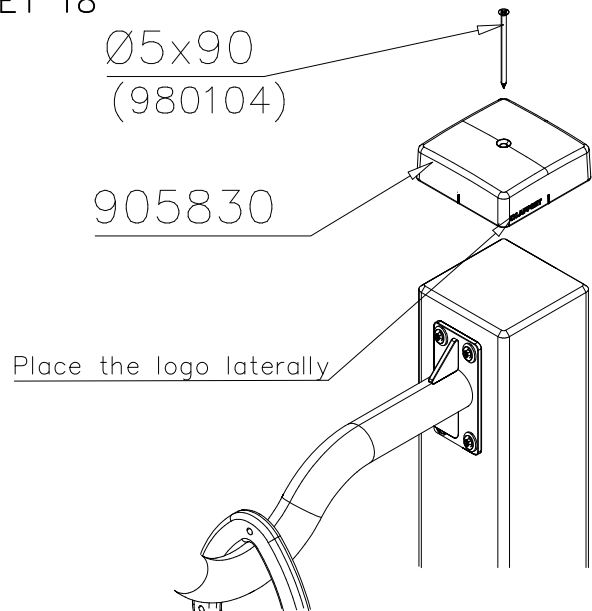

DET 19

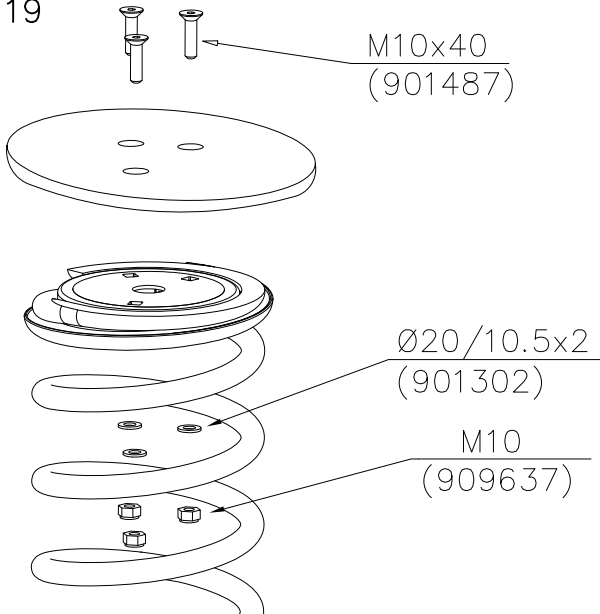

DET 20

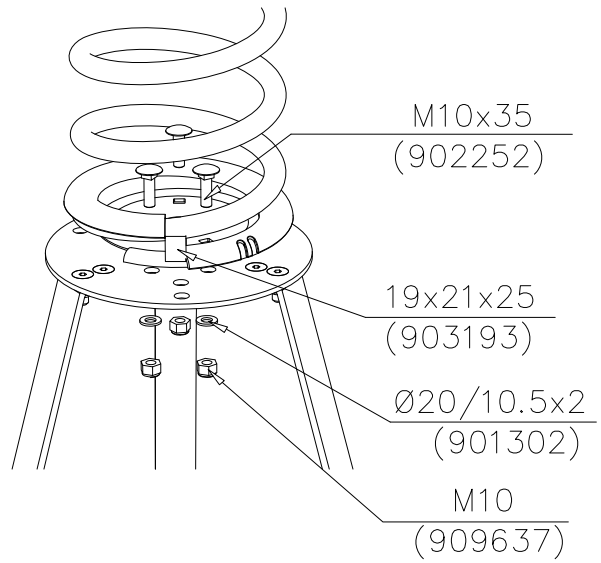

DET 21

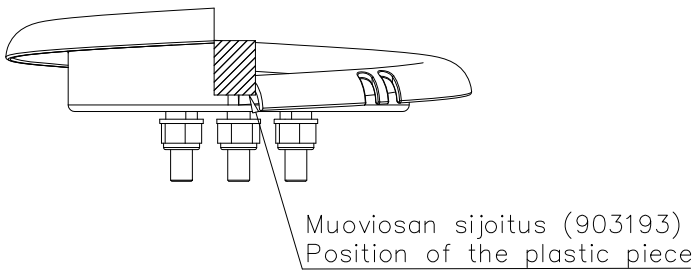

DET 22

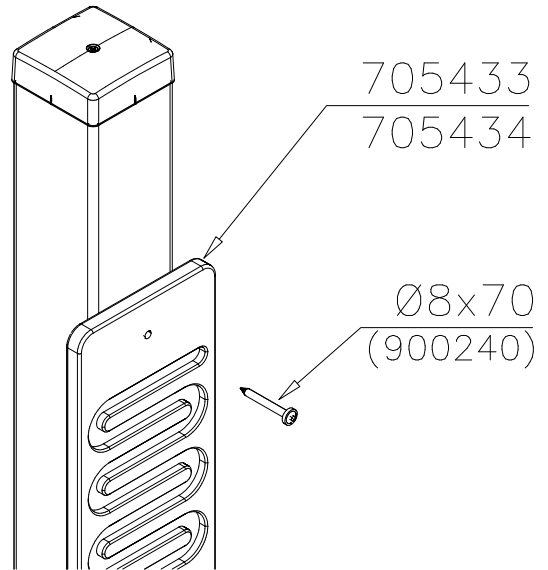

DET 23



DET 24

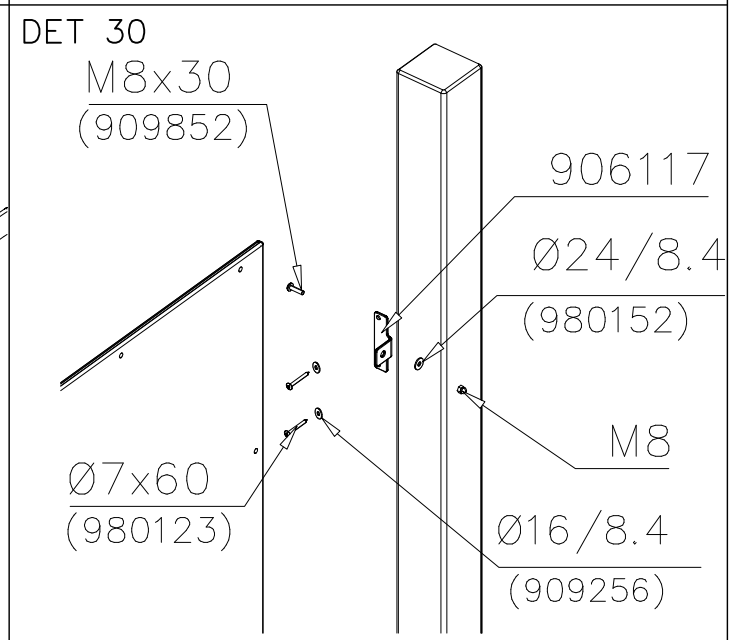
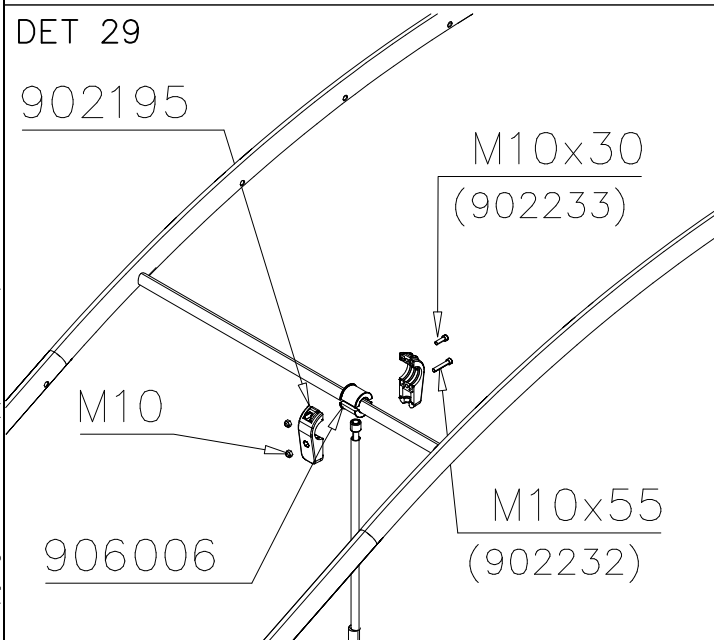
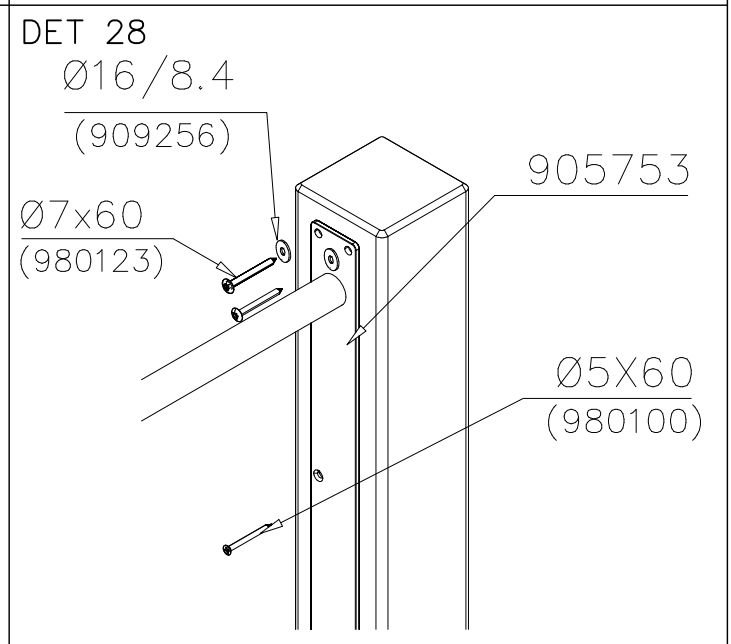
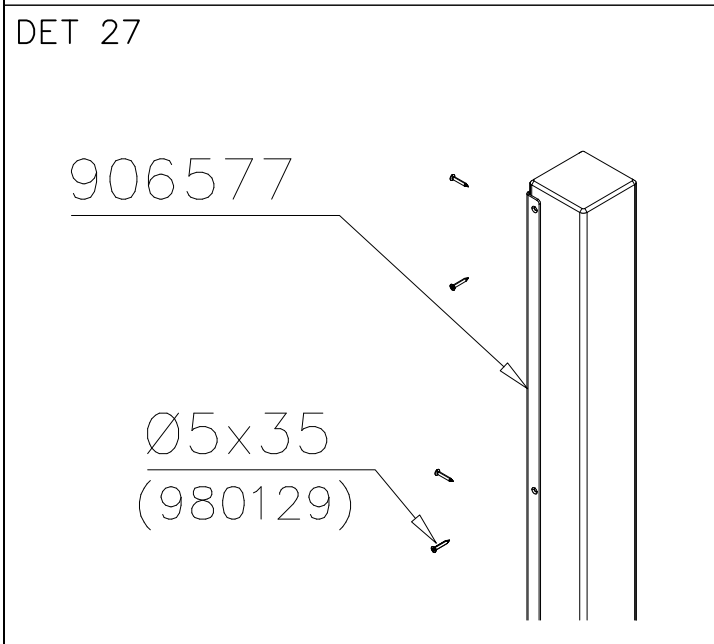
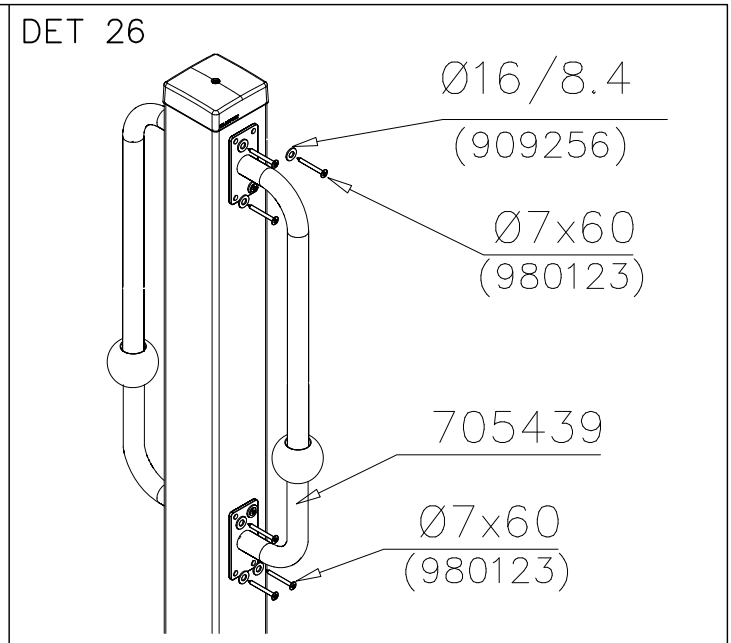
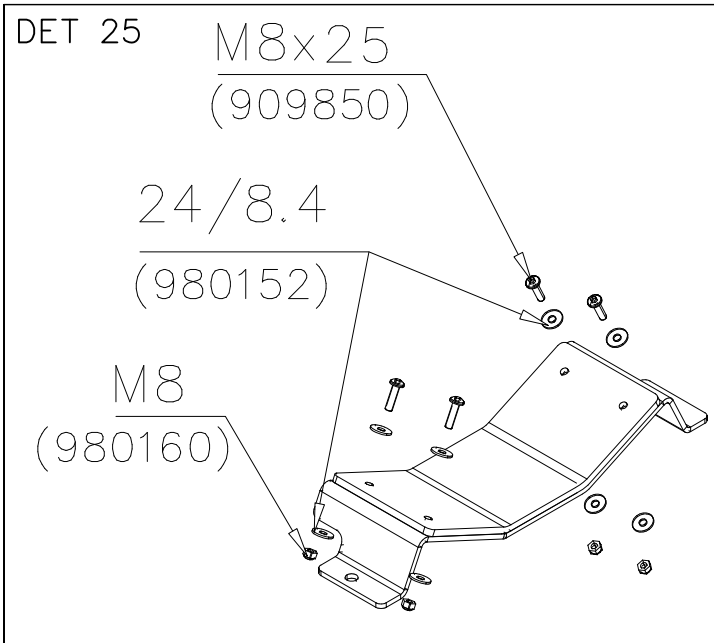

DET 31



DET 32

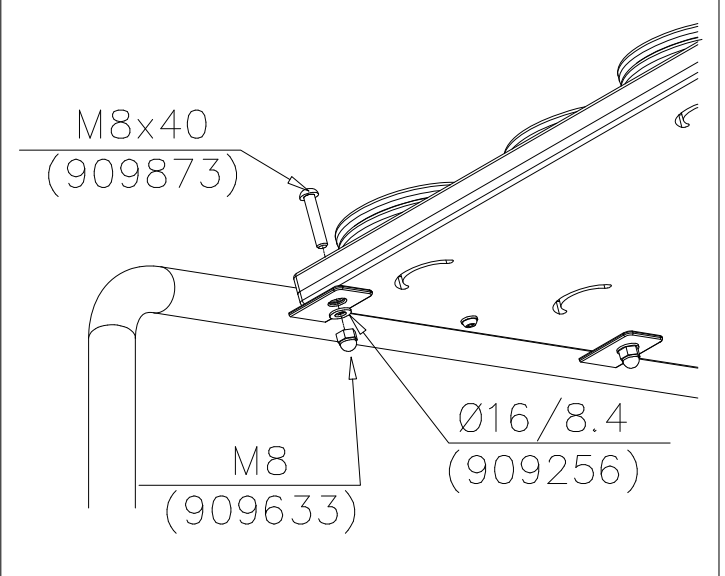

DET 33

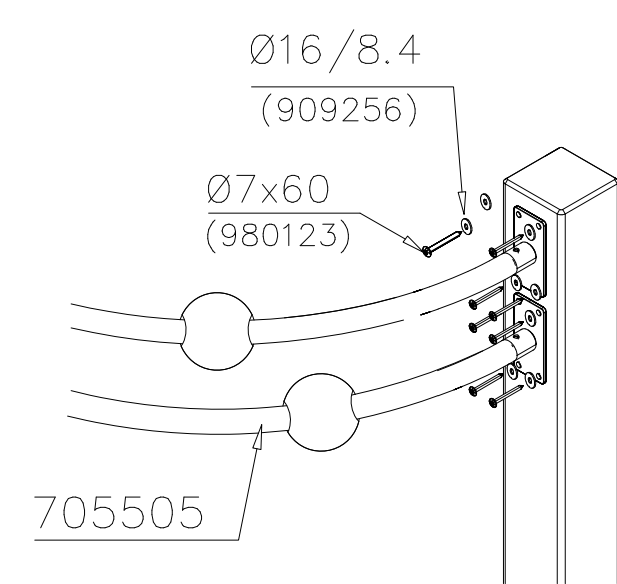

DET 34

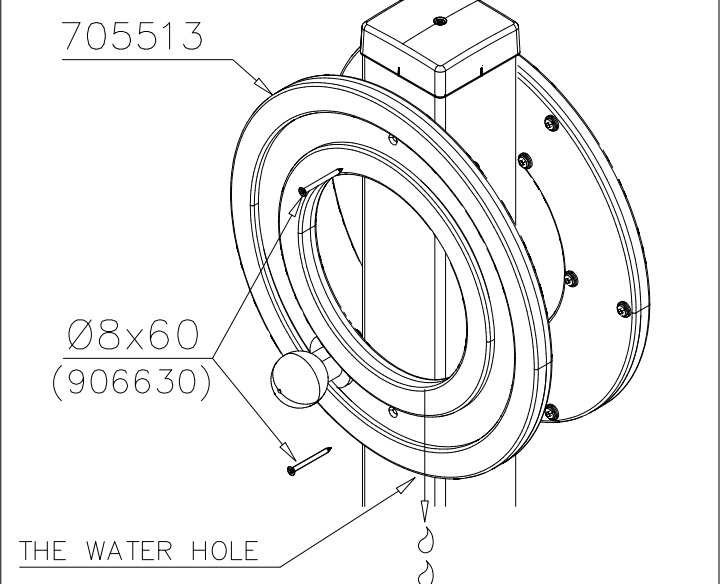

DET 35

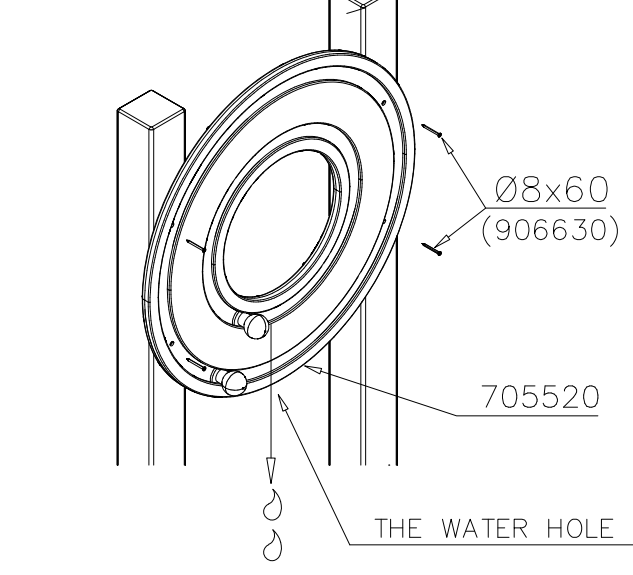

DET 36

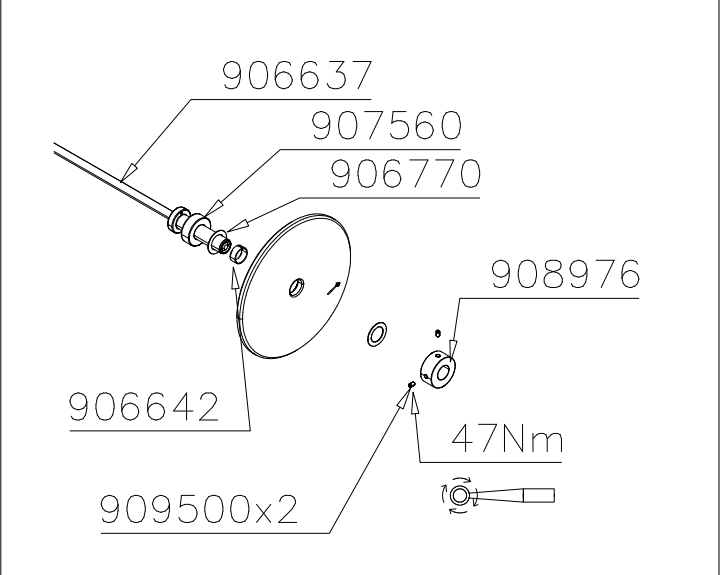

DET 37



DET 38



DET 39

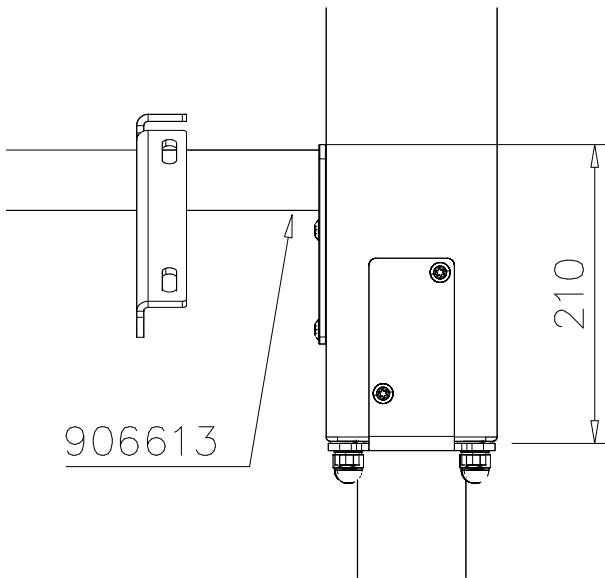

DET 40

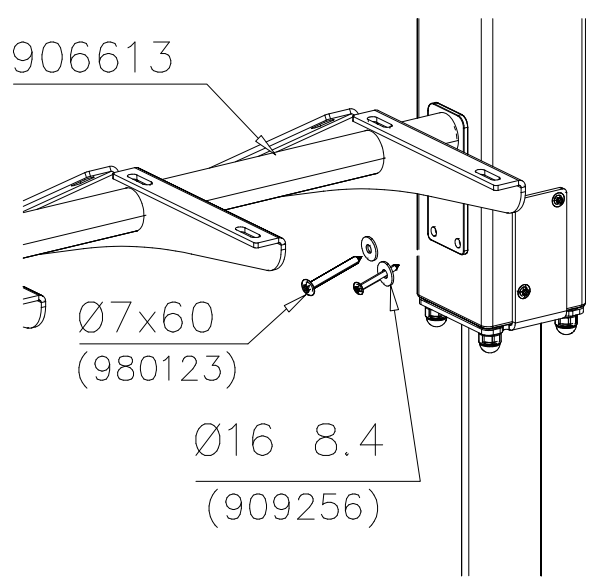

DET 41



DET 42

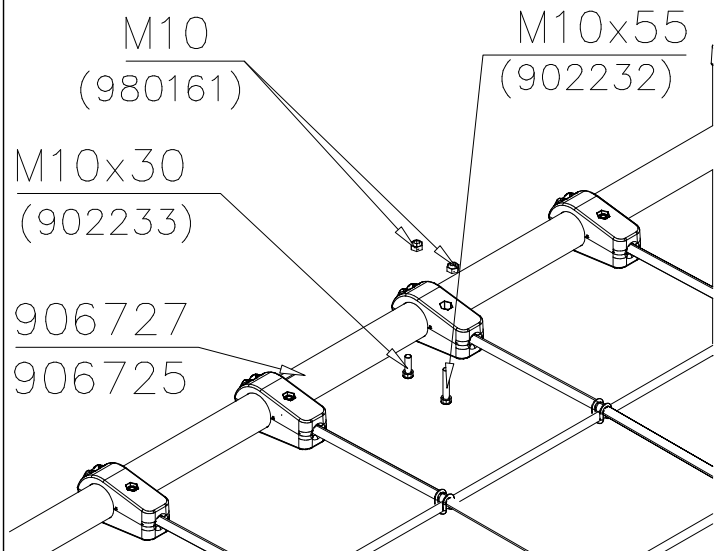

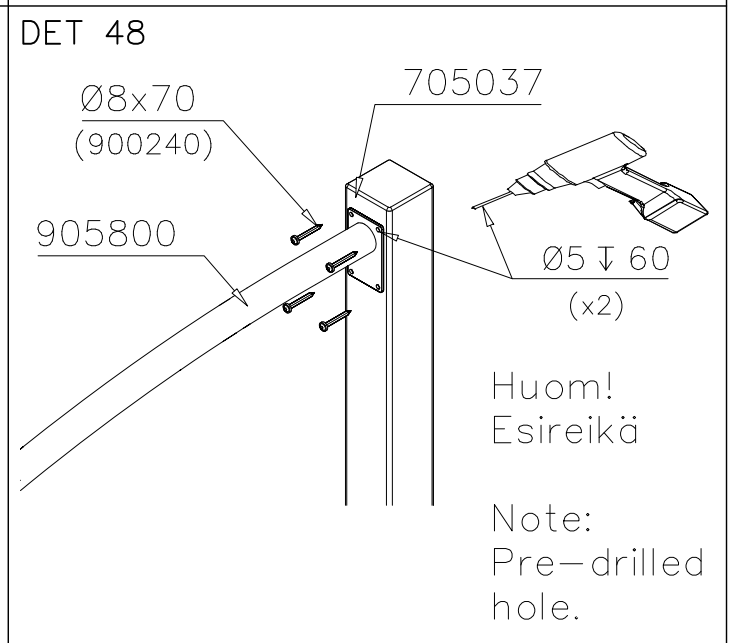
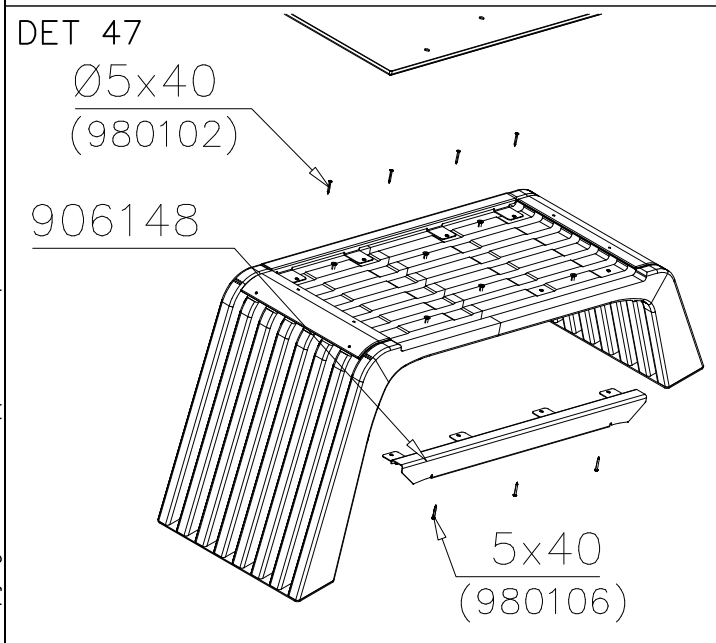

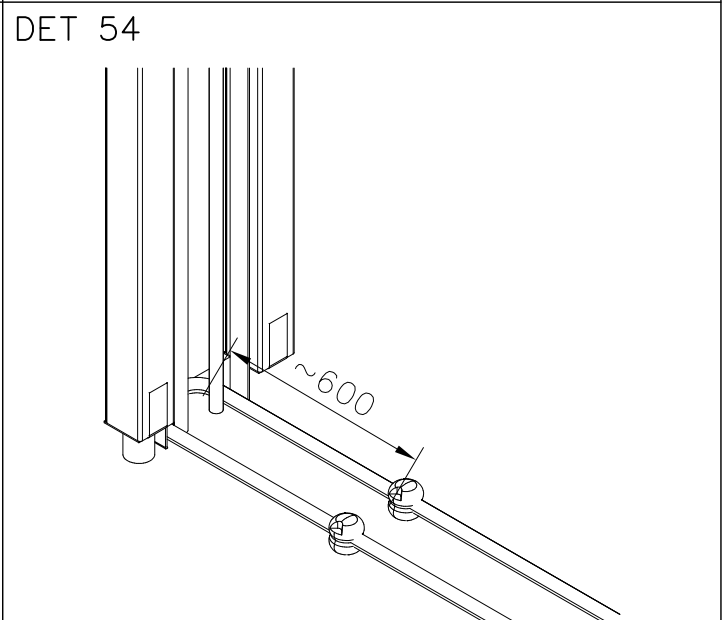
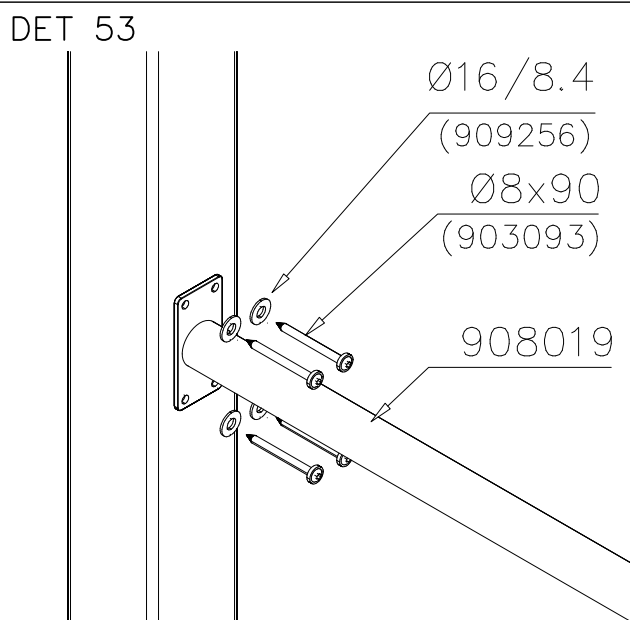
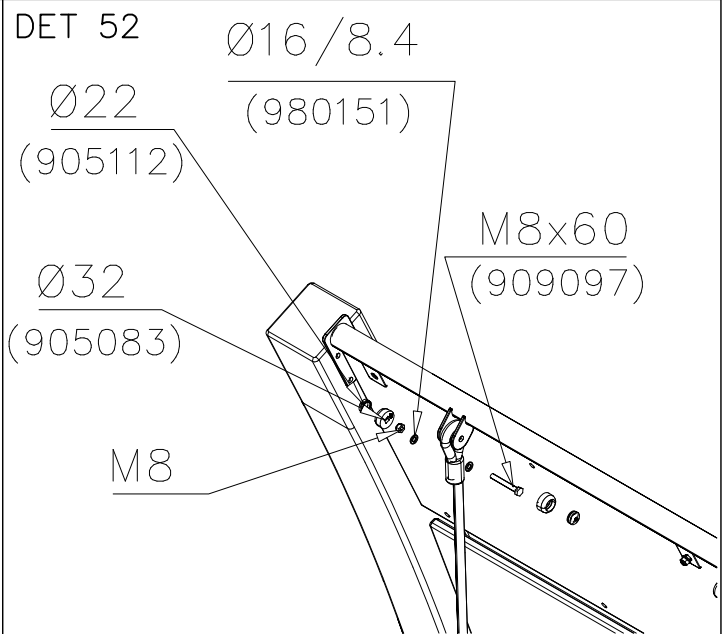
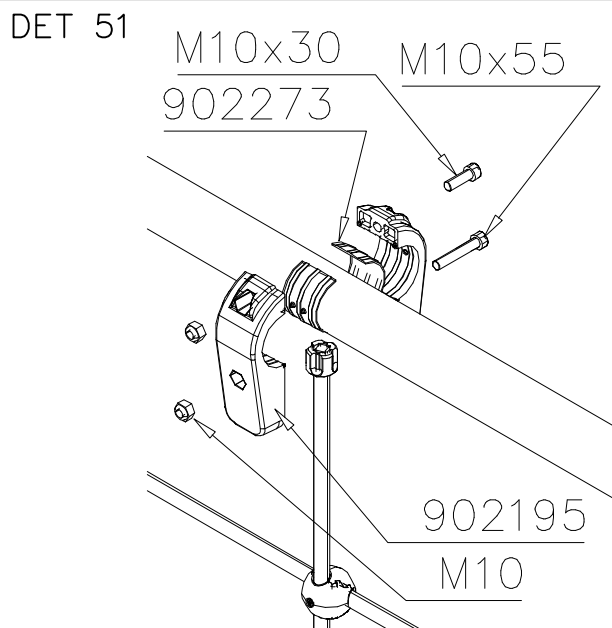
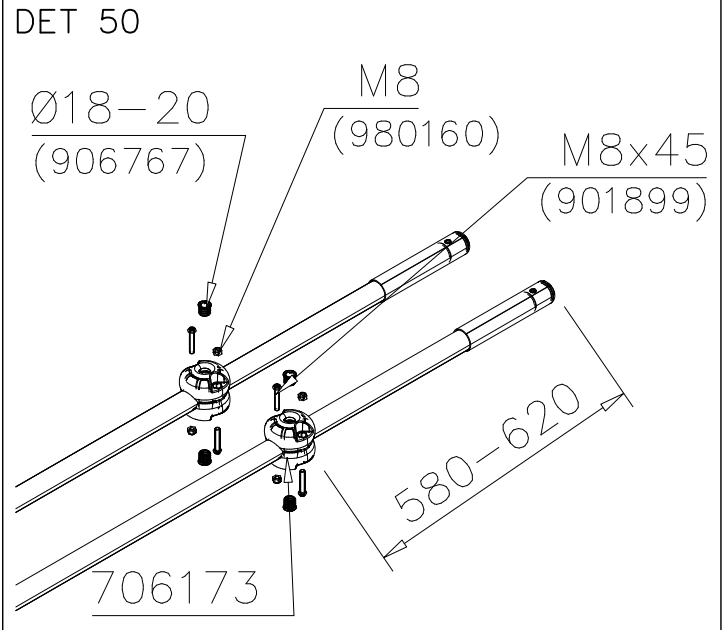
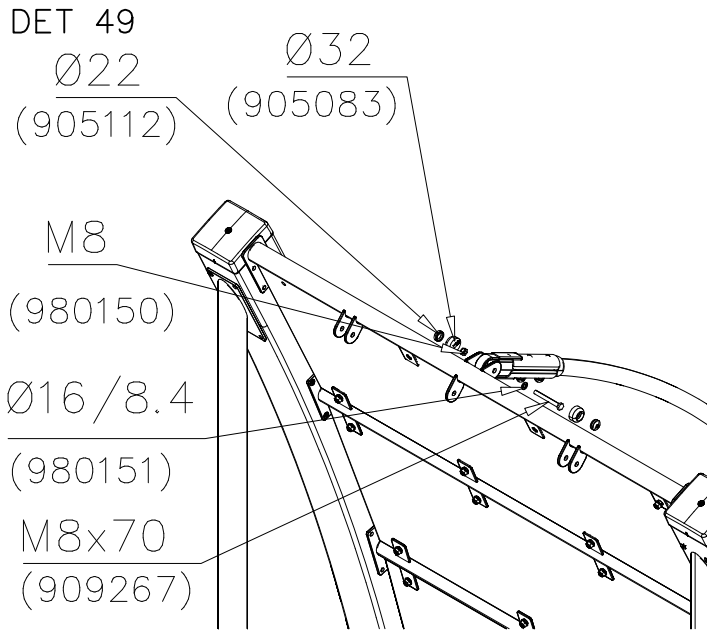

DET 55

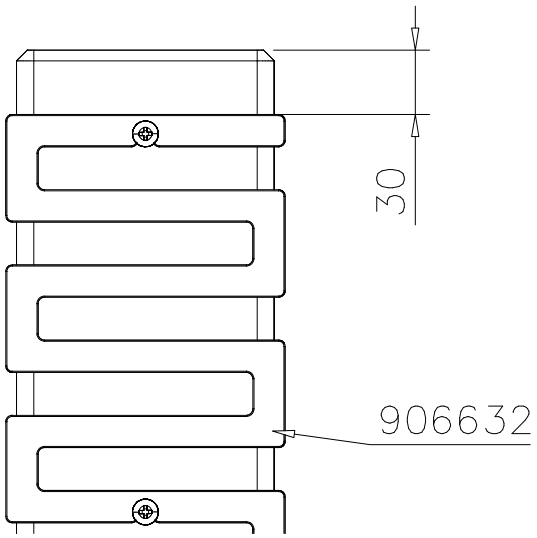

DET 56

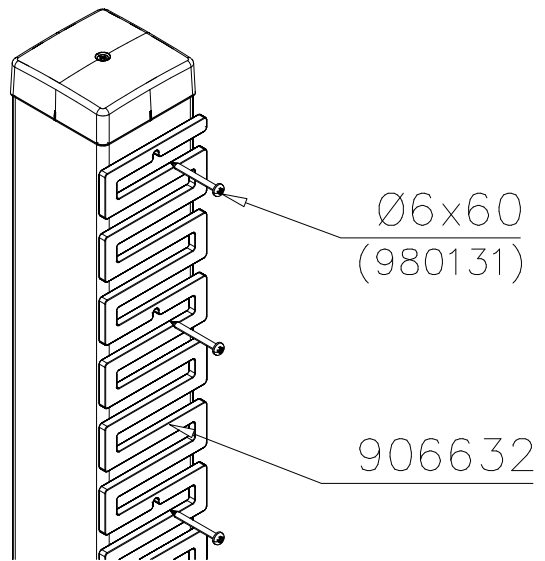

DET 57

DET 58

DET 59

DET 60

① SHEET METAL	PCS	② 980114	PCS
	1		4
118x78x0.7		Ø4x20	

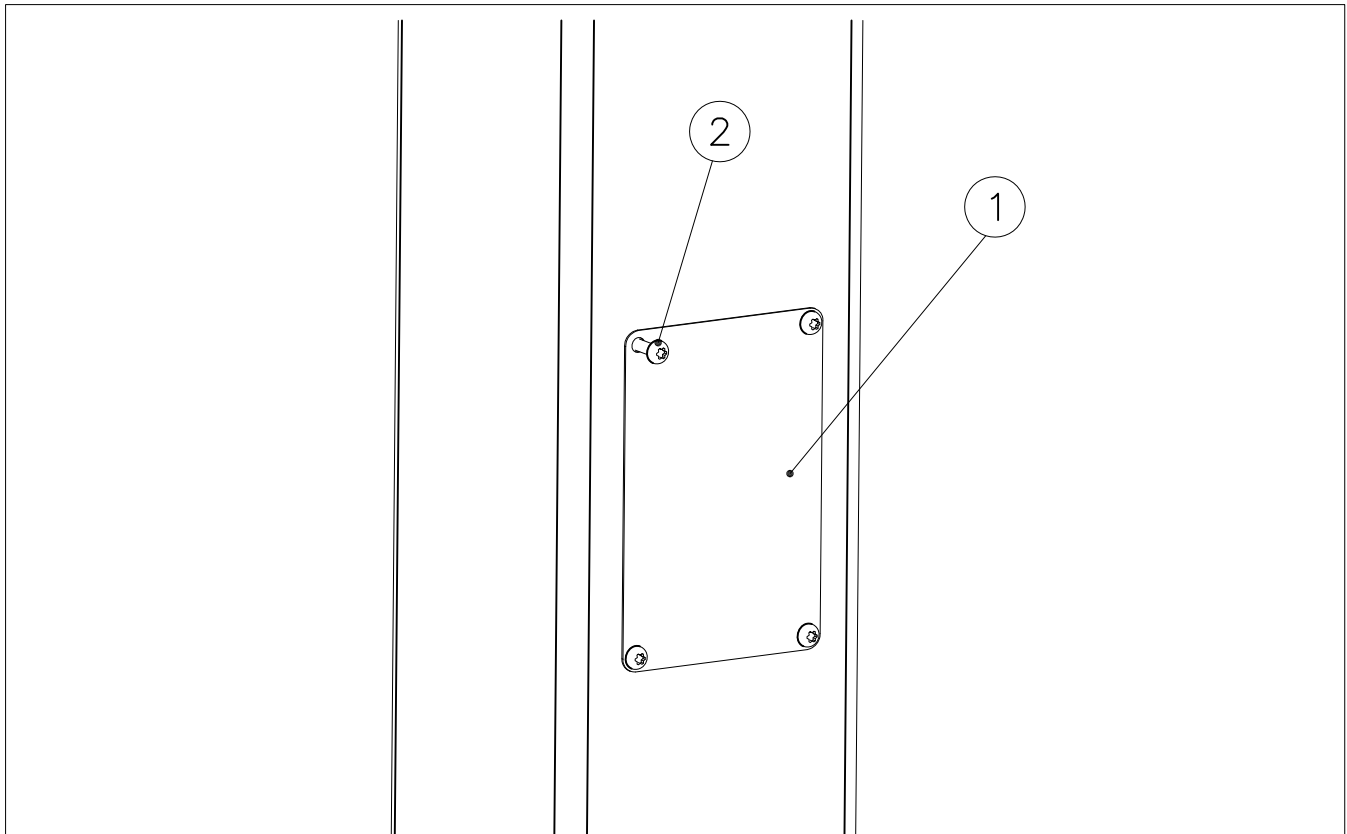

Example installation !
Esimerkki asennus !

Example installation !
Esimerkki asennus !

Example installation !
Esimerkki asennus !



Example installation !
Esimerkki asennus !

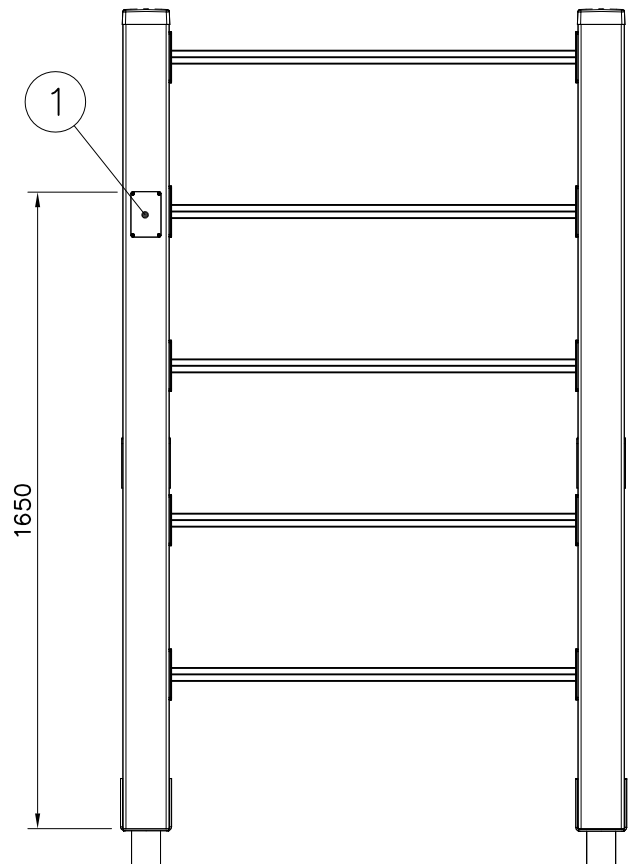

Example installation !
Esimerkki asennus !