



1021EPO



Description

Play equipment 1021EPO with 2 towers,
2x slide, wheelchair access, sand hoist,
round sandbox and several deck heights

| | |
|-----------------------|----------|
| Model type | Modulair |
| Serial number | 1021EPO |
| Equipment name | 1021EPO |

Join the action!

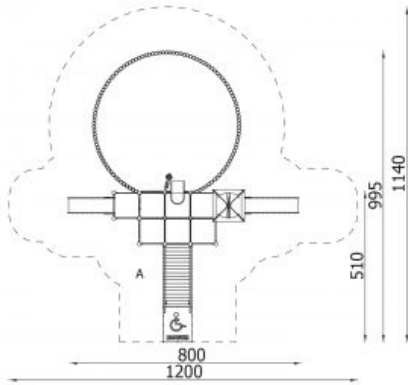

| | |
|--|---|
| Product line | Action Orbis Wood Modulair |
| Age range | 0 - 14 |
| Unit measurements | 945cm x 1010cm x 375cm |
| Required surface area | 1350cm x 475cm |
| Impact area | 50m ² |
| Free height of fall | 130cm |
| Material | Glue-laminated wood, turned cylindrically, milled. HDPE Safety Panels, Stainless steel Slide, galvanized and powder coated Metal elements |
| Heaviest part | 65kg |
| Largest part | 90cm - 400cm |
| Spare parts | Available |
| Installation time without grondwork | 15 hour(s) / 3 person(s) |
| Special tools | Included |
| Anchoring | steel, galvanized anchors + concrete blocks. Depth of installing: 60 cm |
| Remarks | no |

