

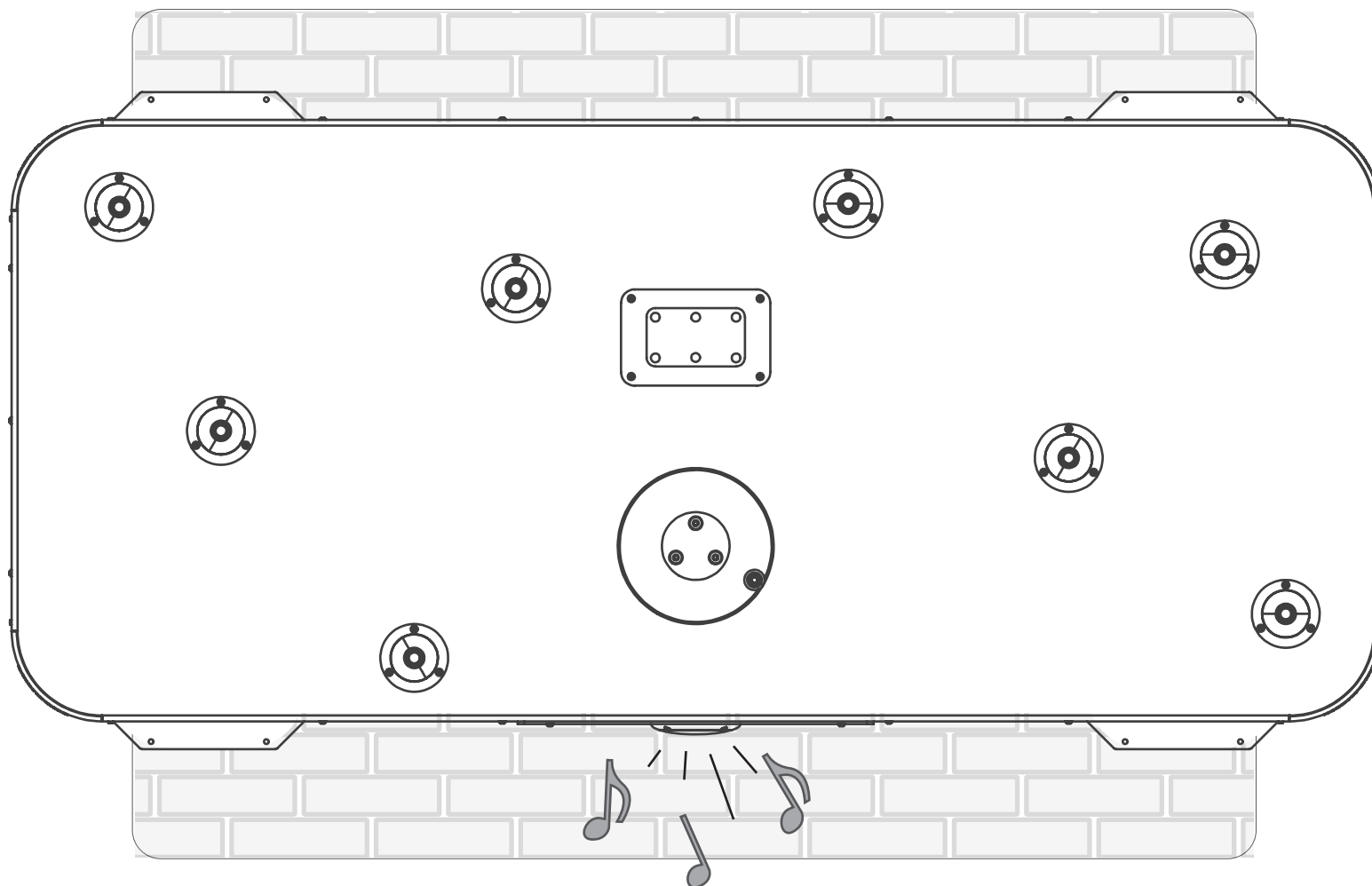

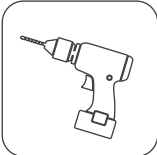

GameWall User Manual

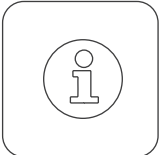

GW90010_25082020

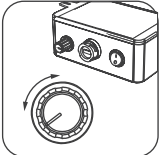
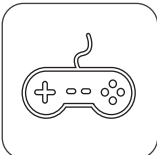
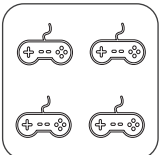
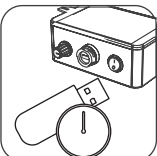

	3	Install the Product
Overview Product	3	
	3	Check Interactive Elements
Control the Volume	4	
	4	Play and Test
The 4 Games	5	
	6	Install and Manage a Timelock
Maintenance	7	



Install the Product

Install the product according to the Playnetic Installation Manual. During the installation, make sure that the potential users can not be exposed to hazards / dangerous situations. Check the stability of the product.

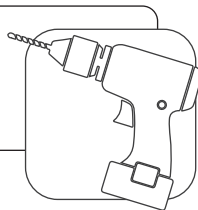
**Number of Users**

Playnetic recommends you to use the product with a maximum of four users.

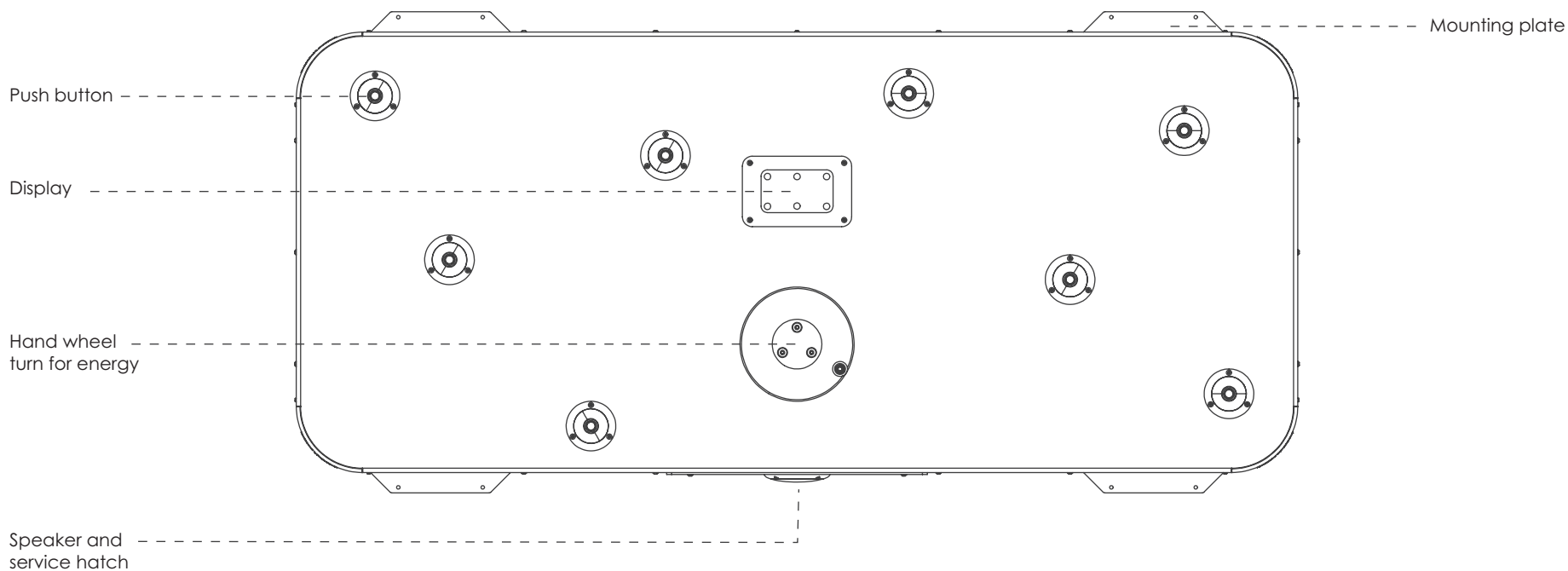
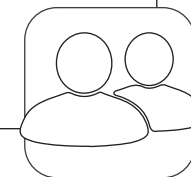
**Overview Product**

The overview above shows where all important parts can be found.

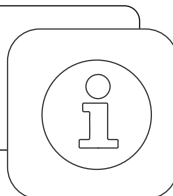
**Check Interactive Elements**

Use the product and generate energy. If applicable, check that the interactive elements such as the music, lights, smell, electronic- and mechanical parts are working properly.

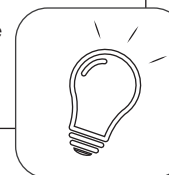

Control the Volume

1. Remove the bolts with the supplied hex key.
2. Remove the service hatch.
3. Generate energy with the product.
4. Adjust the volume.
5. Close the service hatch.

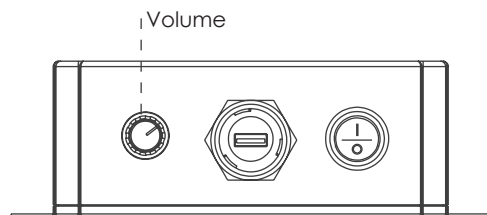
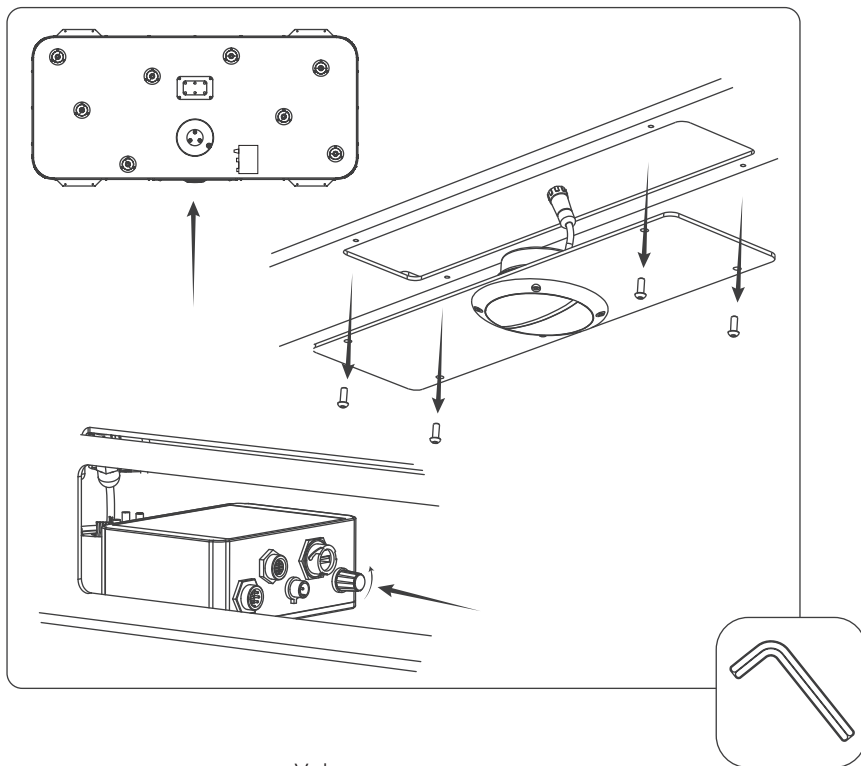
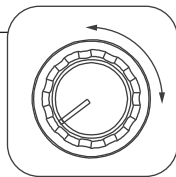

Play and Test

1. Generate energy with the product.
2. Test if the display and LED lights work.
3. Can you play all 4 games properly?

*Are the tests incorrect? Then make sure all the cables are connected properly and / or contact your local dealer.

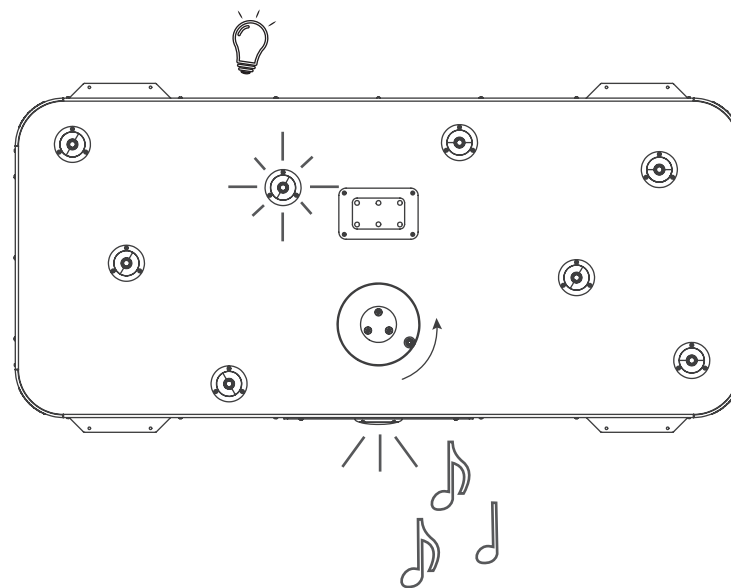
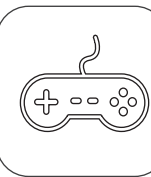

The 4 Games

1. Speedtest

Two specific lights turn on randomly, try to run them off as fast as possible. The faster you are, the higher your score is!



2. Lights Out

All of the lights turn on at the same time, it's up to you to turn them off as fast as possible.

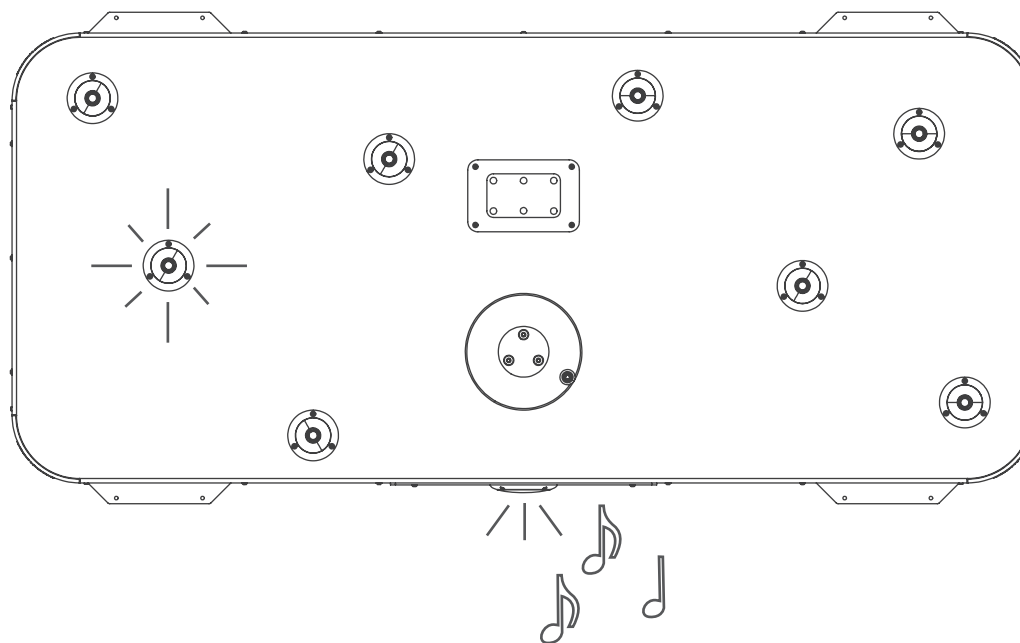

3. Reaction

One light turns on randomly on the GameWall. Pay attention to which light this is, try to turn off as many lights as possible.



4. Follow the Light

The lights turn on one after another. You have a few seconds to hit the lights. The faster you hit the light, the more points you get. If you're too slow, the light will turn off and you get 0 points!



Receive Timelock

1. Receive a USB device. Playnetic has set the correct start- and endtime for you.



Install and Manage a Timelock

1. Remove the bolts with the supplied hex key.
2. Remove the service hatch.
3. Important! The timelock must be installed at 12 o'clock local time. If the installation is being done too late or too early, the timelock will not work properly.
4. Put the USB stick into the computer.
5. Generate energy. Wait until the update is completed. Remove the USB stick after completion.
6. Make sure that you put the dust cover back over the USB port.
7. Close the service hatch.

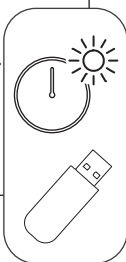

Update Your Timelock 2x a Year

For updating your timelock, use the USB device you received from Playnetic with the correct start- and endtime (same USB device for install option). Repeat step 1 till 7 in 'install a timelock' to complete the update.

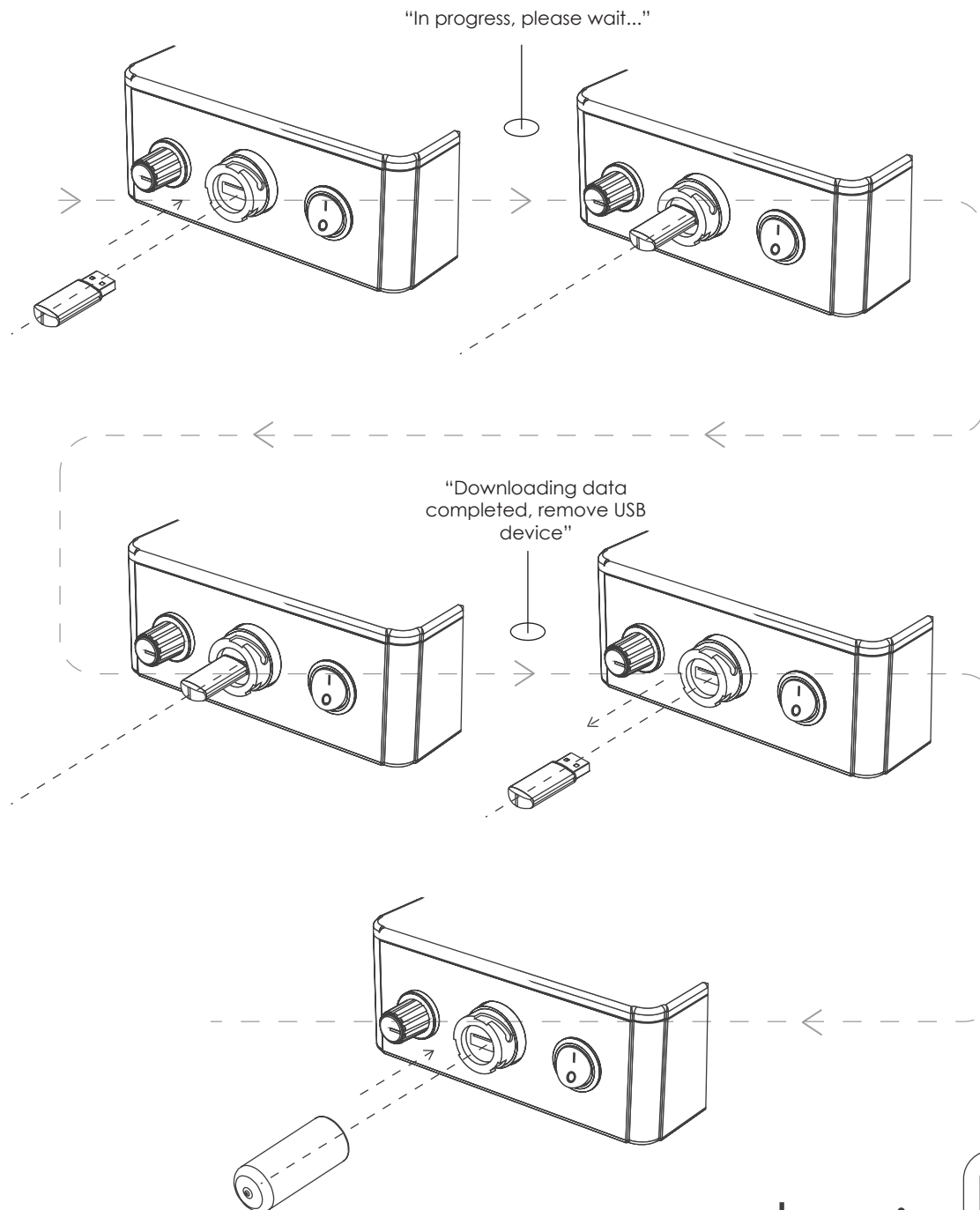
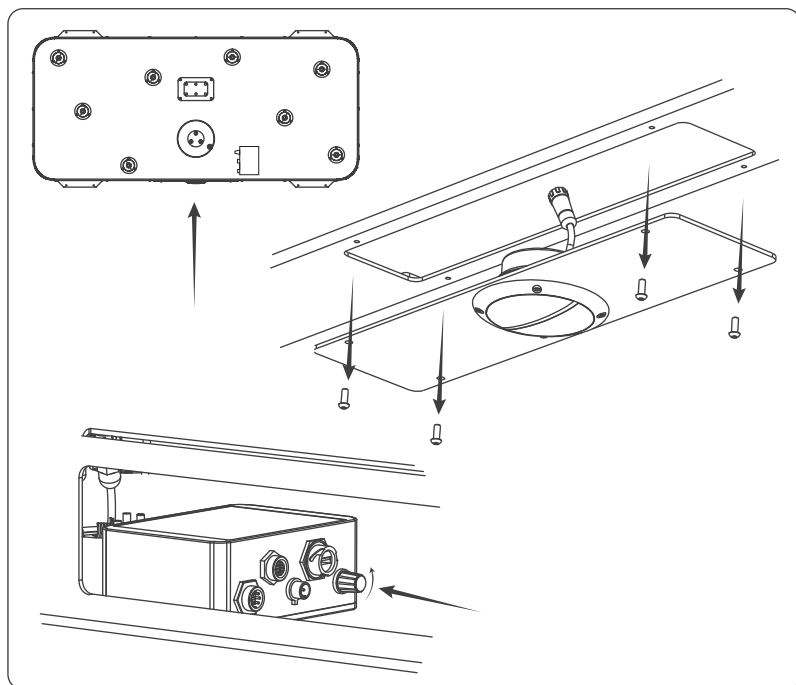

Maintenance

The product must be maintained according to the Playnetic Maintenance Advice.

