

Installation Instructions

Surface Fixed

Papilio Bells
Page 1 of 2



Instrument Components:

x4

M8 Barrel Nuts

x4
Eye Straps

x8
M6x20mm Secure Screw

x4
M8 Square Nut

x4
Metric Conversion:
250mm/ 10"
550mm/ 22"
1240mm/ 49"
1.5m/ 59"

(1.1)



1. Attach Surface Plates to base of each leg. (1.1) (See Assembly Guide)

2. Use wooden jig to mark out hole positions for each of the 3 legs in desired location upon decision from customer..

3. Fix to Surface using recommended ground anchors (Ground Anchors are not supplied)

4. Make sure all fixings are covered and secure using cover caps provided

5. Once frame fixed in place install notes using Fixings provided. Finally install beaters using fixings provided.
(See Assembly Guide)

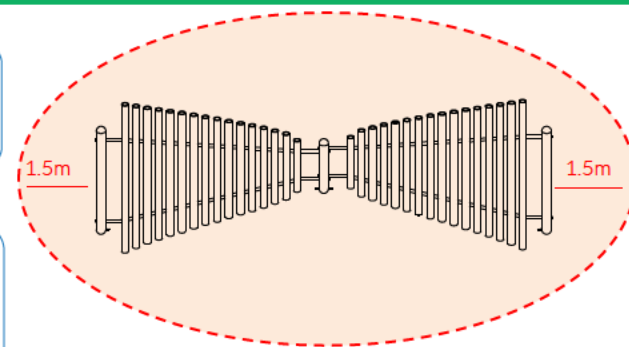

Install Instrument w th 1.5m free space (from widest point) around it.

CAUTION: Papilio surface can get hot in direct sunlight, if possible install in shaded areas.

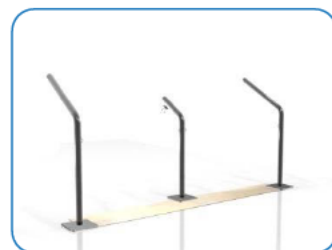
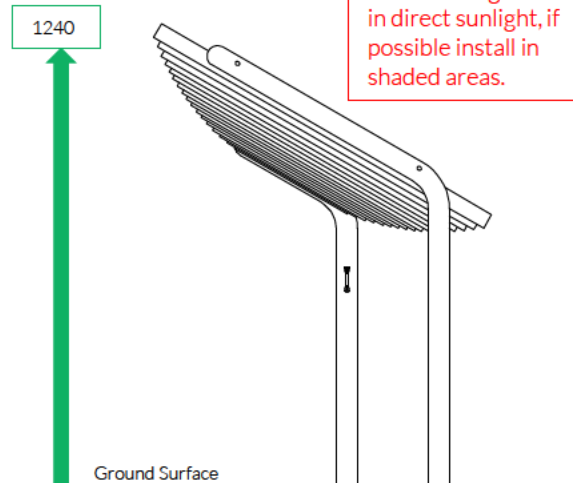

Weight of heaviest part **13kg** (Notes)



Pair Small Red Beaters X2

Surface Fix Components:

x3
M10x40 Security Screw

x3
M10 Barrel Nut

x12
2 Part Cover Cap

Ground Anchors not supplied

Spares available from percussionplay.com or from your local distributor

36 Kg

Assembly Guide PPBUTR

Surface Fixed

Papilio Bells
Page 2 of 2



Instrument Components:

-  x4
M8 Barrel Nuts
-  x4
Eye Straps
-  x8
-  x4
-  x4
-  x4

Thread Lock Solution
Required (Not Supplied)

Attach notes
to centre post
using 2 access
holes in leg

CAUTION: Papilio
Bells surface can
get hot in direct
sunlight, if possible
install in shaded
areas.

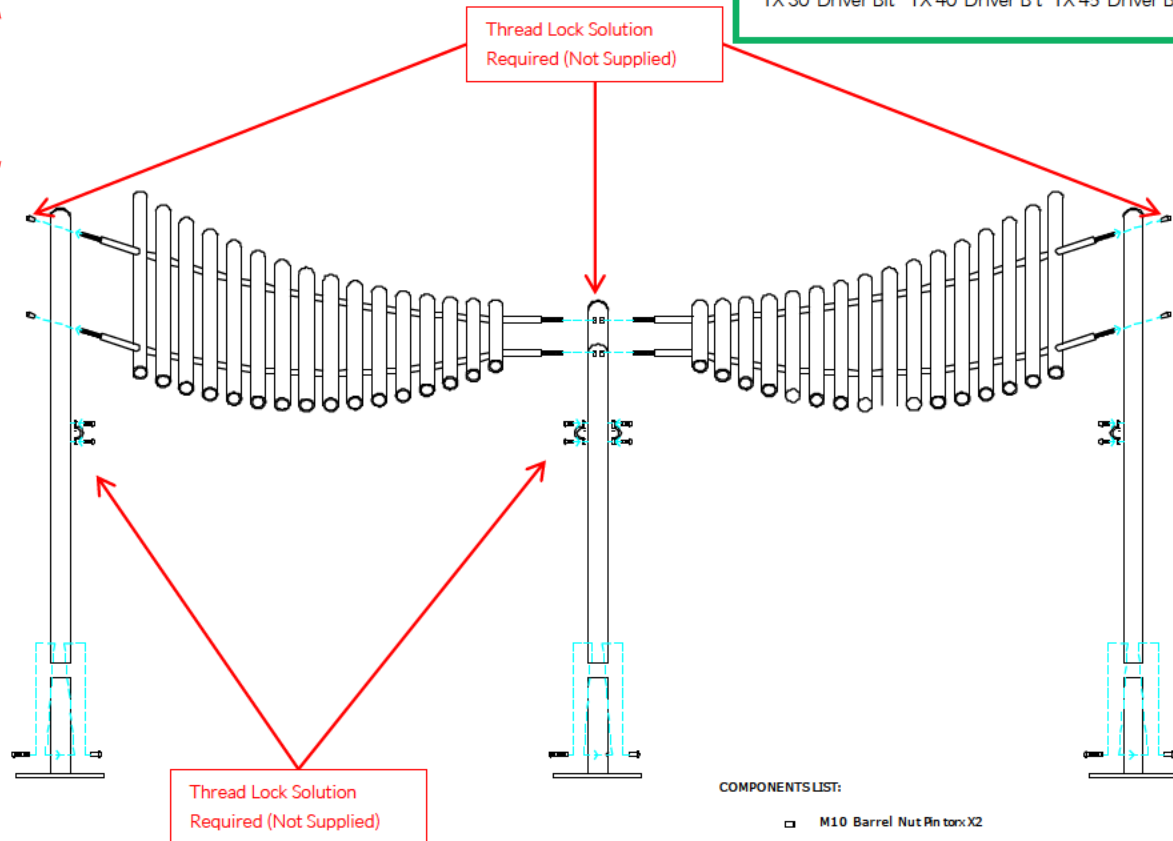
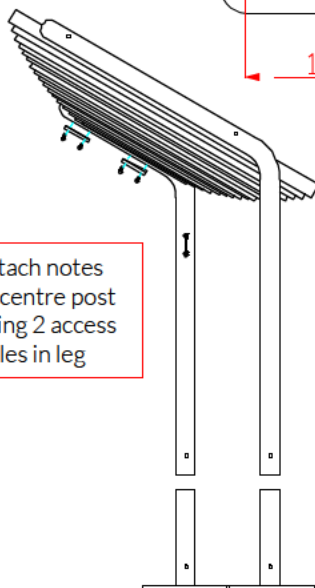
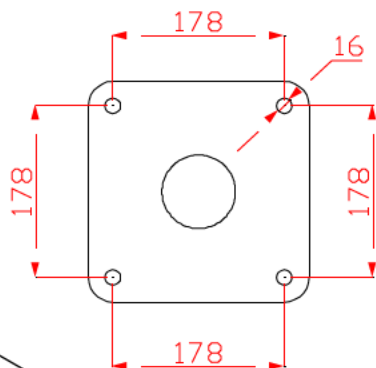



Tools:

-  x1
 -  x1
 -  x2
- TX 30 Driver Bit TX 40 Driver Bit TX 45 Driver Bit

COMPONENTS LIST:

-  x2
-  x4
-  x8
-  x4
-  x4
-  x4
-  x12
-  x3

Surface Fix Components:

-  x3
-  x3
-  x12

Ground Anchors
not supplied

Spares available from
percussionplay.com or from your
local distributor

15 Kg